

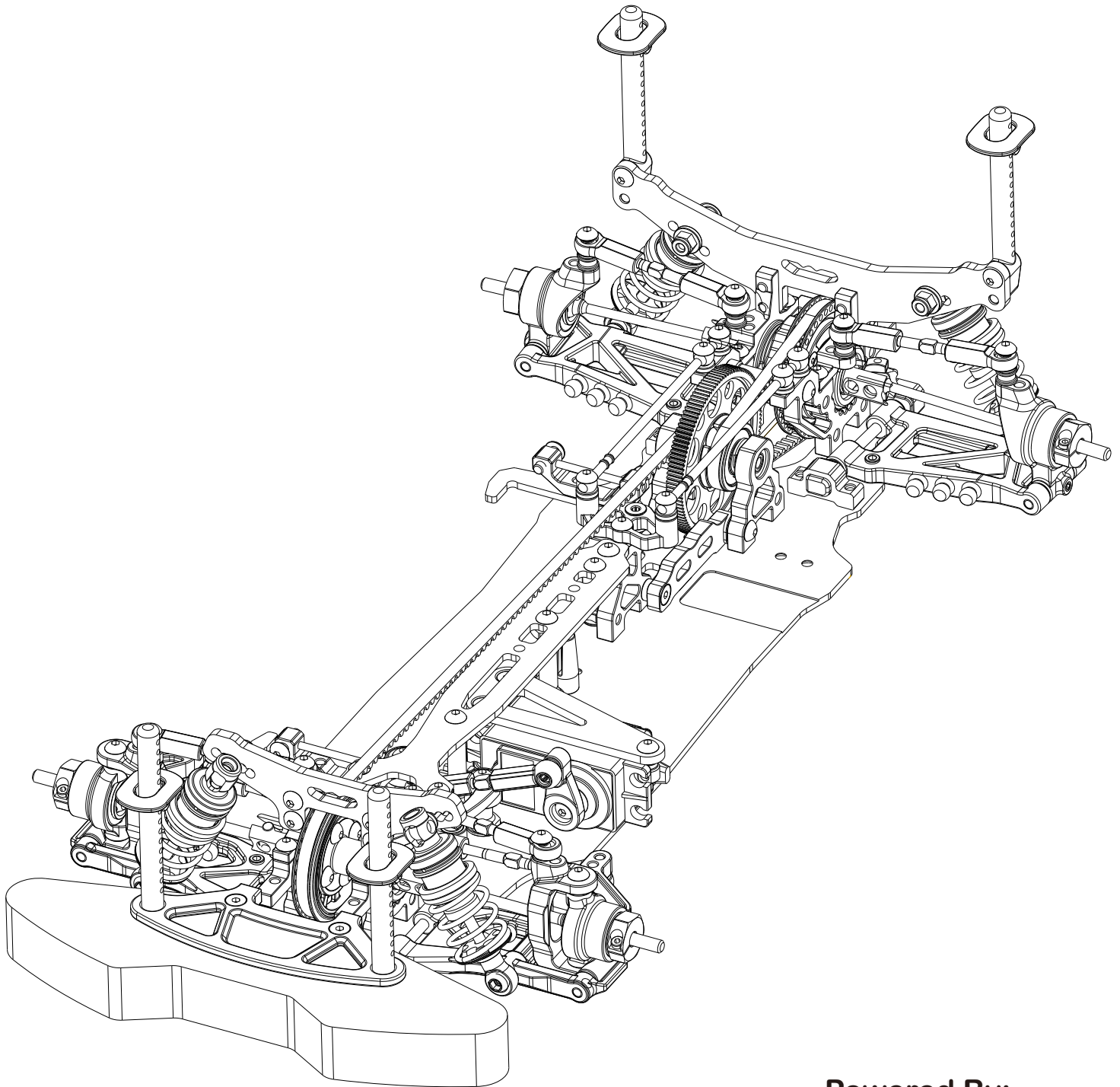

1/10 Electric Touting Car Kit

Instruction Manual



Powered By:





Introduction:

1:10 Touring Car kit is a professional 1:10th front wheel drive car and should be built by aged 14 years or over or that they had experience building and operating R/C model cars before. This is not a toy intended for use by beginners or by children without any supervision of a knowledgeable adult. Please read the instruction manual carefully before building.

Race opt should not be liable for any loss, injury or damages, whether direct, indirect, special, incidental, consequential, arising from the use, misuse, abuse of this product or accessories required to operate this product.

Warnings:

- ⦿ This product is not intended for those ages under 14 year without any adult supervision.
- ⦿ Assemble this kit only in places away from the reach of children.
- ⦿ Exercise car when using tools and sharp instrument and take care some parts that may have sharp edges when building.
- ⦿ Please do not touch any electronic equipment on the model such as motor and speed controller that having higher temperatures after the operation. Otherwise, it may burn yourself seriously by touching them. Better to allow 10~15 minutes to let any electronic equipment cool down.
- ⦿ Please complete a successful pre-run check of your radio equipment and model before the run. Make sure to keep the wheels of the model off the ground when checking the operation of the radio equipment.
- ⦿ When on the model, please always turn on the transmitter before turn on the receiver in the car. When off the model, please always turn off the receiver before turn off the transmitter. Otherwise, the model may become uncontrollable and cause serious damage.
- ⦿ Disconnect the battery pack before storing your model.
- ⦿ Do not get overcharge for the battery or leave battery unattended while charging. Never let children charge the battery without adult supervision.
- ⦿ Do not operate it on public places, roads or areas where its operation can conflict with or disrupt pedestrian or vehicular traffic.
- ⦿ Do not use your model as shown below:

In places where children and people gather	In rain, wind snow or darkness condition
In areas where loud noises can disturb others	At anytime your line of sight to the model may be obstructed or impaired in any way





Electrical Precautions:

- ⦿ Please do not allow any metal part to short circuit the battery or any electronic part using inside the car kit.
- ⦿ Never put batteries into fire.
- ⦿ Use the recommended charger for the transmitter battery and battery for electronic speed control. Please follow the charging instructions carefully. Please do not over charge the battery or choose the wrong charging mode. It becomes dangerous that causes the explosion and lead to the fire. If battery becomes extremely hot during the charging, please seek the advice from or get replacement from the corresponding battery supplier.
- ⦿ Please unplug charger when not in use.
- ⦿ When not using RC model, please always disconnect and remove the battery.
- ⦿ Low battery may result in loss of control. Please stop running the car at once when you find its speed start to slow down.
- ⦿ After use the battery, the battery remains heat and please recharges it after the battery is cool down.
- ⦿ Never use damaged wires that are dangerous and cause short circuits and may lead to the fire.

Other Equipment Needed (not included):

Radio transmitter & receiver	Battery for transmitter
Electronic speed control	Steering Servo
540 Type brushes or brushless motor	Pinion Gear (48pitch/64pitch)
190mm body shell	7.4V Nimh or Lipo Battery
Touring Car Tire set	Battery charger

Tools Needed (not included):

1.5mm, 2.0mm, 2.5mm allen wrench	5.0mm, 5.5mm, 7.0mm hex socket wrench
Modelers craft knife	Turnbuckle wrench
Calipers/Ruler	Camber gauge
Instant glue/Thread lock glue	Shock and Diff Oil
Thrust, Diff and Joint grease	Paint for body shell

Notes: All replacement parts can be found from www.race-opt.com and can be purchased from local hobby shop. If any further information needed, please email to enquiry@rc-explorer.com.



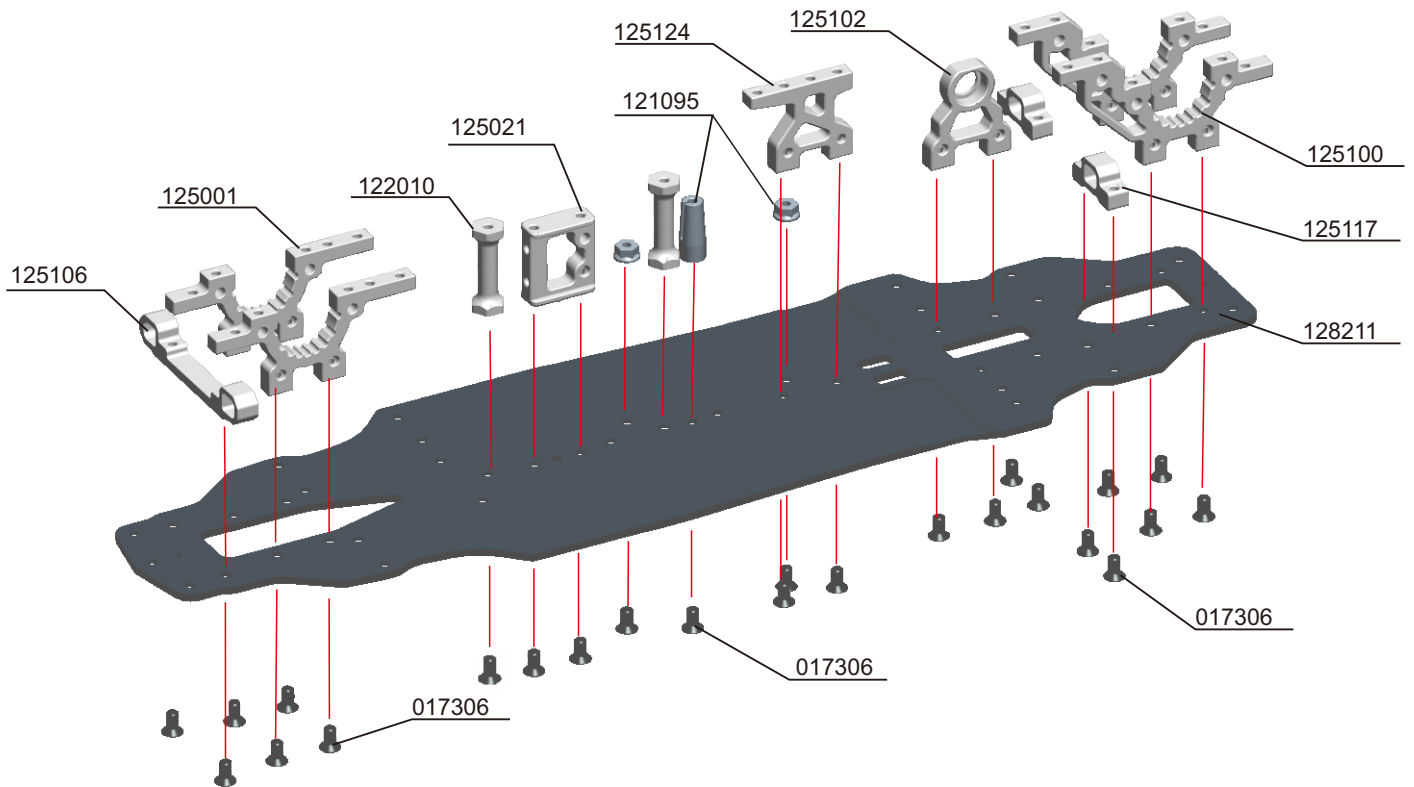

- 125100 Alu. Rear Bulkhead
- 125001 ALU LOWER SUSP. ADJUST. BULKHEAD
- 125102 Alu. Spur Gear Shaft Mount
- 125124 Alu. Chassis Center Mount
- 125106 Suspension Mount (FF)
- 125117 Suspension Mount Separated Holder (FR,RF)

- 128211 Chassis 2.2mm Graphite
- 121095 COMPOSITE SERVO MOUNT SET
- 122010 CHASIS BRACE
- 120200 OPTIONAL FLOATING SERVO MOUNT
- 017306 HEX SCREW FLAT HEAD M3x6(10)

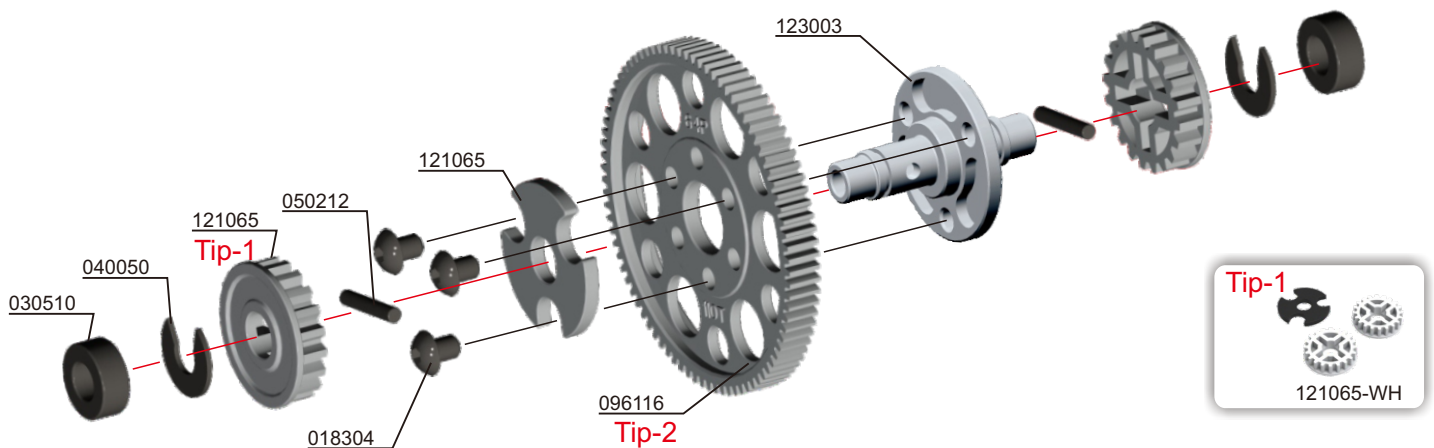

- 121065 FIXED PULLEY 20T(2)
- 123003 ALU SOLID LAYSHAFT
- 096110 SPUR GEAR 116T/64P
- 018304 HEX SCREW ROUND HEAD M3x4
- 030510 BALL-BEARING 5X10X4
- 040050 E-CLIP 5.0
- 050212 PIN 2x12

48P	
094084	SPUR GEAR 84T/48P
094084-WH	SPUR GEAR 84T/48P
094087	SPUR GEAR 84T/48P
094087-WH	SPUR GEAR 87T/48P

64P	
096110	SPUR GEAR 110T/64P
096110-WH	SPUR GEAR 116T/64P
096116	SPUR GEAR 110T/64P
096116-WH	SPUR GEAR 116T/64P

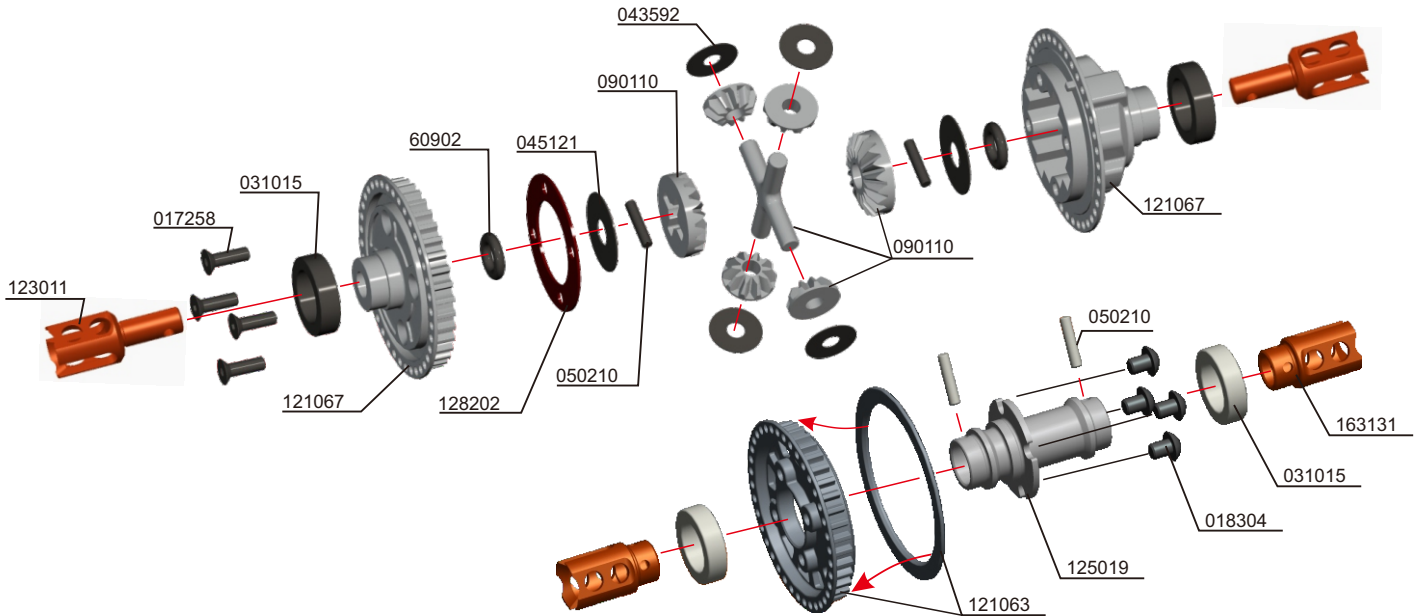

- 090110 PLANETARY GEAR SET-PLASTIC
- 121063 TIMING BELT PULLEY 38T
- 121067 COMPOSITE GEAR DIFF. CASE & COVER
- 125019 FRONT SOLID AXLE
- 123011 UNIVERSAL CVD DRIVE SHAFT - SPRING STEEL 3.6 S2
- 163131 FRONT SOLID AXLE SPOOL OUTDRIVE-SPRING STEEL 3.1 S2
- 128202 DIFF. GASKET

- 017258 HEX SCREW FLAT HEAD M2.5x8
- 018304 HEX SCREW ROUND HEAD M3x4
- 043592 WASHER S 3.5x9x0.2
- 045121 WASHER S 5x12x0.1
- 050210 PIN 2x9.8
- 060902 SILICONE O-RING 9x2
- 031015 BALL-BEARING 10X15X4

TIPS FOR DIFFERENTIALS

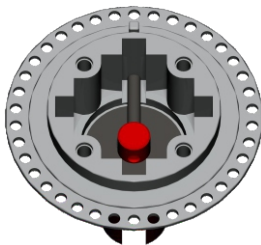

Low-Traction
500 c/t

High-Traction
1000 c/t

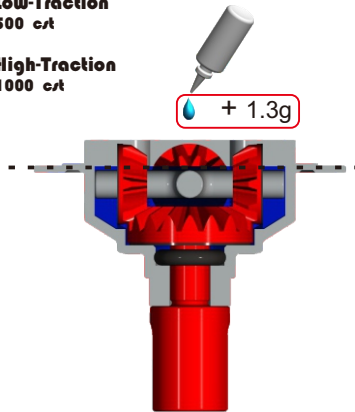

Add 1.3g of oil the diff.

! LOCATION

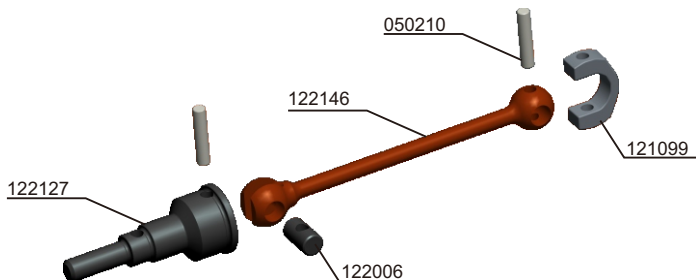
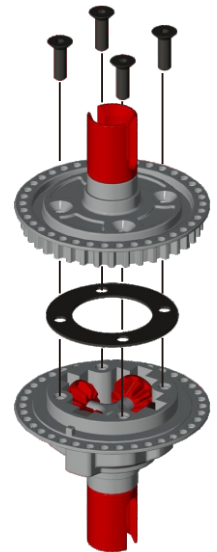
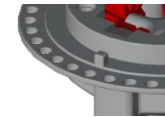

- 122006 CVD JOINT PIECE
- 122127 CVD AXLE SHAFT-SLANTING
- 122146 UNIVERSAL CVD DRIVE SHAFT-SPRING STEEL 46MM 2.0PIN-S2
- 121099 DRIVE SHAFT REPLACEMENT PLASTIC CAP
- 162147 UNIVERSAL CVD DRIVE SHAFT-SPRING STEEL 47MM 3.0PIN-S2

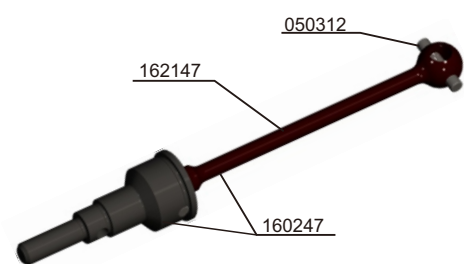

- 050210 PIN 2x9.8
- 050312 PIN 3x12
- 122127 CVD AXLE SHAFT-STRAIGHT
- 160247 CVD DRIVE SHAFT SPRING STEEL-47mm 3.0PIN

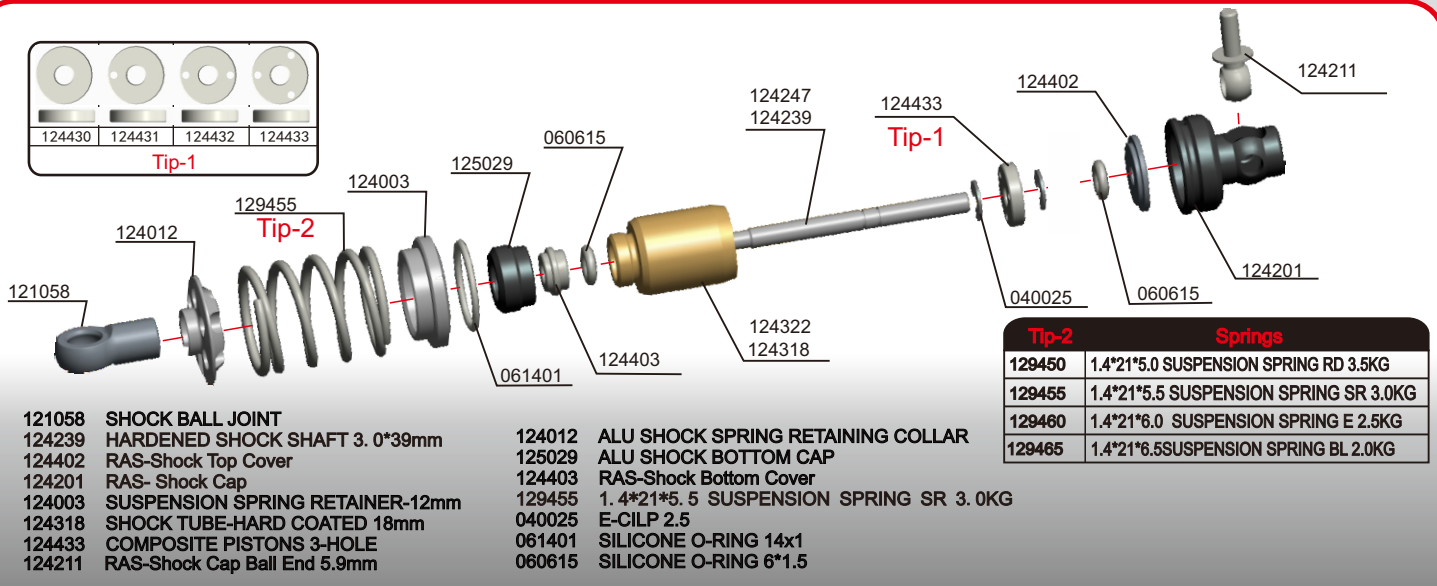

TIPS FOR SHOCK ABSORBER

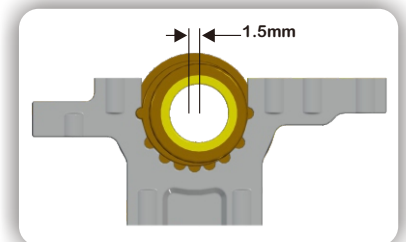
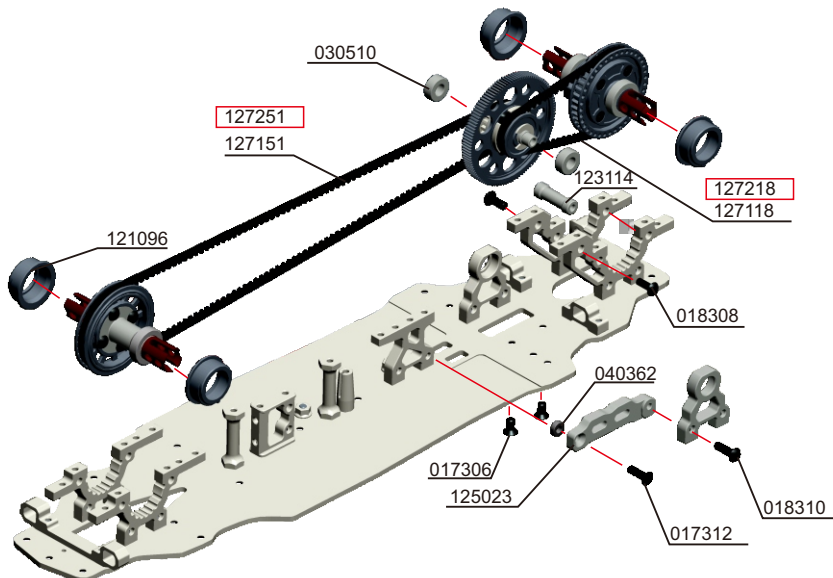

- | | | |
|----------------------------------------------|-----------------------------|-----------------------------------|
| 123114 Bulkhead Mount Post | 125023 OPTIONAL MOTOR MOUNT | 018308 HEX SCREW ROUND HEAD M3x08 |
| 121096 COMPOSITE ADJUSTMENT BALL-BEARING HUB | 030510 BALL-BEARING 5x10x4 | 017306 HEX SCREW FLAT HEAD M3x6 |
| 127118 SYNCHRONOUS BELT SHORT-189 63T | 040362 ALU WASHER 3x6x2 | 017312 HEX SCREW FLAT HEAD M3x12 |
| 127151 SYNCHRONOUS BELT LENGTH-513 171T | | 018310 HEX SCREW ROUND HEAD M3x10 |

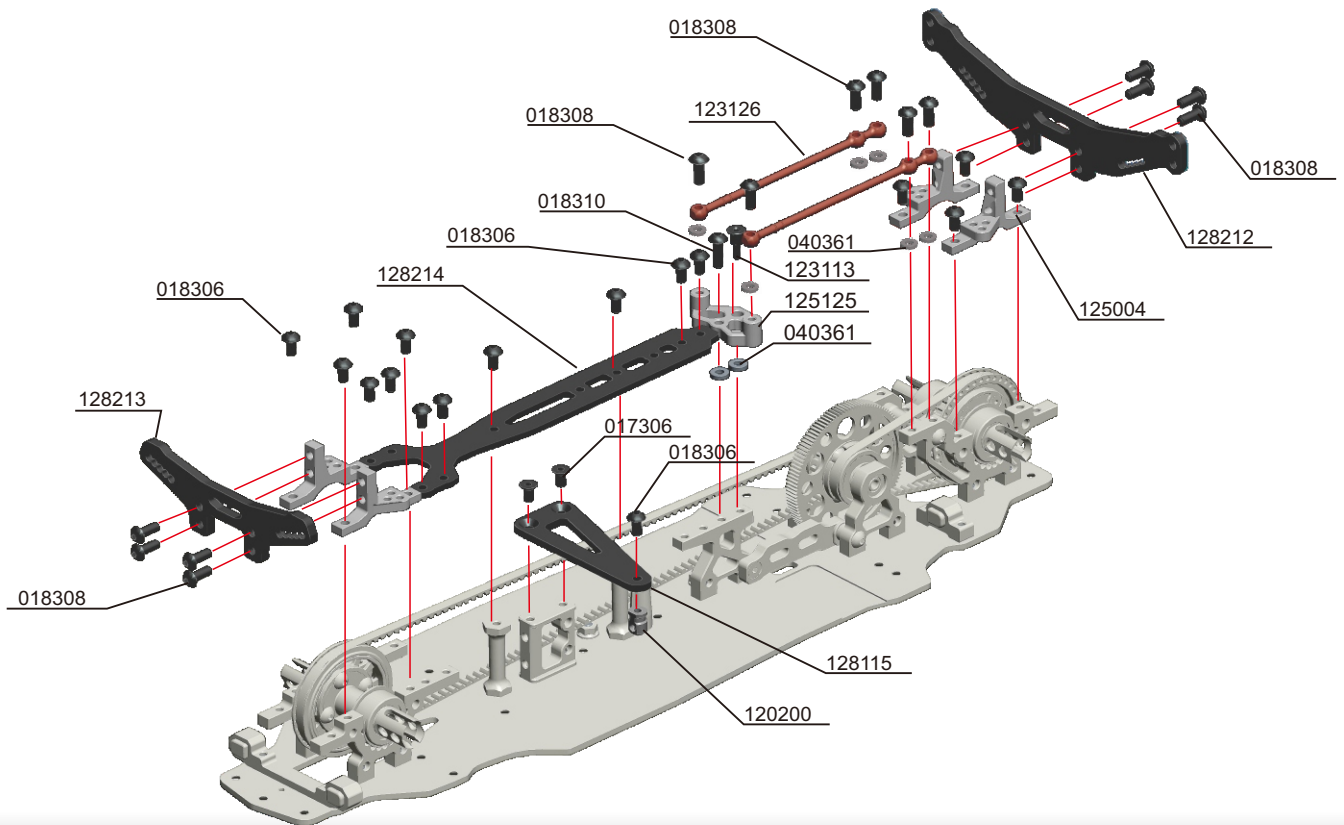

125004 BEARING SLEEVE CLAMP -GT CAR(L+R)
128212 Shock Tower (Rear) 3.0mm Graphite
128213 Shock Tower (Front) 3.0mm Graphite
128214 UPPER DECK GRAPHITE
128115 GRAPHITE FLOATING SERVO MOUNT Plate
120200 OPTIONAL FLOATING SERVO MOUNT

040361	ALU WASHER 3x6x1
123114	Twist Bar Holder Post
123126	Anti-Twist Bar 2.6mm
125125	Anti-Twist Bar Holder
018306	HEX SCREW ROUND HEAD M3x6
018308	HEX SCREW ROUND HEAD M3x8
018310	HEX SCREW ROUND HEAD M3x10
017306	HEX SCREW FLAT HEAD M3x6

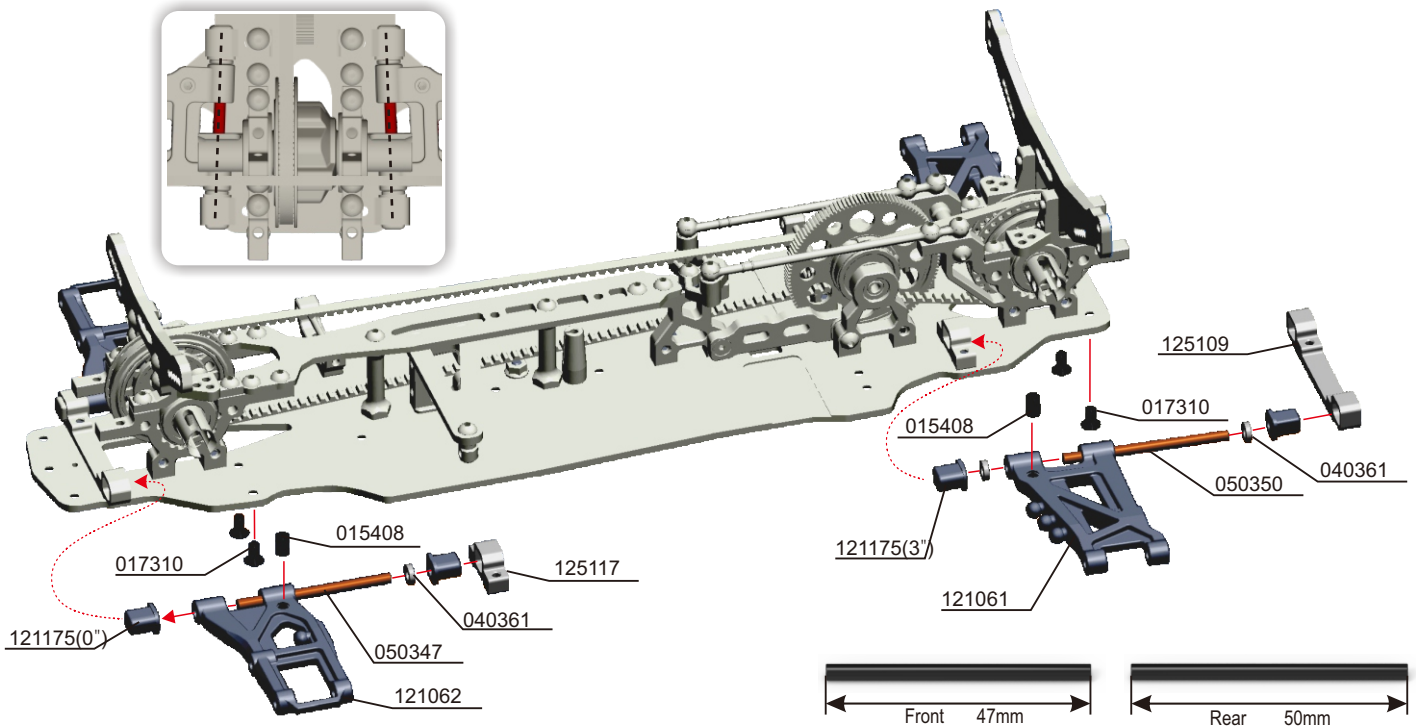

050347	FRONT ARM PIVOT PIN 3*47(2)
050350	REAR ARM PIVOT PIN 3*50(2)
121061	REAR SUSPENSION ARM
121062	FRONT SUSPENSION ARM
121175	Suspension Mount Insert 0°
121175	Suspension Mount Insert 3°

040361	ALU WASHER 3x6x1
125117	Suspension Mount Separated Holder (FR,RF)
125109	Suspension Mount Holder (RR)
015408	HEX SET SCREW M4x8
017310	HEX SCREW FLAT HEAD M3x10

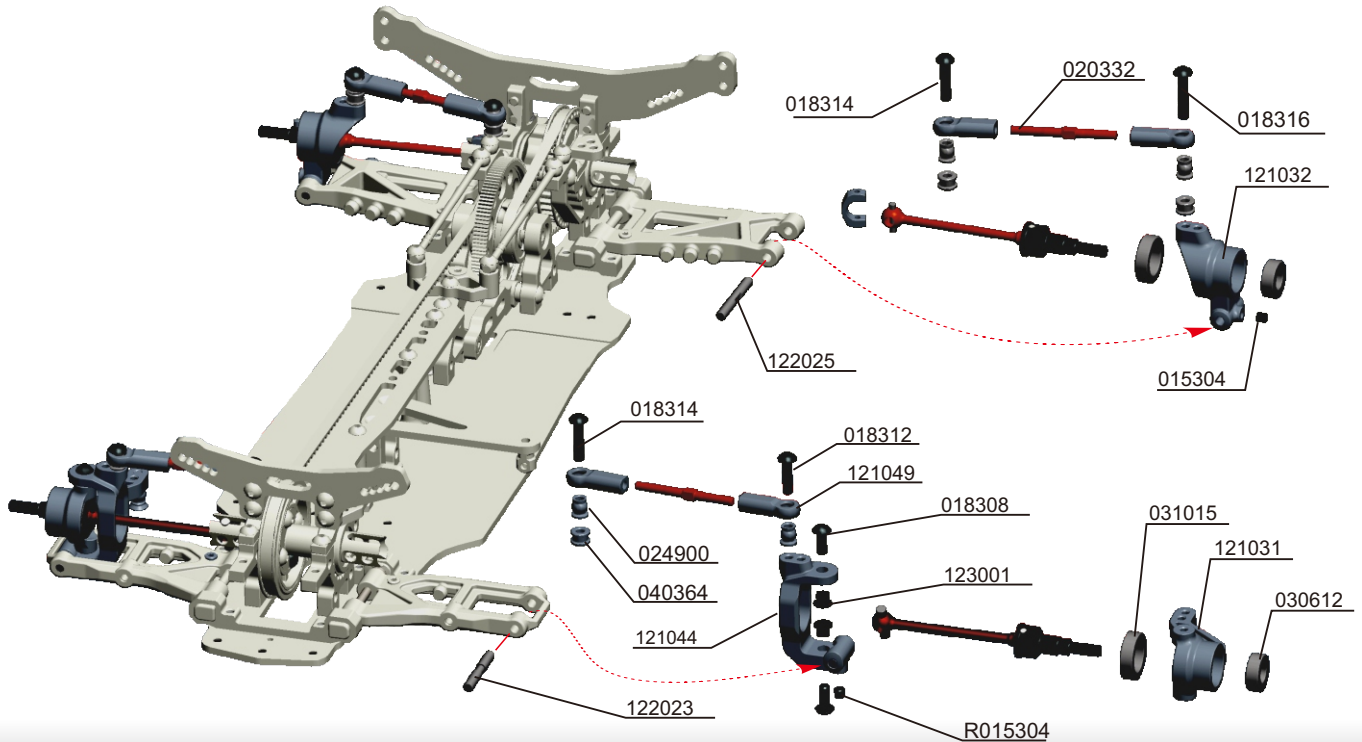

- 121049 COMPOSITE BALL JOINT 4.9MM - OPEN
- 020332 ADJ. TURNBUCKLE L/R 32 MM - SPRING STEEL
- 024900 PIVOT BALL 4.9 MM DOUBLE BEVEL SHOULDERS
- 121031 COMPOSITE STEERING BLOCK
- 121032 COMPOSITE UPRIGHT REAR
- 121044 COMPOSITE C-HUB FRONT BLOCK 4° DEG
- 122023 FRONT PIVOT PIN FOR C-HUB 3*23
- 122025 REAR PIVOT PIN FOR UPRIGHT 3*25
- 123001 STEEL STEERING BUSHING

- 018308 HEX SCREW ROUND HEAD M3x8
- 018312 HEX SCREW ROUND HEAD M3x12
- 018314 HEX SCREW ROUND HEAD M3x14
- 018316 HEX SCREW ROUND HEAD M3x16
- 030612 BALL-BEARING 6x12x4
- 040364 ALU WASHER 3x6x4
- 015304 HEX SET SCREW M3x4

TIPS FOR PRE ASSEMBLED

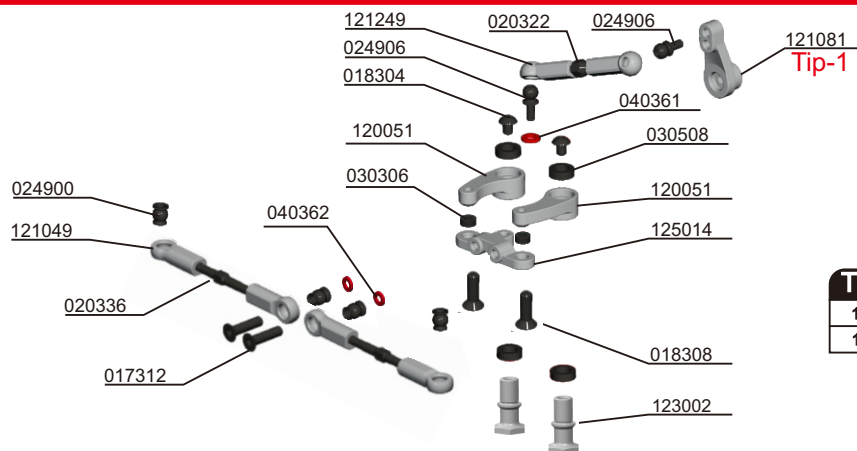
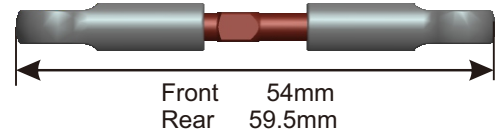

Tip-1 Servo Arm	
121081	Servo Arm-J (JR,KO)
121081	Servo Arm-F (Futaba)

- 121249 COMPOSITE BALL JOINT 4.9MM - CLOSED WITH HOLE
- 020322 ADJ. TURNBUCKLE L/R 20 MM - SPRING STEEL
- 020336 ADJ. TURNBUCKLE L/R 36 MM - SPRING STEEL
- 024906 BALL END 4.9MM WITH THREAD 6MM H2.0
- 024900 PIVOT BALL 4.9 MM DOUBLE BEVEL SHOULDERS
- 121049 COMPOSITE BALL JOINT 4.9MM-OPEN
- 120051 ALU STEERING BELL CRANK (L+R)
- 121081 COMPOSITE SERVO HORN
- 125014 ALU STEERING PLATE

- 123002 ALU STEERING POST
- 018304 HEX SCREW ROUND HEAD M3x4
- 018308 HEX SCREW ROUND HEAD M3x8
- 017312 HEX SCREW FLAT HEAD M3x12
- 030306 BALL-BEARING 3X6X2.5
- 030508 BALL-BEARING 5X8X2.5
- 040361 ALU WASHER 3x6x1
- 040362 ALU WASHER 3x6x2

TIPS FOR STEERING

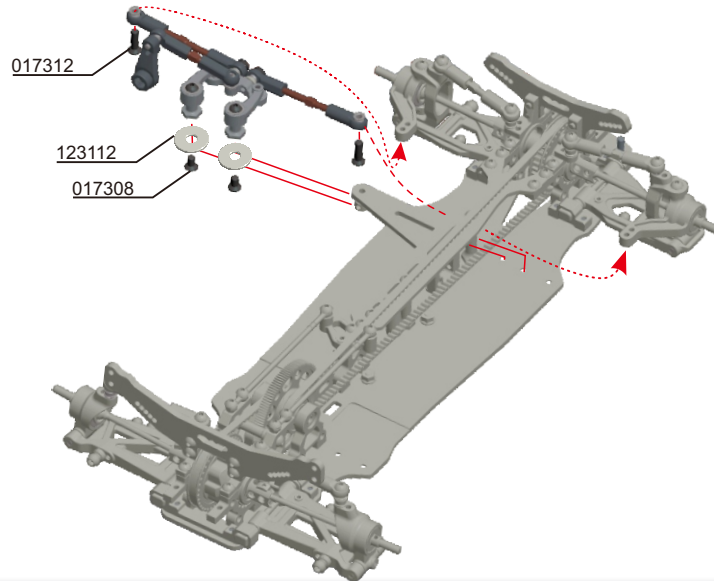
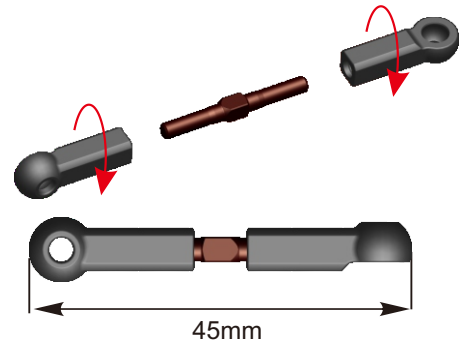
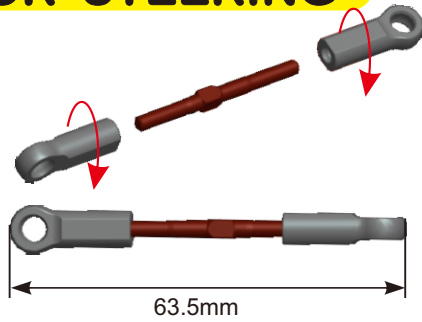

123112 ALU WASHER
017308 HEX SCREW FLAT HEAD M3x6

017312 HEX SCREW FLAT HEAD M3x12

Tip-1 Front Anti-Roll Bars

129114	Front	1.4mm
129116	Front	1.6mm
129118	Front	1.8mm

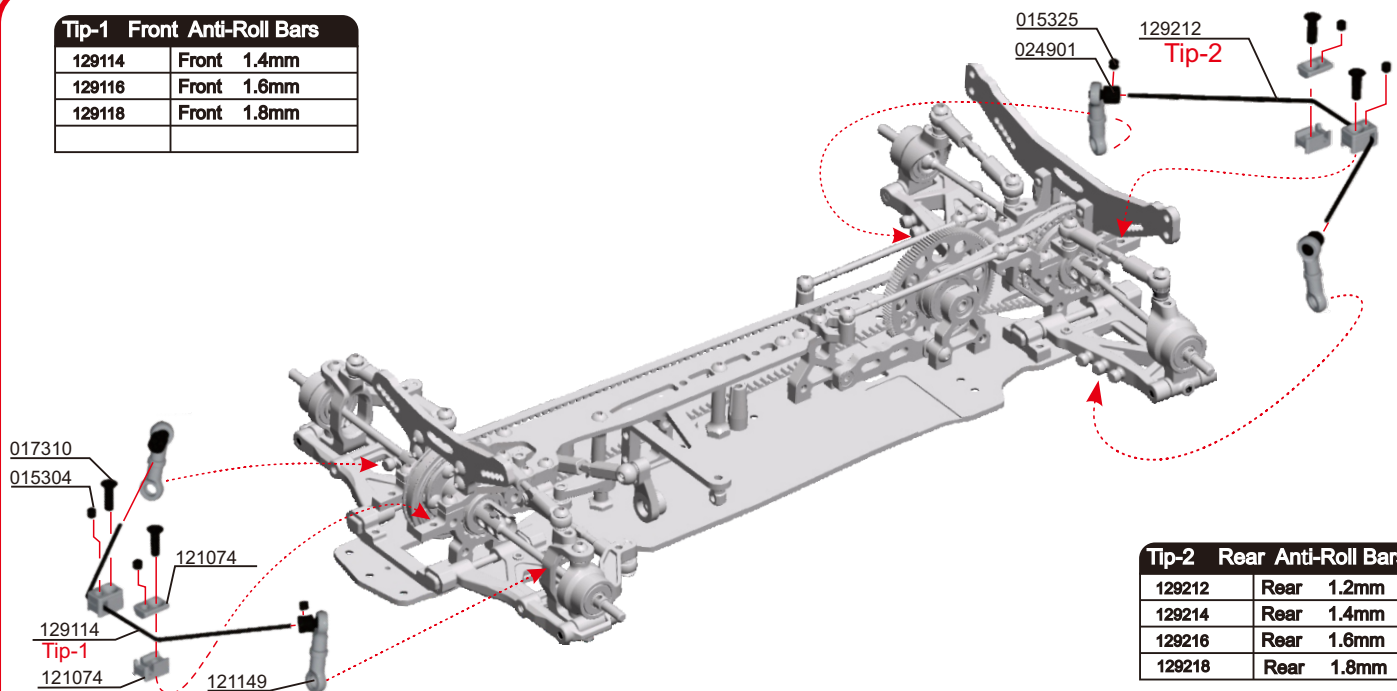

Tip-2 Rear Anti-Roll Bars

129212	Rear	1.2mm
129214	Rear	1.4mm
129216	Rear	1.6mm
129218	Rear	1.8mm

121074 COMPOSITE ANTI-ROLL BAR HOLDERS
121149 BALL JOINT 5 MM - SHORT OPEN (4)
129114 ANTI-ROLL BAR FRONT 1.4MM
129212 ANTI-ROLL BAR REAR 1.2MM

015304 HEX SET SCREW M3x4
015325 HEX SET SCREW M3x2.5
017310 HEX SCREW FLAT HEAD M3x10
024901 4.9 MM TRIPPING BALL HEAD - STEEL (4)

TIPS FOR STEERING

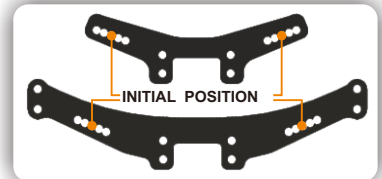
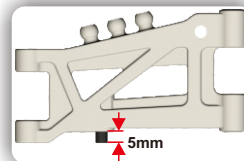
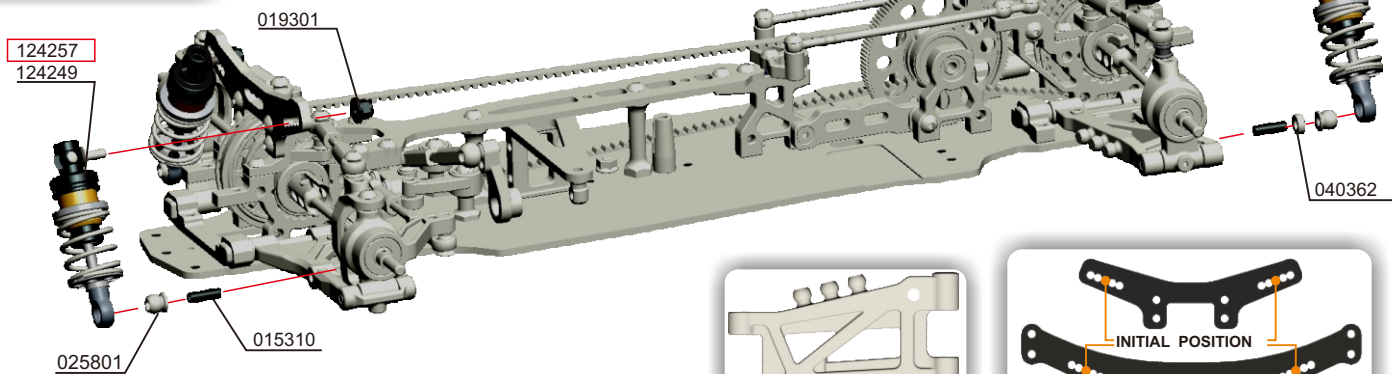
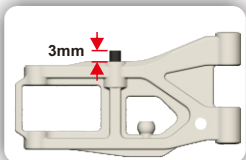
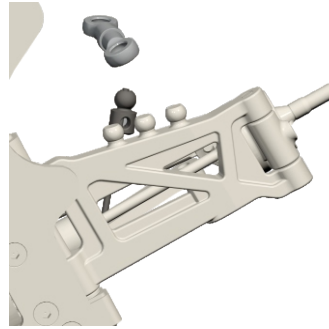
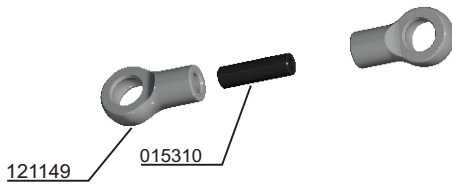

025801 BALL UNIVERSAL 5.8 MM HEX H3.0
015310 HEX SET SCREW M3x10
019301 NUT M3 WITH SERRATED FLANGE

124501 RAS-Shock Holder Tool
124249 ALU SHOCK ABSORBER-SET 18mm 12x49mm
040362 ALU WASHER 3x6x2

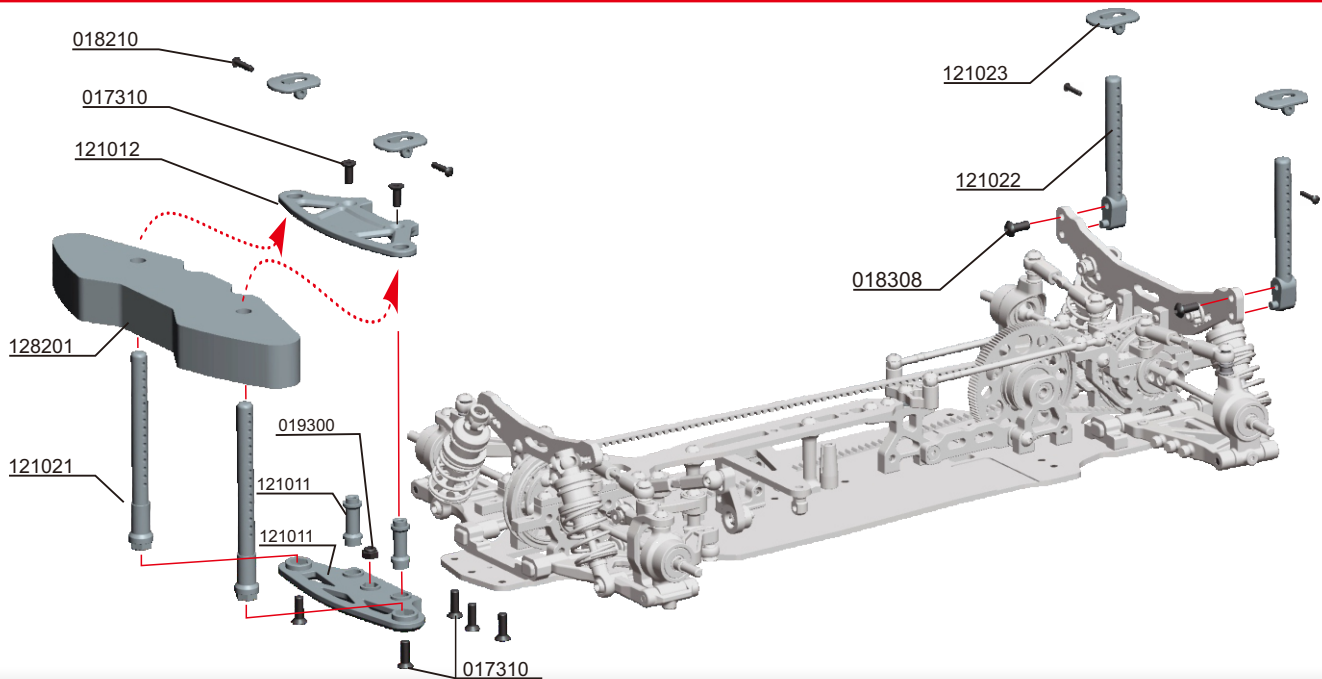

121011 COMPOSITE BUMPER
121012 COMPOSITE UPPER HOLDER FOR BUMPER
121021 FRONT BODY MOUNT SET
121022 REAR BODY MOUNT SET
121023 BODY SUPPORT

128201 FOAM BUMPER
017310 HEX SCREW FLAT HEAD M3x10
018210 HEX SCREW ROUND HEAD M2x10
018308 HEX SCREW ROUND HEAD M3x8
019300 NUT M3

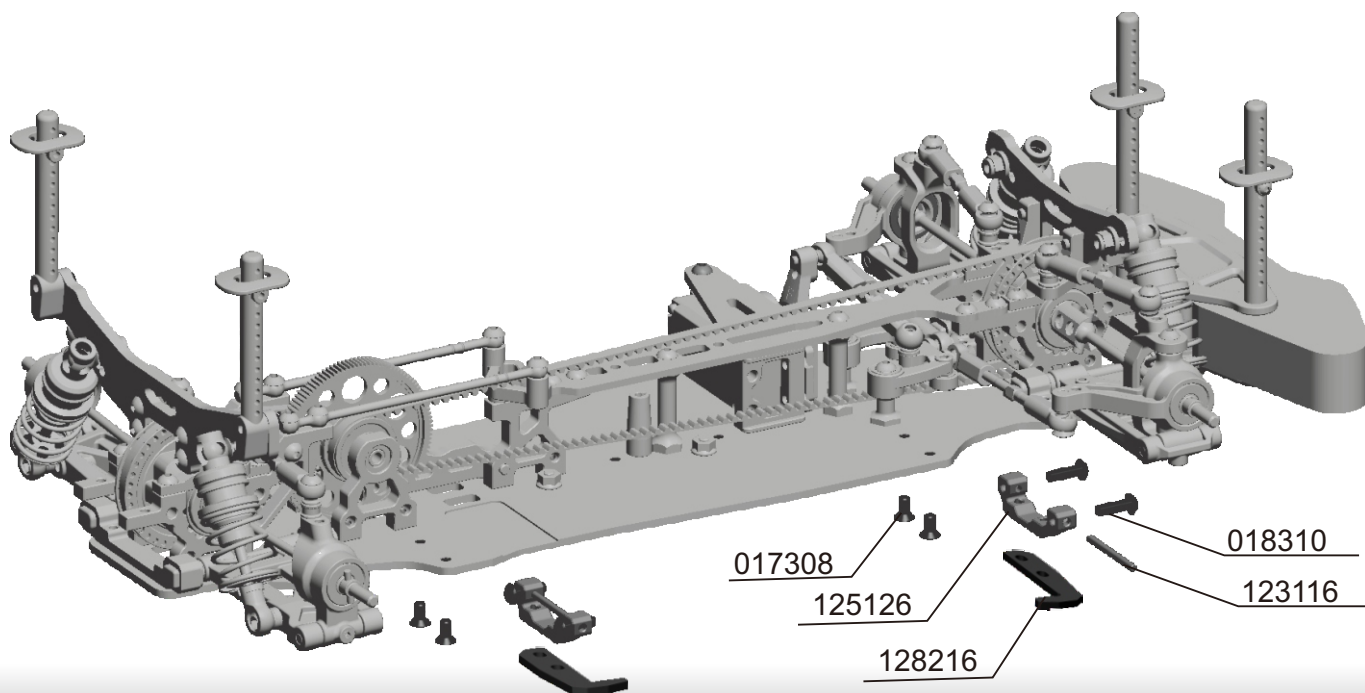

125126 ALU.Battery Holder Mount
123116 Battery Mount Holder shaft 2x24mm
128216 Graphite Battery Holder

017308 HEX SCREW FLAT HEAD M3x8
018310 HEX SCREW ROUND HEAD M3x10

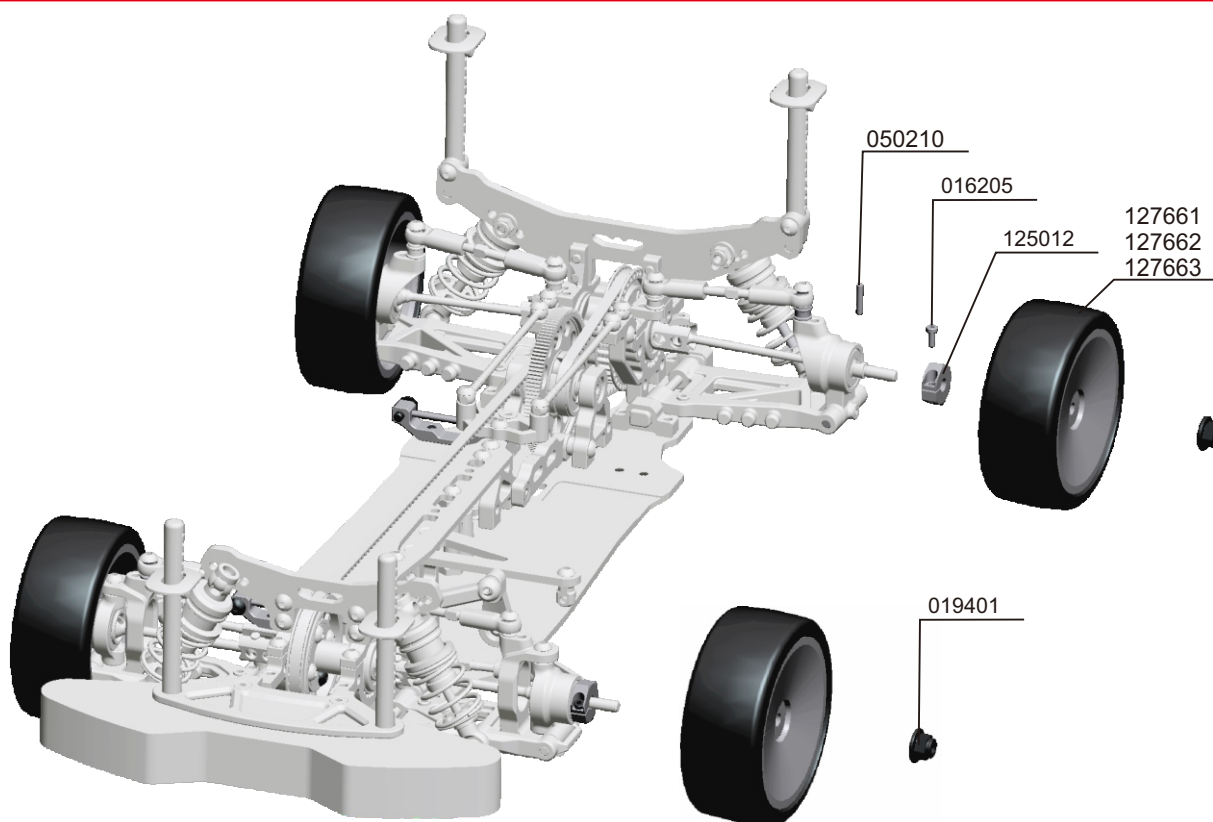

125012 OPTION ALU WHEEL HUB
019401 NUT M4 WITH SERRATED FLANGE
127661 SLICK TYRE SET

050210 PIN 2x9.8 (10)
016205 HEX SOCKET CAP SCREWS M2.5x5

1/10 ELECTRIC TOURING CAR

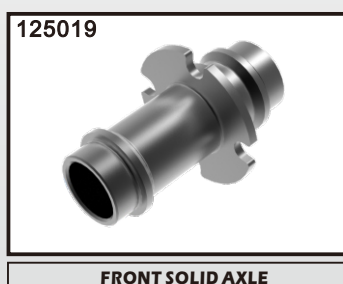
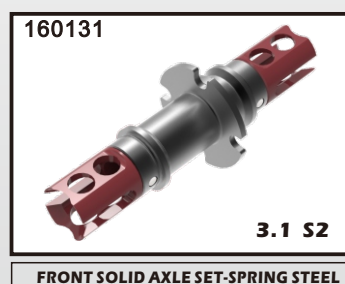
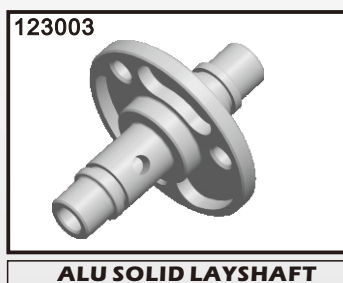
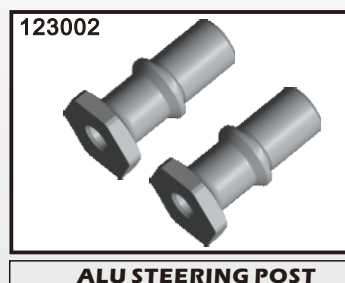
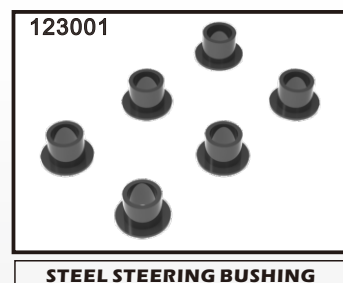
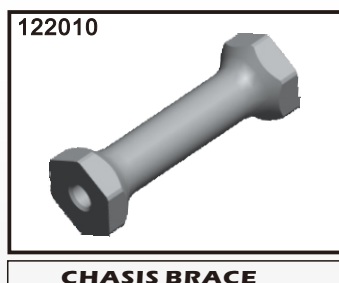
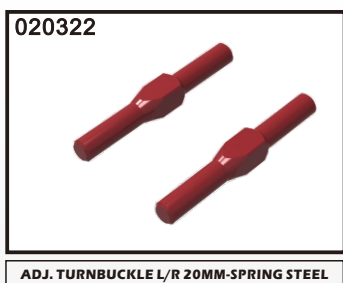
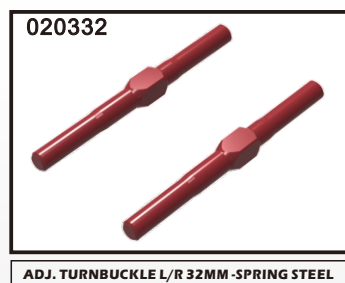
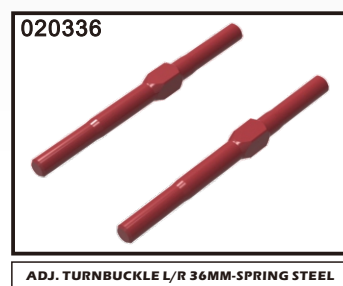
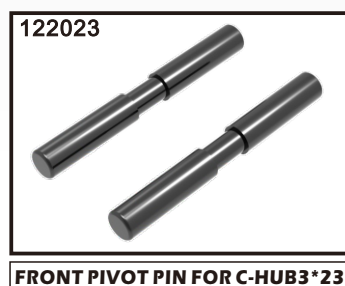
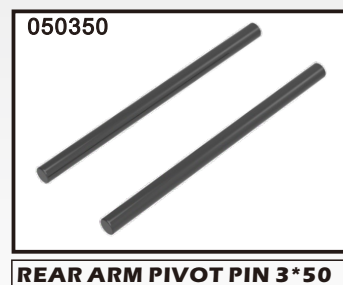
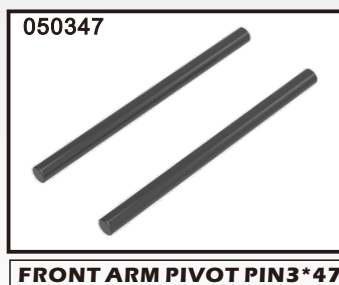
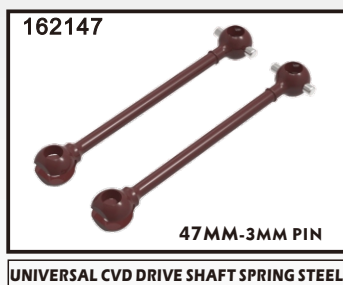
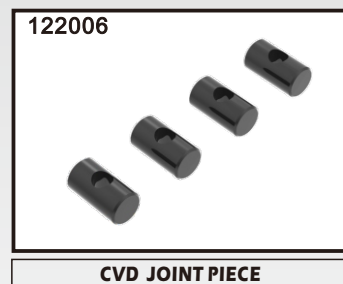
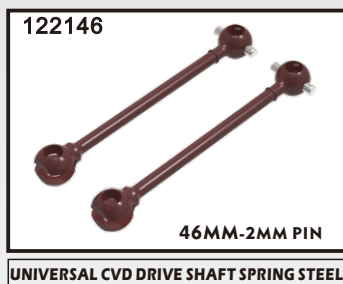
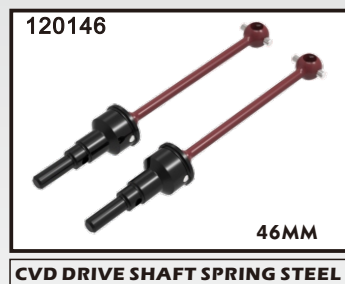

1/10 ELECTRIC TOURING CAR

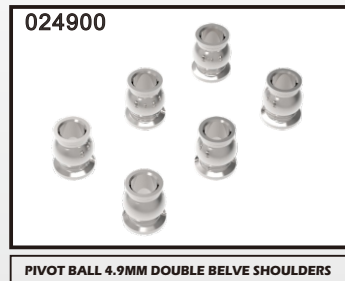
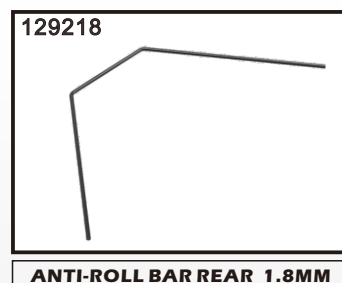
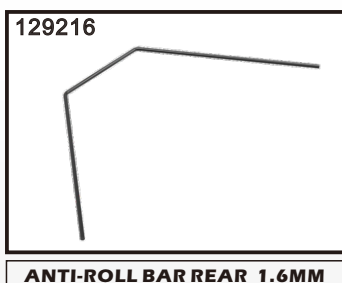
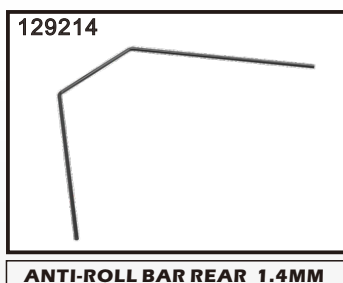
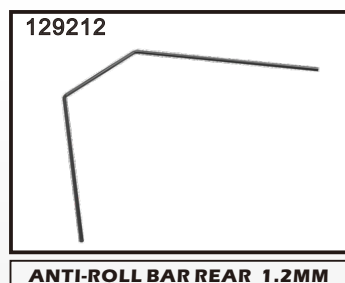
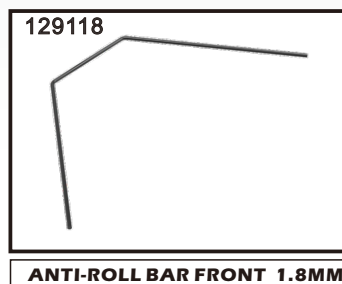
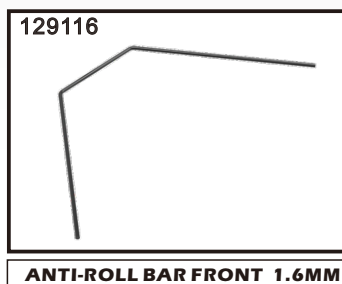
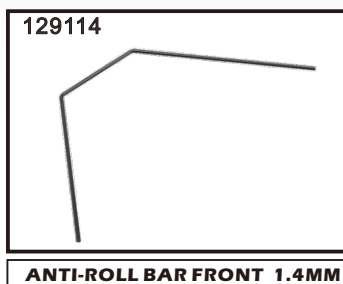
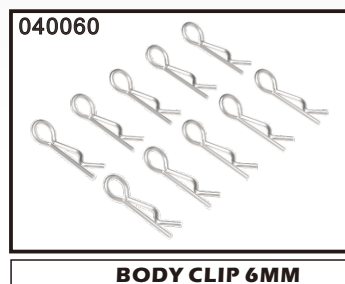
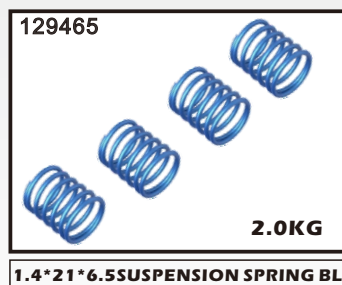
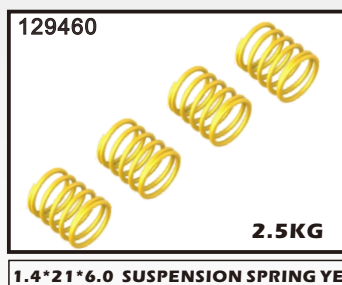
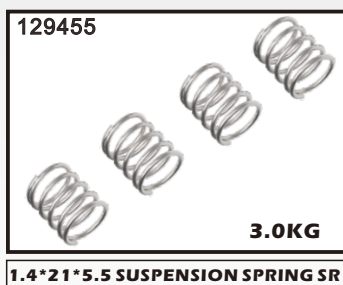
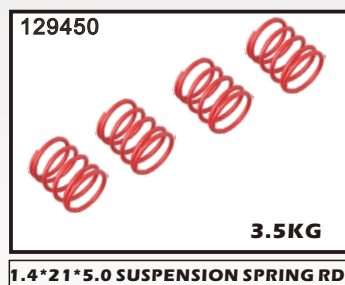
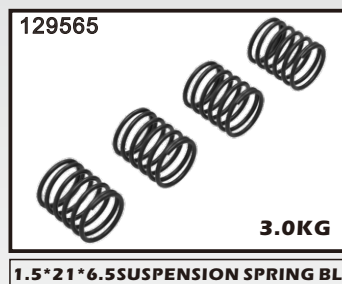
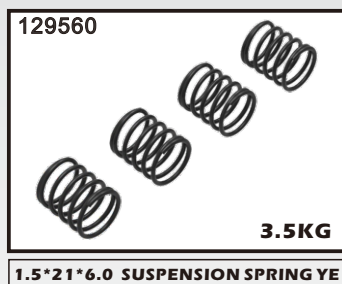
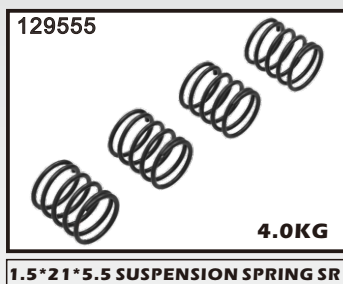
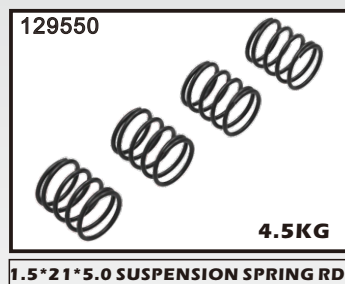

1/10 ELECTRIC TOURING CAR



025801



BALL UNIVERSAL 5.8MM HEX

025806



BALL END 5.8MM WITH THREAD 6MM

025808



BALL END 5.8MM WITH THREAD 8MM

125001

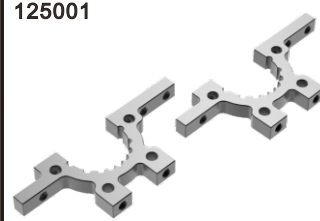

ALU LOWER SUSP. ADJUST. BULKHEAD

125004



BEARING SLEEVE CLAMP -GT CAR -(L+R)

125012



OPTION ALU WHEEL HUB

125014



ALU STEERING PLATE

125317

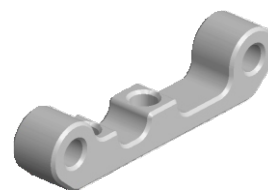

30MM FAN MOUNT

125418

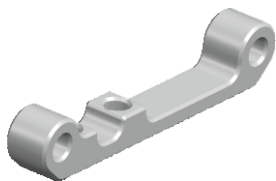

40MM FAN MOUNT

120051



ALU STEERING BELL CRANK (L+R)

125023



OPTIONAL MOTOR MOUNT

090111



PLANETARY GEAR SET-HARD COATED

090110



PLANETARY GEAR SET - PLASTIC

125029



ALU SHOCK BOTTOM CAP

060902



SILICONE O-RING 9X2

061401



SILICONE O-RING 14X1

060615



SILICONE O-RING 6X1.5

128202

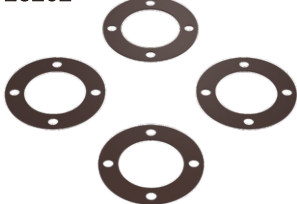

DIFF GASKEL

128201



FOAM BUMPER

127118

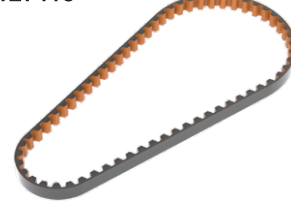

SYNCHRONOUS BELT SHORT-FIBRE-189 63T

127151



SYNCHRONOUS BENT LONG-FIBRE-513 171T

127218



SYNCHRONOUS BELT SHORT-PU KEVLAR-189 63T

127251



SYNCHRONOUS BELT LONG-PU KEVLAR-513 171T

128117

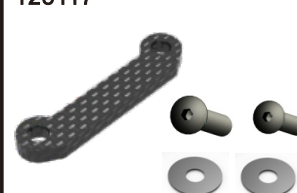

Graphite Steering Plate

1/10 ELECTRIC TOURING CAR

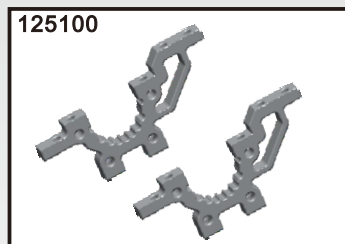

125100

Alu. Rear Bulkhead

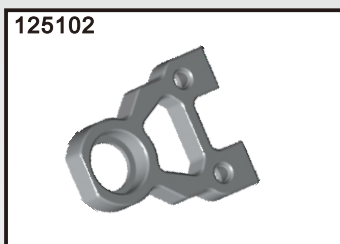

125102

Alu. Spur Gear Shaft Mount

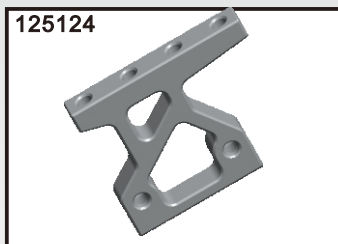

125124

Alu. Chassis Center Mount

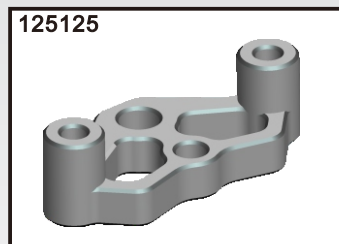

125125

Anti-Twist Bar Holder

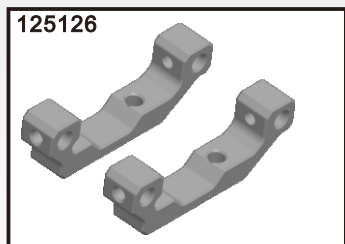

125126

ALU. Battery Holder Mount

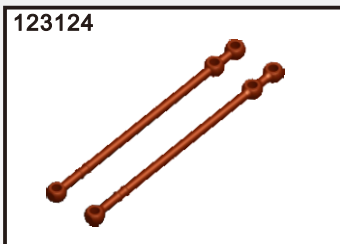

123124

Anti-Twist Bar 2.4mm

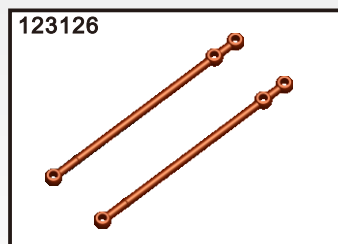

123126

Anti-Twist Bar 2.6mm

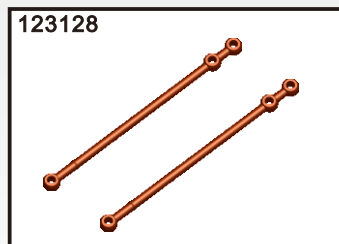

123128

Anti-Twist Bar 2.8mm

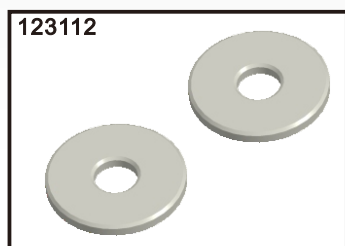

123112

ALU WASHERS

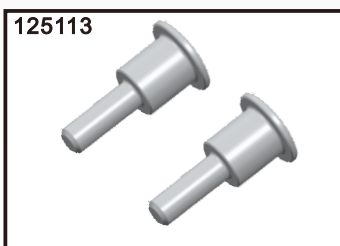

125113

Twist Bar Holder Post



123114

Bulkhead Mount Post

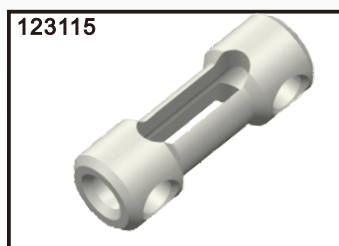

123115

Anti-roll Bar Holder

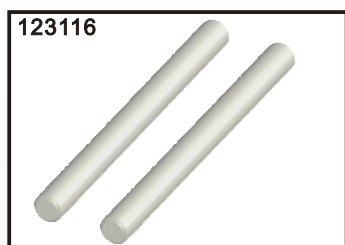

123116

Battery Mount Holder shaft 2x24mm

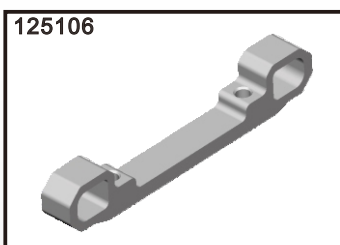

125106

Suspension Mount (FF)

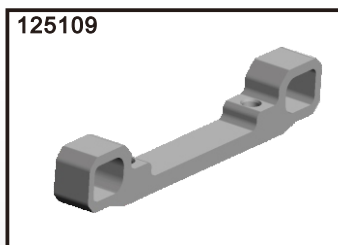

125109

Suspension Mount Holder (RR)

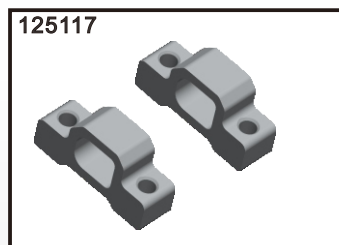

125117

Suspension Mount Separated Holder (FR,RF)

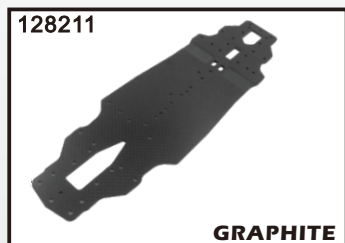

128211

GRAPHITE

Chassis 2.2mm Graphite

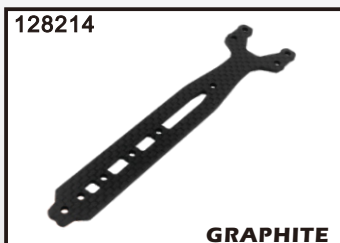

128214

GRAPHITE

Upper Deck Graphite



128213

GRAPHITE

Shock Tower (Front) 3.0mm Graphite



128212

GRAPHITE

Shock Tower (Rear) 3.0mm Graphite

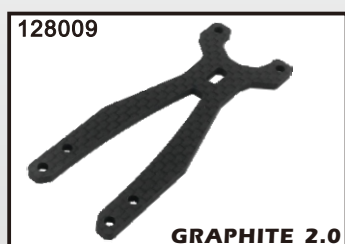

128009

GRAPHITE 2.0

Anti-Twist Rear Upper Deck 2.0mm Graphite



128109

GRAPHITE 2.5

Anti-Twist Rear Upper Deck 2.5mm Graphite



128209

GRAPHITE 3.0

Anti-Twist Rear Upper Deck 3.0mm Graphite

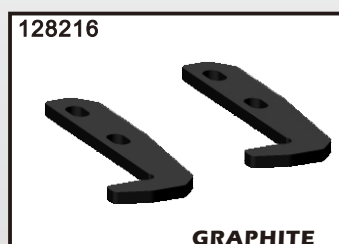

128216

GRAPHITE

Alu. Battery Holder Mount

1/10 ELECTRIC TOURING CAR

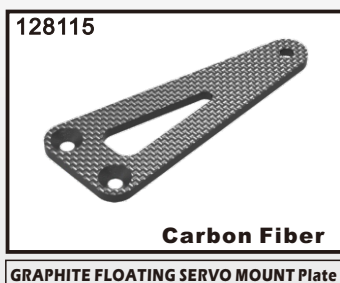
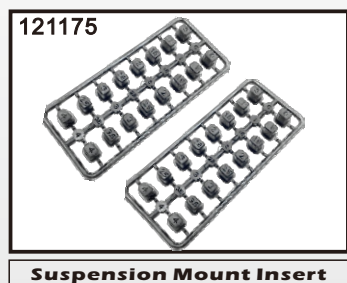
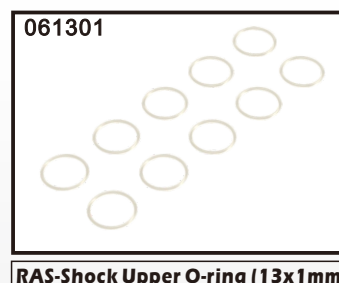
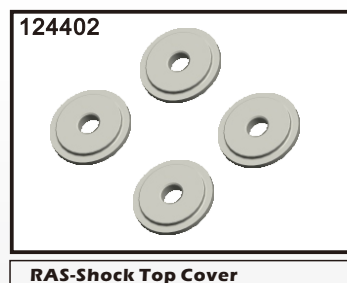
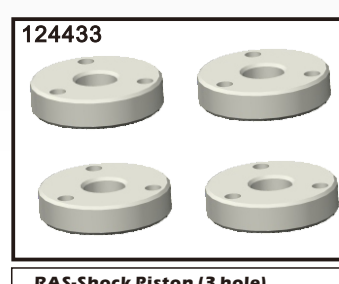
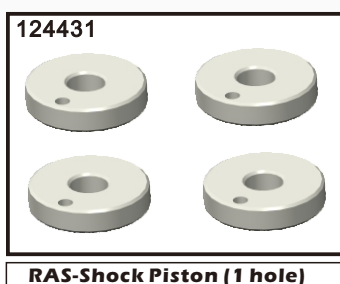
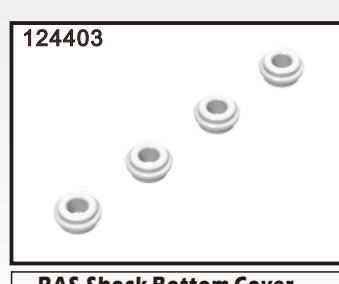
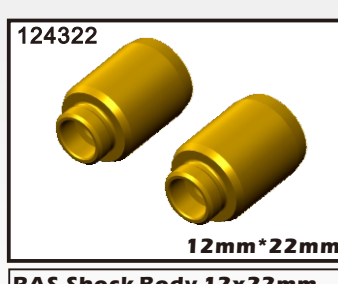
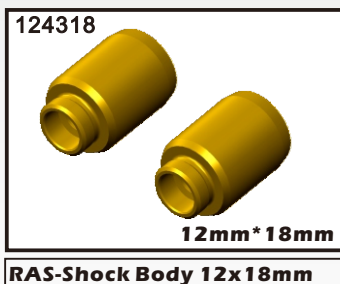

1/10 ELECTRIC TOURING CAR



161024



71 MM LENGHT

REAR BODY MOUNT SET

121031



COMPOSITE STEERING BLOCK

121032



COMPOSITE UPRIGHT REAR

121042



COMPOSITE C-HUB FRONT BLOCK 2 DEG

121044



COMPOSITE C-HUB FRONT BLOCK 4 DEG

121061



REAR SUSPENSION ARM

121062



FRONT SUSPENSION ARM

121063

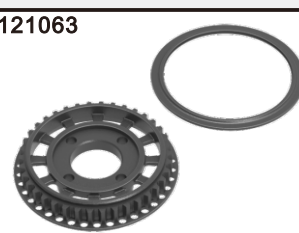

TIMING BELT PULLEY 38T

121065-WH

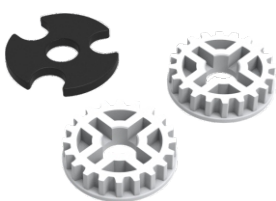

FIXED PULLEY 20T (POM)

121065



FIXED PULLEY 20T(2)

121068-WH



FIXED PULLEY 18T (POM)

121068



FIXED PULLEY 18T

121067

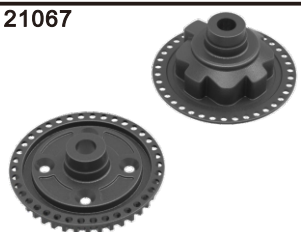

COMPOSITE GEAR DIFF. CASE & COVER

121074

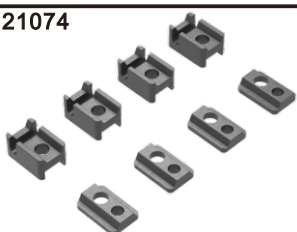

COMPOSITE ANTI-ROLL BAR HOLDERS

121096



COMPOSITEADJUSTMET BALL-BEARING HUB

121081



COMPOSITE SERVO HORN

121049



COMPOSITE BALL JOINT 4.9MM OPEN

121058



SHOCK BALL JOINT

121149



BALL JOINT 5MM-SHORT OPEN

121249



COMPOSITE BALL JOINT 4.9MM- CLOSEDWITH HOLE

121099



DRIVE SHAFT REPLACEMENT PLASTIC CAP

094084

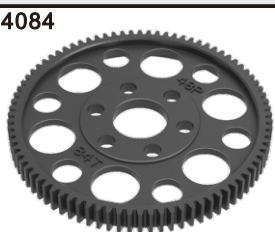

SPUR GEAR 84T/48P

096110

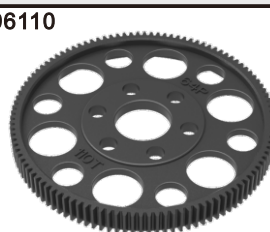

SPUR GEAR 110T/64P

094084-WH



SPUR GEAR 84T/48P POM

1/10 ELECTRIC TOURING CAR

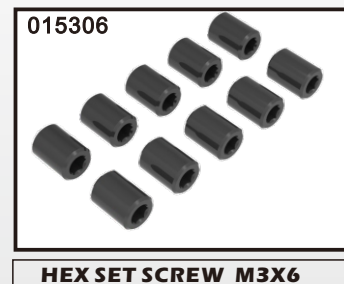
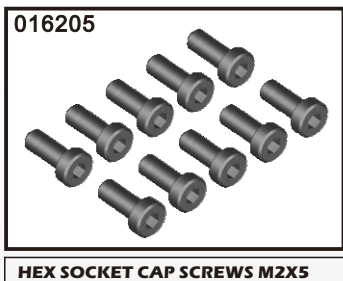
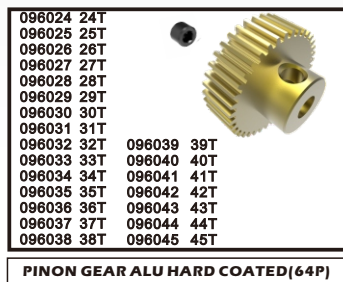
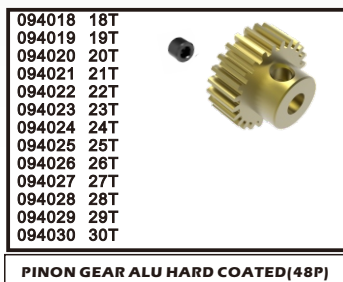
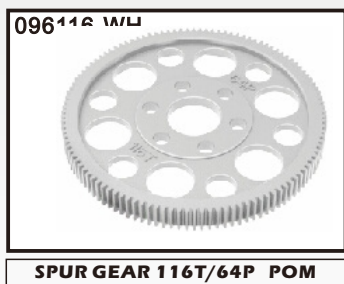
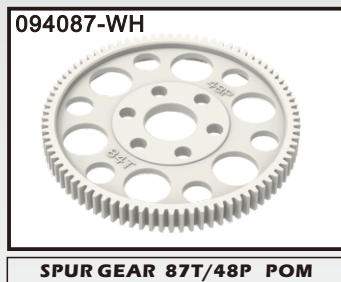
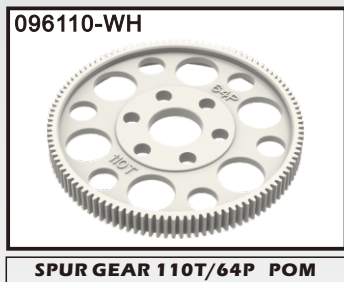

1/10 ELECTRIC TOURING CAR



HEX SET SCREW M4X8



HEX SET SCREW M4X10



HEX SET SCREW M4x12

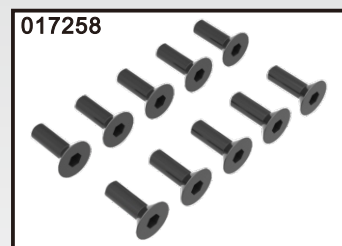

HEX SCREW FLAT HEAD M2.5X8

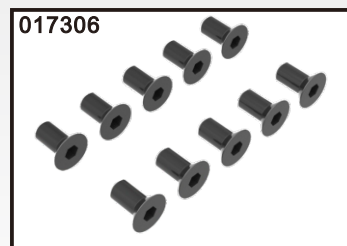

HEX SCREW FLAT HEAD M3X6

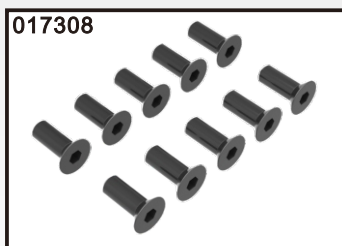

HEX SCREW FALT HEAD M3X8

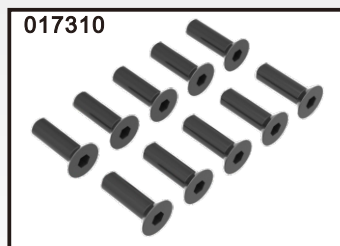

HEX SCREW FALT HEAD M3X10

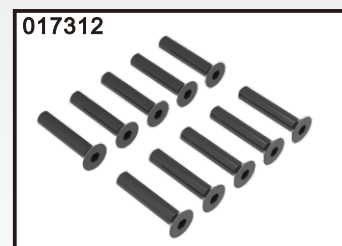

HEX SCREW FLAT HEAD M3X12

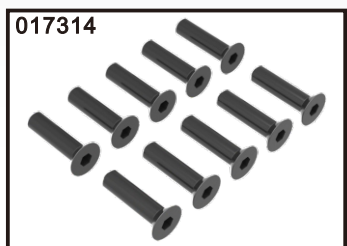

HEX SET SCREW M3X14

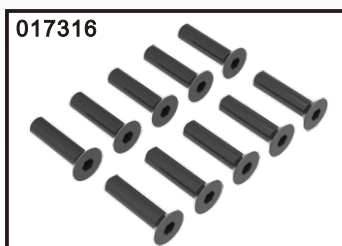

HEX SET SCREW M3X16

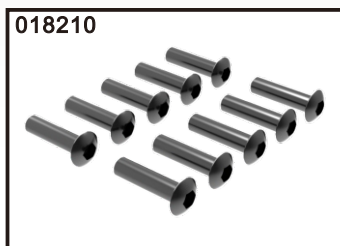

HEX SCREW ROUND HEAD M2X10



HEX SET SCREW M2.5X6

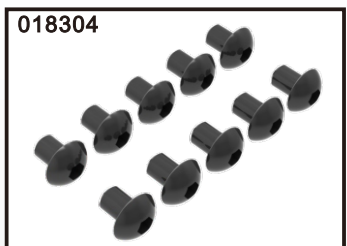

HEX SCREW ROUND HEAD M3X4



HEX SCREW ROUND HEAD M3X5

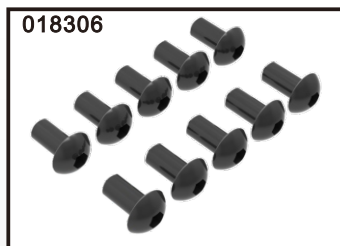

HEX SCREW ROUND HEADM3X6



HEX SCREW ROUND HEADM3X6



HEX SCREW ROUND HEAD M3X8

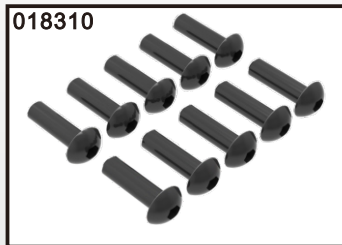

HEX SCREW ROUND HEAD M3X10

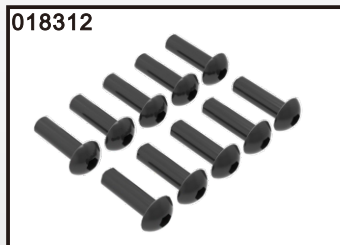

HEX SCREW ROUND HEAD M3X12



HEX SCREW ROUND HEAD M3X14

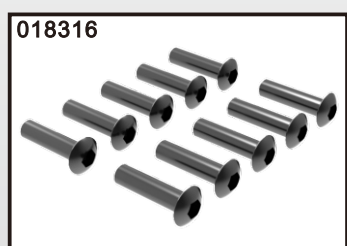

HEX SCREW ROUND HEAD M3X16



BALL-BEARING 3X6X2.5



BALL-BEARING 5X8X2.5



BALL-BEARING 5X10X4

1/10 ELECTRIC TOURING CAR

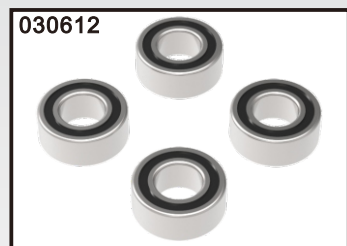

BALL-BEARING 6X12X4

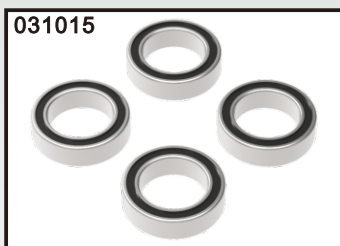

BALL-BEARING 10X15X4

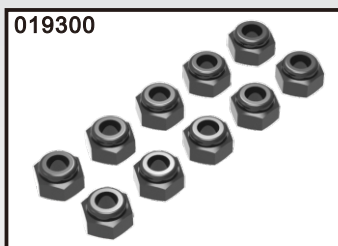

NUT M3



NUT M3 WITH SERRATED FLANGE



NUT M4 WITH SERRATED FLANGE

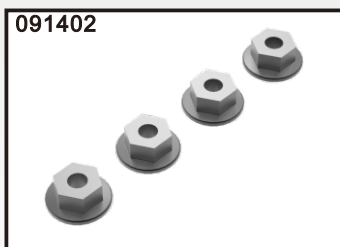

HEX SET SCREW M3X2.5

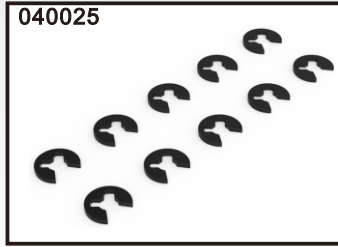

E-CUP 2.5

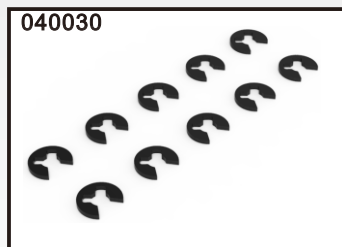

E-CUP 3

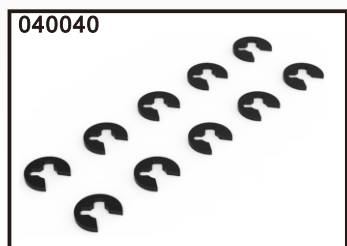

E-CUP 4



E-CUP 5

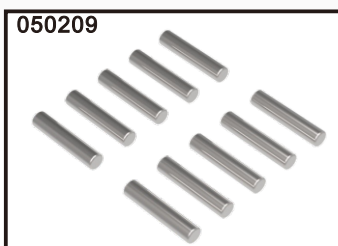

PIN 2X9.0

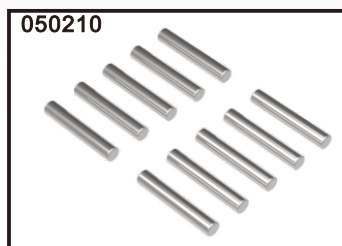

PIN 2X9.8

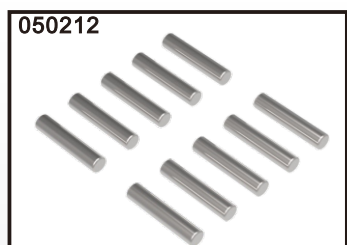

PIN 2X12

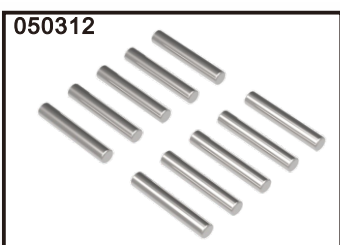

PIN 3X12

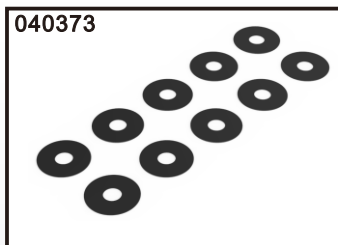

WASHER S 3X7X0.3

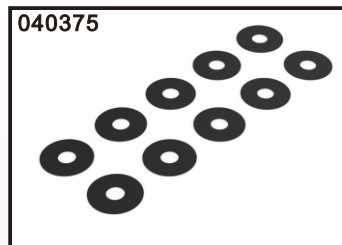

WASHER S 3X7X0.5

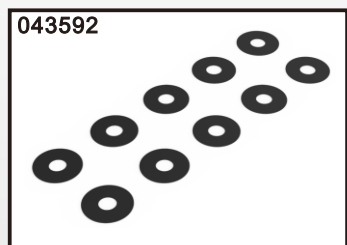

WASHER S 3.5X9X0.2

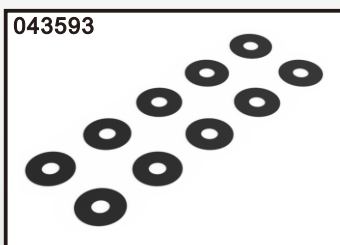

WASHER 3.5X9X0.3

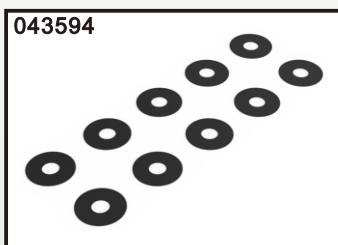

WASHER 3.5X9X0.4

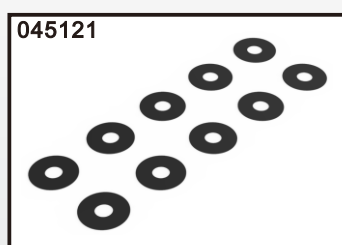

WASHER 5X12X0.1

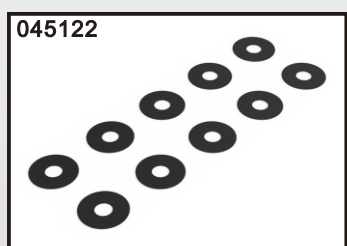

WASHER 5X12X0.2

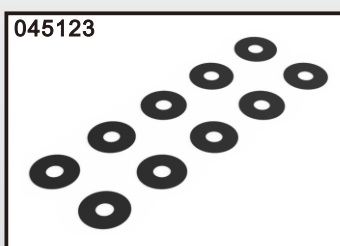

WASHER 5X12X0.3

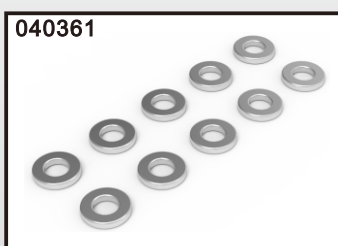

ALU WASHER 3X6X1

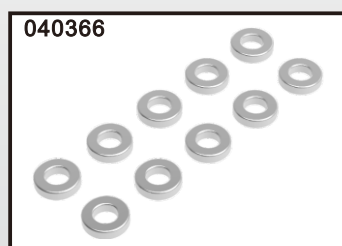

ALU WASHER 3X6X1.5

1/10 ELECTRIC TOURING CAR



040362

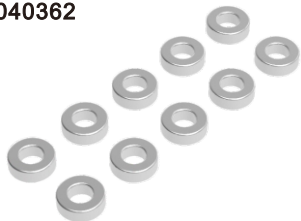

ALU WASHER 3X6X2

040363

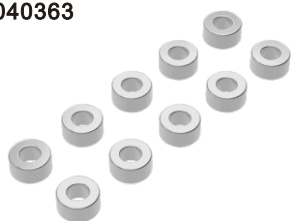

ALU WASHER 3X6X3

040364

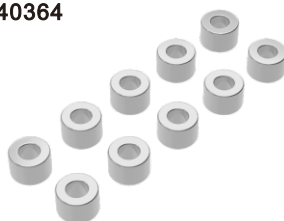

ALU WASHER 3X6X4

040365

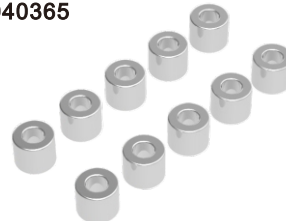

ALU WASHER 3X6X5

030102



WHOLE VEHICLE BEARING

019502

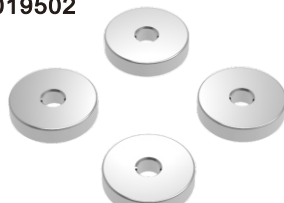

2g

ROUND SHAPE BALANCE WEIGHT

019503

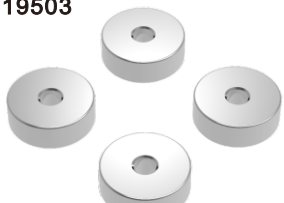

3g

ROUND SHAPE BALANCE WEIGHT

019505



5g

ROUND SHAPE BALANCE WEIGHT

019510



10g

ROUND SHAPE BALANCE WEIGHT