

# MTS-T3

1/10 Electric Touring Pro Car Kit  
Instruction Manual

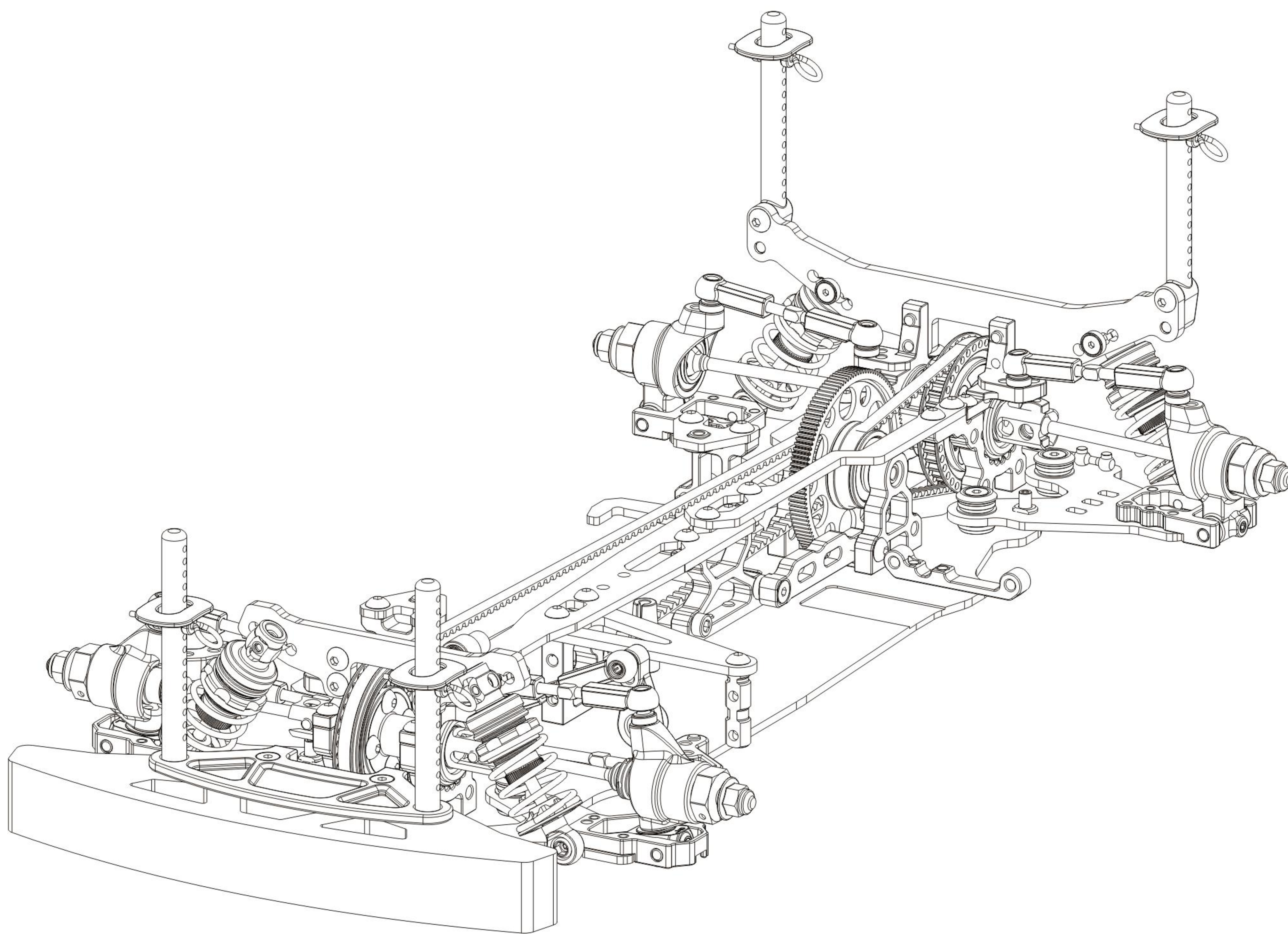

Powered By:





## Introduction:

1:10 Touring Car kit is a professional 1:10<sup>th</sup> 4 wheel drive car and should be built by aged 14 years or over or that they had experience building and operating R/C model cars before. This is not a toy intended for use by beginners or by children without any supervision of a knowledgeable adult. Please read the instruction manual carefully before building.

Race opt should not be liable for any loss, injury or damages, whether direct, indirect, special, incidental, consequential, arising from the use, misuse, abuse of this product or accessories required to operate this product.

## Warnings:

- ⦿ This product is not intended for those ages under 14 year without any adult supervision.
- ⦿ Assemble this kit only in places away from the reach of children.
- ⦿ Exercise car when using tools and sharp instrument and take care some parts that may have sharp edges when building.
- ⦿ Please do not touch any electronic equipment on the model such as motor and speed controller that having higher temperatures after the operation. Otherwise, it may burn yourself seriously by touching them. Better to allow 10~15 minutes to let any electronic equipment cool down.
- ⦿ Please complete a successful pre-run check of your radio equipment and model before the run. Make sure to keep the wheels of the model off the ground when checking the operation of the radio equipment.
- ⦿ When on the model, please always turn on the transmitter before turn on the receiver in the car. When off the model, please always turn off the receiver before turn off the transmitter. Otherwise, the model may become uncontrollable and cause serious damage.
- ⦿ Disconnect the battery pack before storing your model.
- ⦿ Do not get overcharge for the battery or leave battery unattended while charging. Never let children charge the battery without adult supervision.
- ⦿ Do not operate it on public places, roads or areas where its operation can conflict with or disrupt pedestrian or vehicular traffic.
- ⦿ Do not use your model as shown below:

In places where children and people gather	In rain, wind snow or darkness condition
In areas where loud noises can disturb others	At anytime your line of sight to the model may be obstructed or impaired in any way



## Electrical Precautions:

- ⦿ Please do not allow any metal part to short circuit the battery or any electronic part using inside the car kit.
- ⦿ Never put batteries into fire.
- ⦿ Use the recommended charger for the transmitter battery and battery for electronic speed control. Please follow the charging instructions carefully. Please do not over charge the battery or choose the wrong charging mode. It becomes dangerous that causes the explosion and lead to the fire. If battery becomes extremely hot during the charging, please seek the advice from or get replacement from the corresponding battery supplier.
- ⦿ Please unplug charger when not in use.
- ⦿ When not using RC model, please always disconnect and remove the battery.
- ⦿ Low battery may result in loss of control. Please stop running the car at once when you find its speed start to slow down.
- ⦿ After use the battery, the battery remains heat and please recharges it after the battery is cool down.
- ⦿ Never use damaged wires that are dangerous and cause short circuits and may lead to the fire.

## Other Equipment Needed (not included):

Radio transmitter & receiver	Battery for transmitter
Electronic speed control	Steering Servo
540 Type brushes or brushless motor	Pinion Gear (48pitch/64pitch)
190mm body shell	7.4V Nimh or Lipo Battery
Touring Car Tire set	Battery charger

## Tools Needed (not included):

1.5mm, 2.0mm, 2.5mm allen wrench	5.0mm, 5.5mm, 7.0mm hex socket wrench
Modelers craft knife	Turnbuckle wrench
Calipers/Ruler	Camber gauge
Instant glue/Thread lock glue	Shock and Diff Oil
Thrust, Diff and Joint grease	Paint for body shell

Notes: All replacement parts can be found from [www.race-opt.com](http://www.race-opt.com) and can be purchased from local hobby shop. If any further information needed, please email to [enquiry@rc-explorer.com](mailto:enquiry@rc-explorer.com).



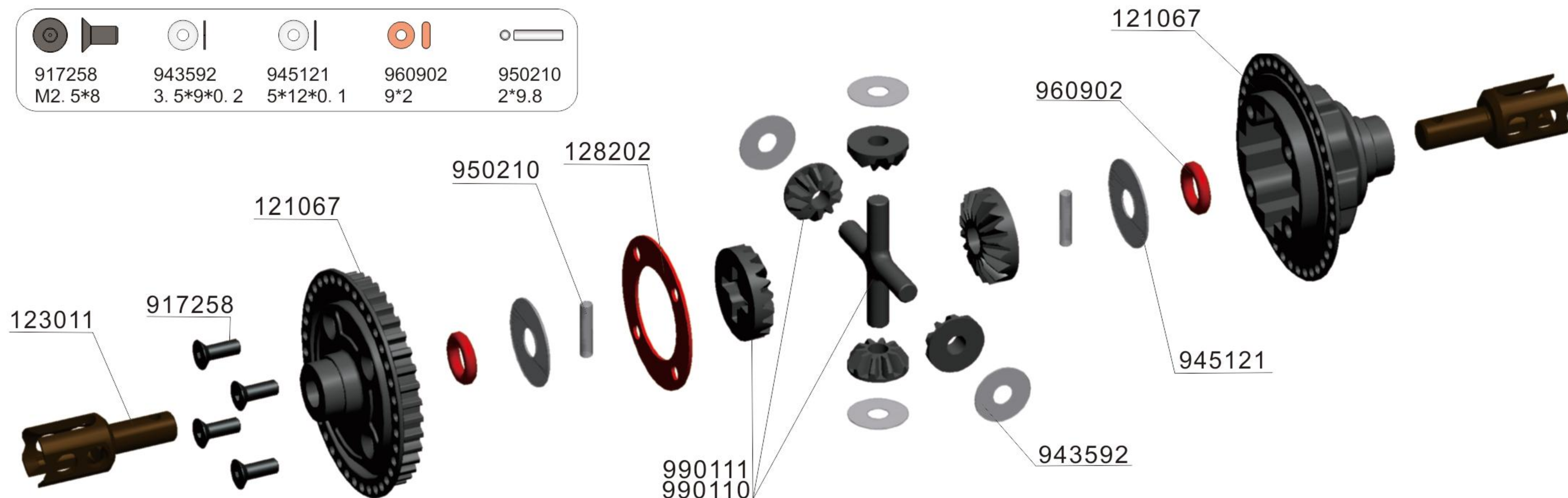

990110 PLANETARY GEAR SET-PLASTIC  
 990111 PLANETARY GEAR SET-HARD COATED  
 123011 UNIVERSAL CVD DRIVE SHAFT-SPRING STEEL 3.6 S2

121067 COMPOSITE GEAR DIFF. CASE & COVER  
 128202 DIFF GASKET 26mm



**Low-Traction**  
 500 c/t

**High-Traction**  
 1000 c/t

+ 1.3g

Add 1.3g of oil the diff.

! LOCATION

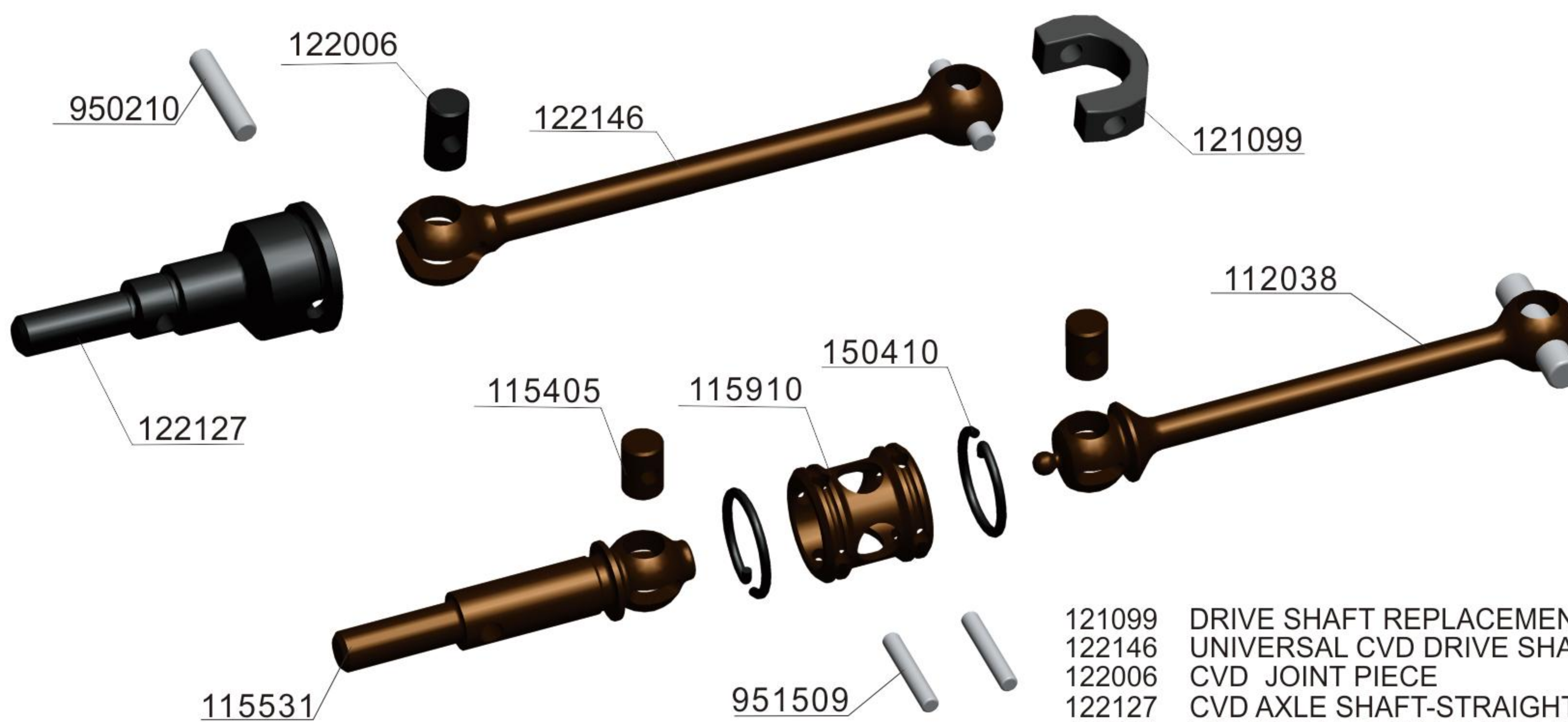
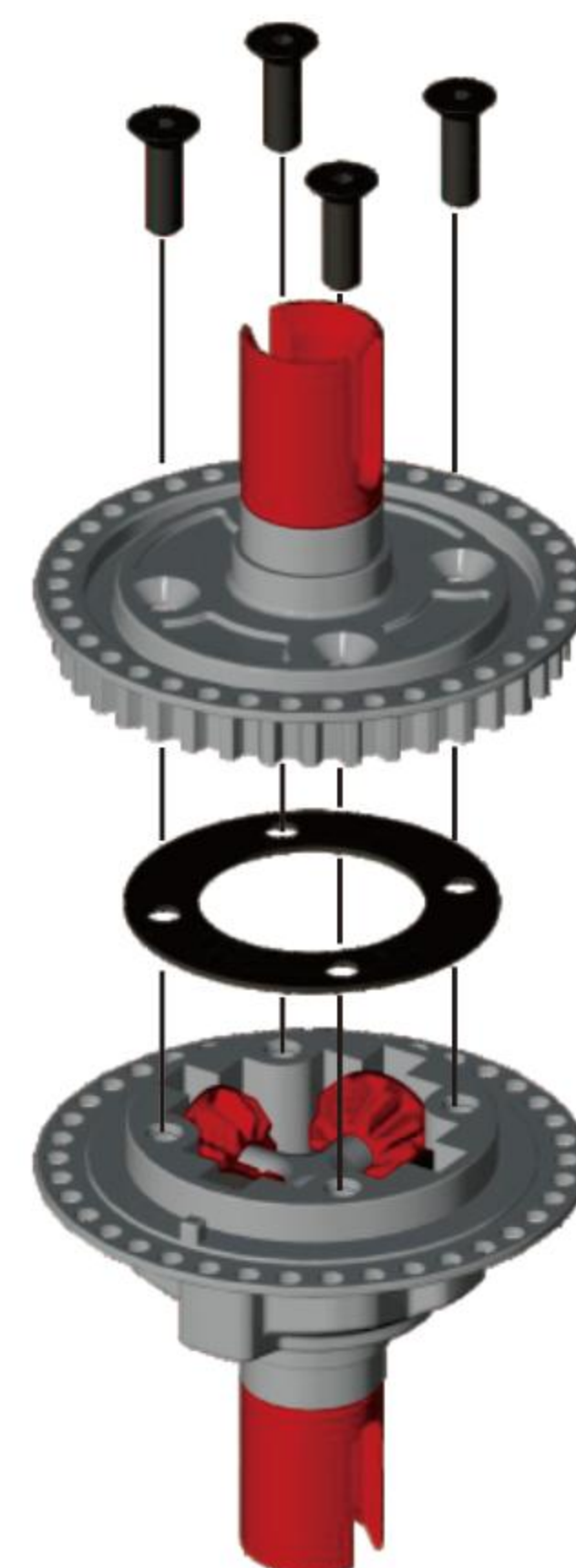

951509 1. 5\*9  
 950210 2\*9.8

121099 DRIVE SHAFT REPLACEMENT PLASTIC CAP  
 122146 UNIVERSAL CVD DRIVE SHAFT-SPRING STEEL 46mm 2.0PIN-S2  
 122006 CVD JOINT PIECE  
 122127 CVD AXLE SHAFT-STRAIGHT  
 115910 UNIVERSAL DRIVE SHAFT JOINT HOUSING (SPRING STEEL)  
 150410 UNIVERSAL DRIVE SHAFT JOINT HOUSING C-CLIP  
 115405 UNIVERSAL DRIVE SHAFT CROSS JOINT  
 115531 UNIVERSAL DRIVE SHAFT AXLE (SPRING STEEL)  
 112038 38MM UNIVERSAL DRIVE SHAFT (SPRING STEEL)- 3.0 PIN-S2



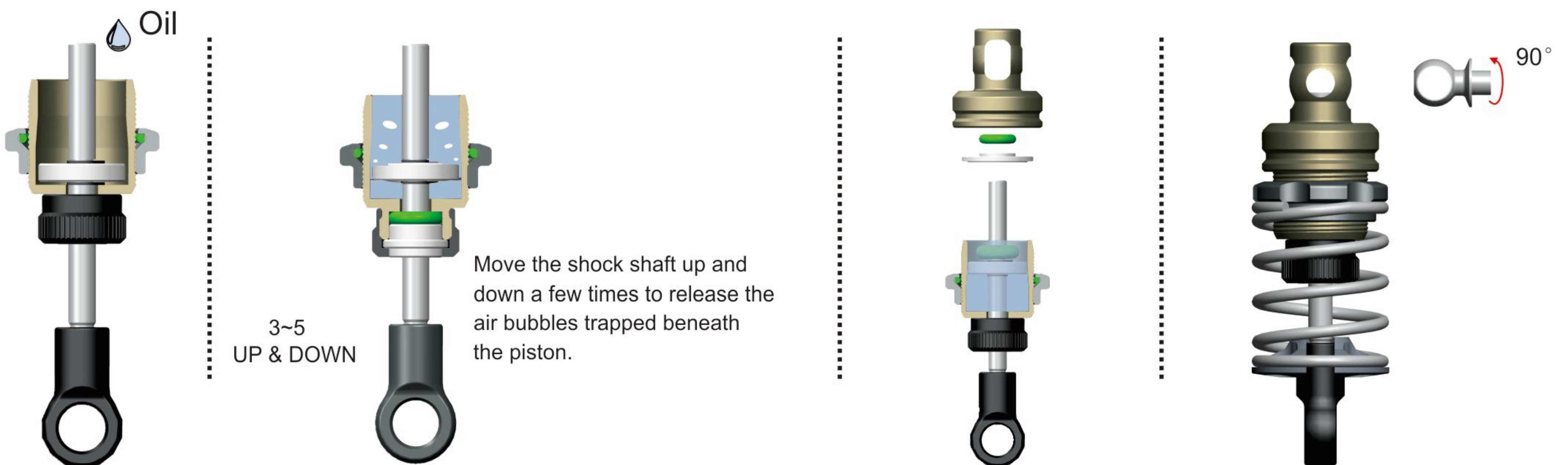
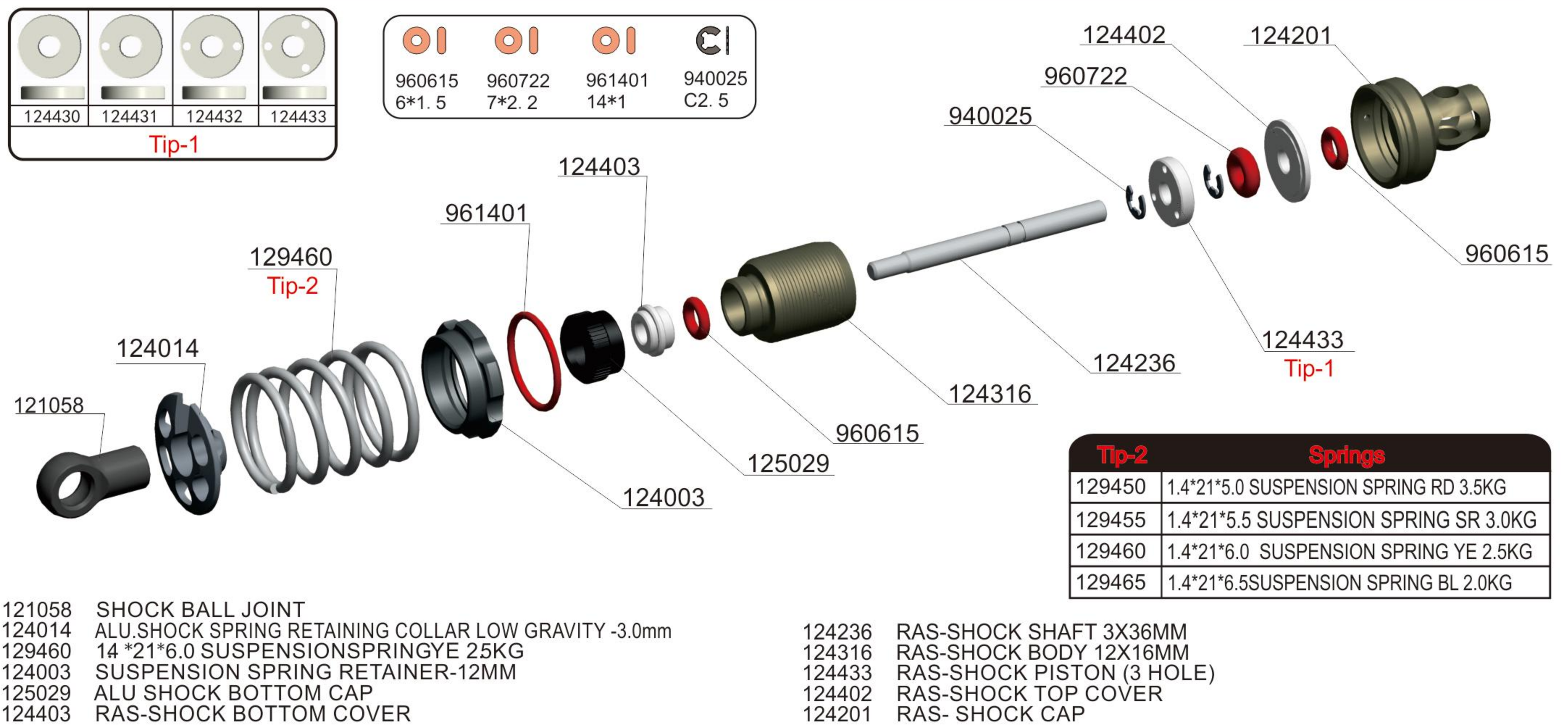
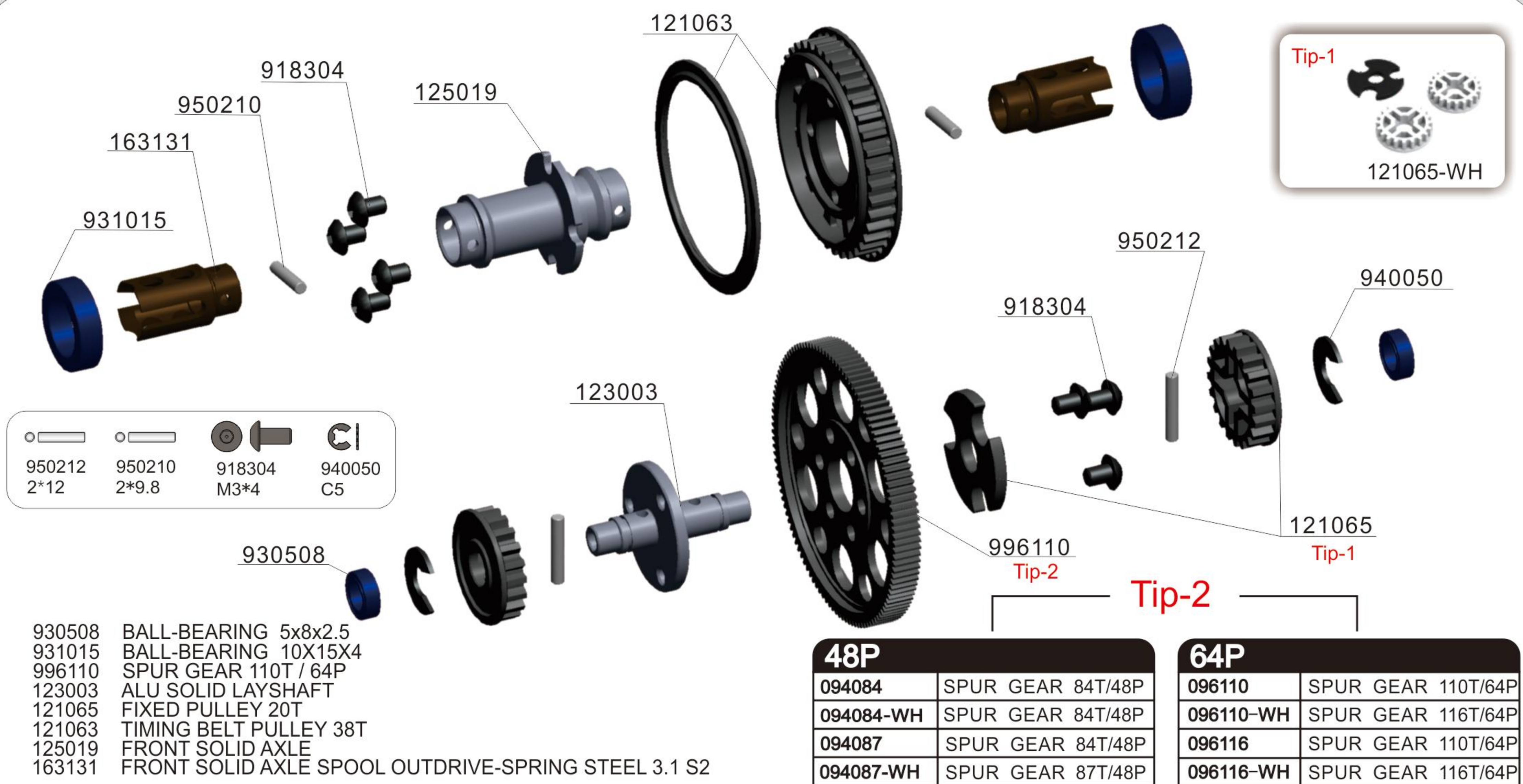



# MTS -T3

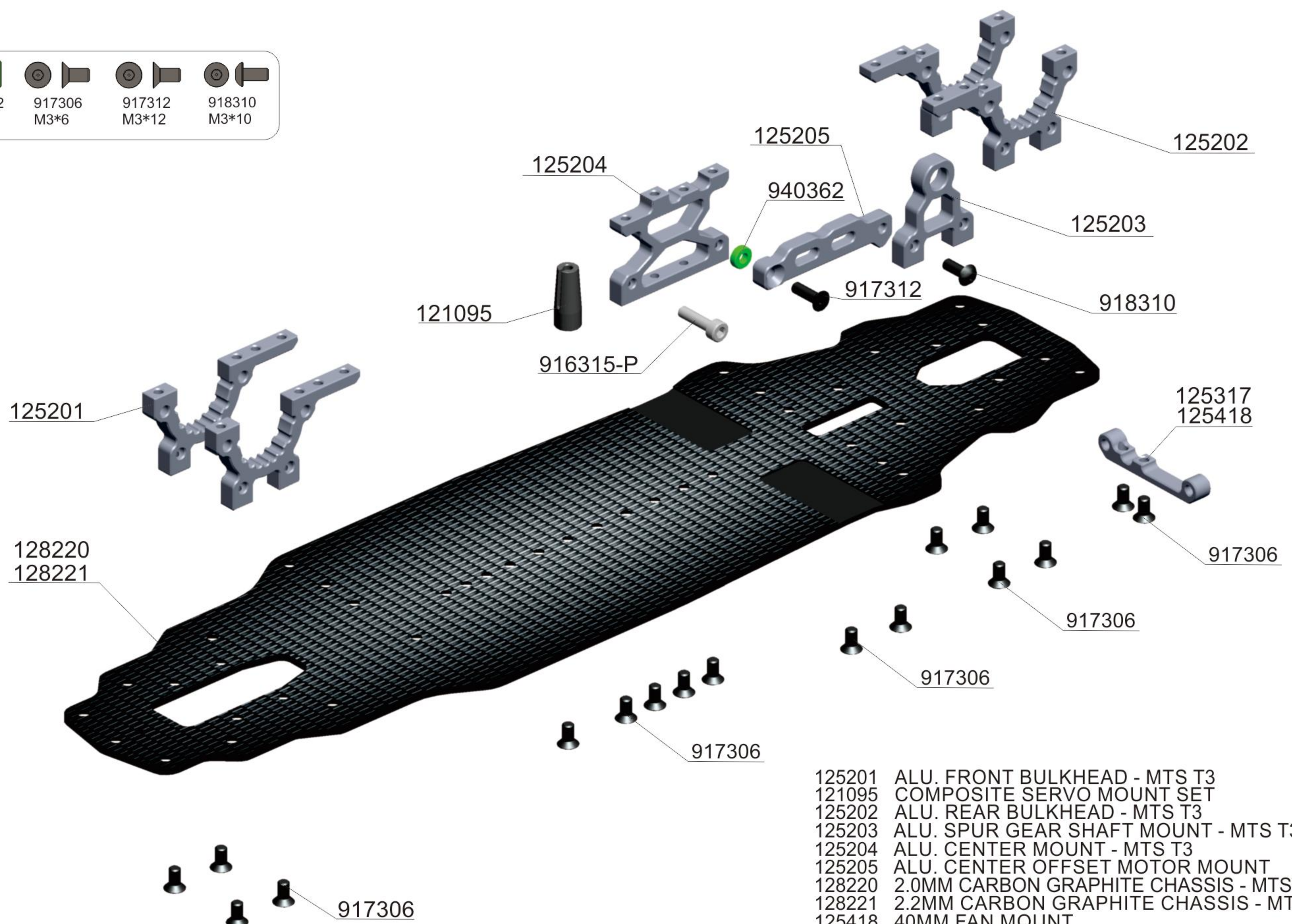

- 125201 ALU. FRONT BULKHEAD - MTS T3
- 121095 COMPOSITE SERVO MOUNT SET
- 125202 ALU. REAR BULKHEAD - MTS T3
- 125203 ALU. SPUR GEAR SHAFT MOUNT - MTS T3
- 125204 ALU. CENTER MOUNT - MTS T3
- 125205 ALU. CENTER OFFSET MOTOR MOUNT
- 128220 2.0MM CARBON GRAPHITE CHASSIS - MTS T3
- 128221 2.2MM CARBON GRAPHITE CHASSIS - MTS T3
- 125418 40MM FAN MOUNT
- 125317 30MM FAN MOUNT
- 916315-P HEX SOCKET CAP SCREW M3X15 PLASTIC

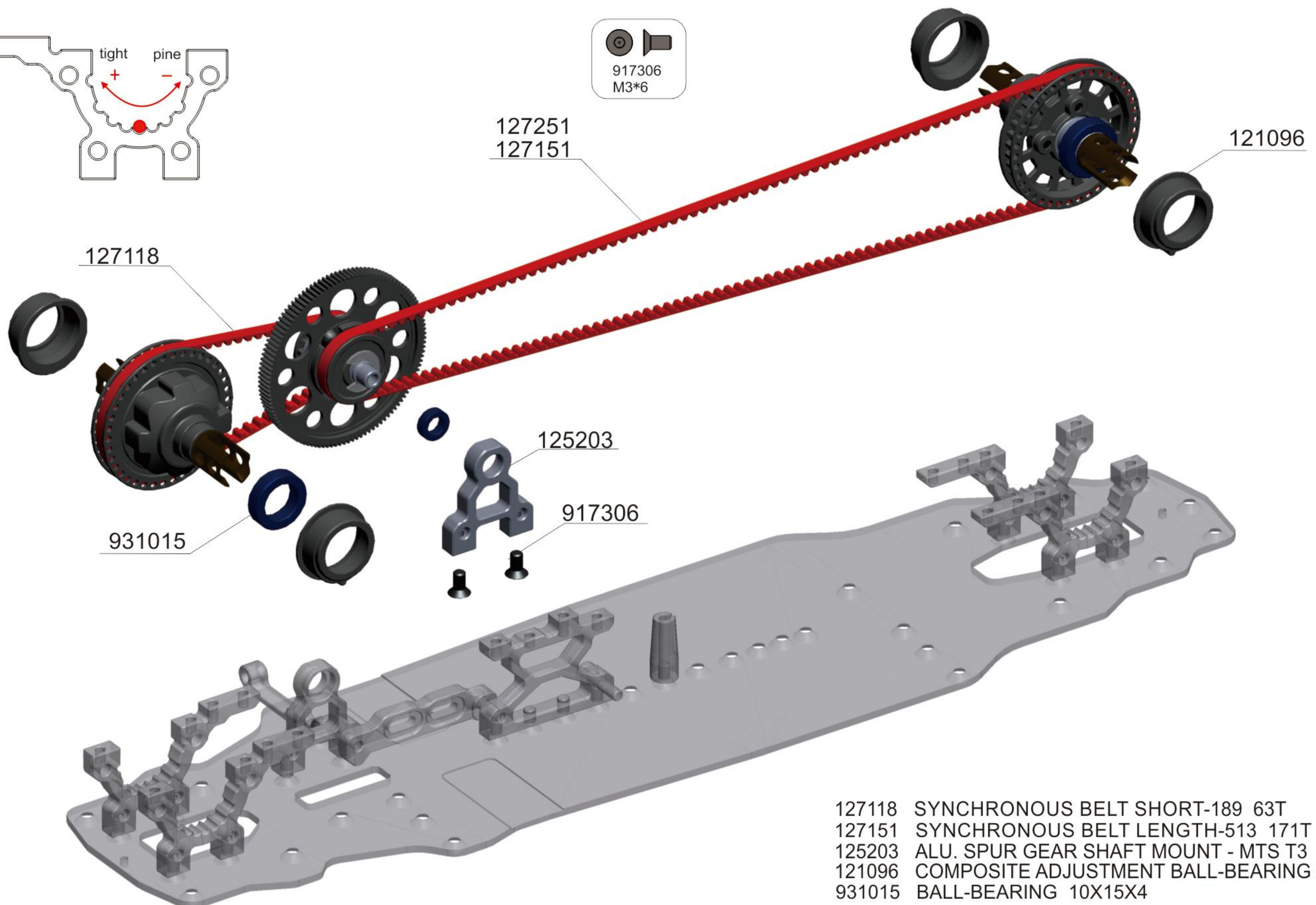
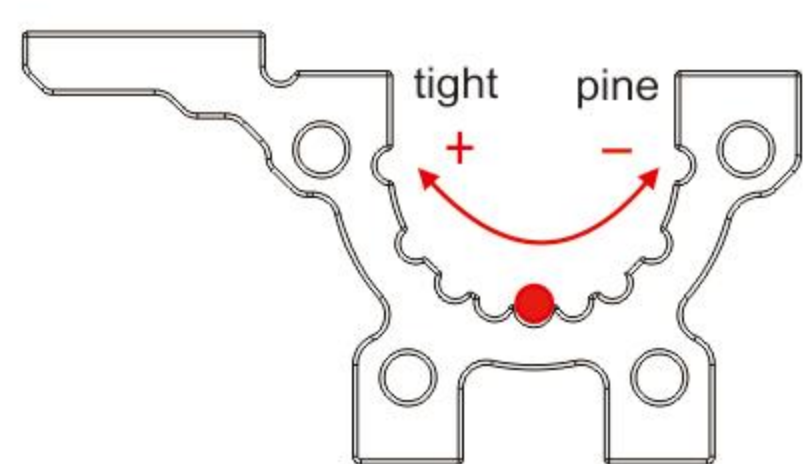

- 127118 SYNCHRONOUS BELT SHORT-189 63T
- 127151 SYNCHRONOUS BELT LENGTH-513 171T
- 125203 ALU. SPUR GEAR SHAFT MOUNT - MTS T3
- 121096 COMPOSITE ADJUSTMENT BALL-BEARING HUB
- 931015 BALL-BEARING 10X15X4



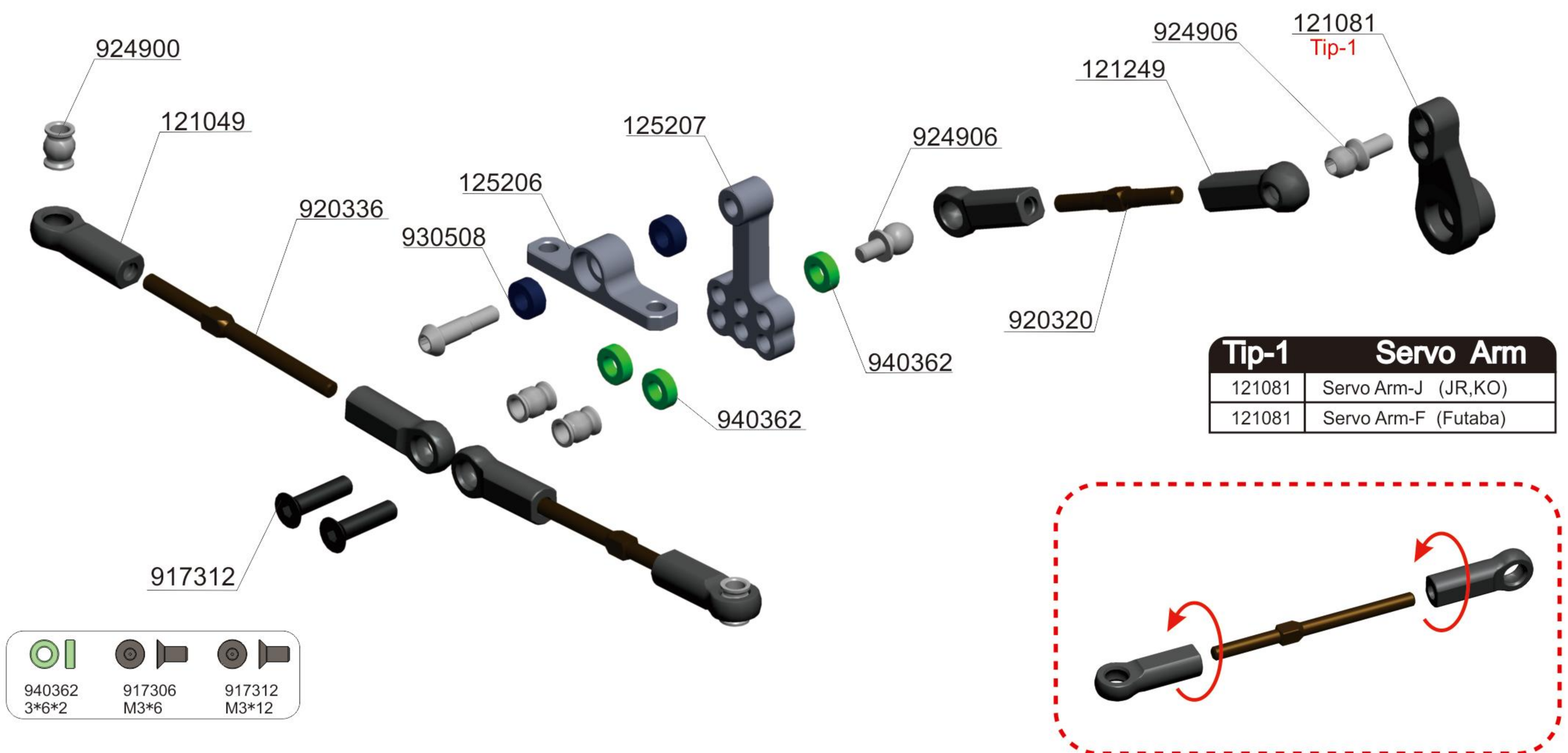

Tip-1 Servo Arm	
121081	Servo Arm-J (JR,KO)
121081	Servo Arm-F (Futaba)

- 121249 COMPOSITE BALL JOINT 4.9MM - CLOSED WITH HOLE  
 121049 COMPOSITE BALL JOINT 4.9MM - OPEN  
 121081 COMPOSITE SERVO HORN  
 125206 ALU. STEERING MOUNT HOLDER - MTS T3  
 125207 ALU. STEERING PLATE - MTS T3  
 123055 SPRING STEEL STEERING SHAFT - MTS T3

- 920336 ADJ. TURNBUCKLE L/R36 MM - SPRING STEEL  
 924900 PIVOT BALL 4.9\*6MM DOUBLE BEVEL SHOULDERS  
 920320 ADJ. TURNBUCKLE L/R 20 MM - SPRING STEEL  
 924906 BALL END 4.9MM WITH THREAD 6MM H2.0  
 930508 BALL-BEARING 5X8X2.5

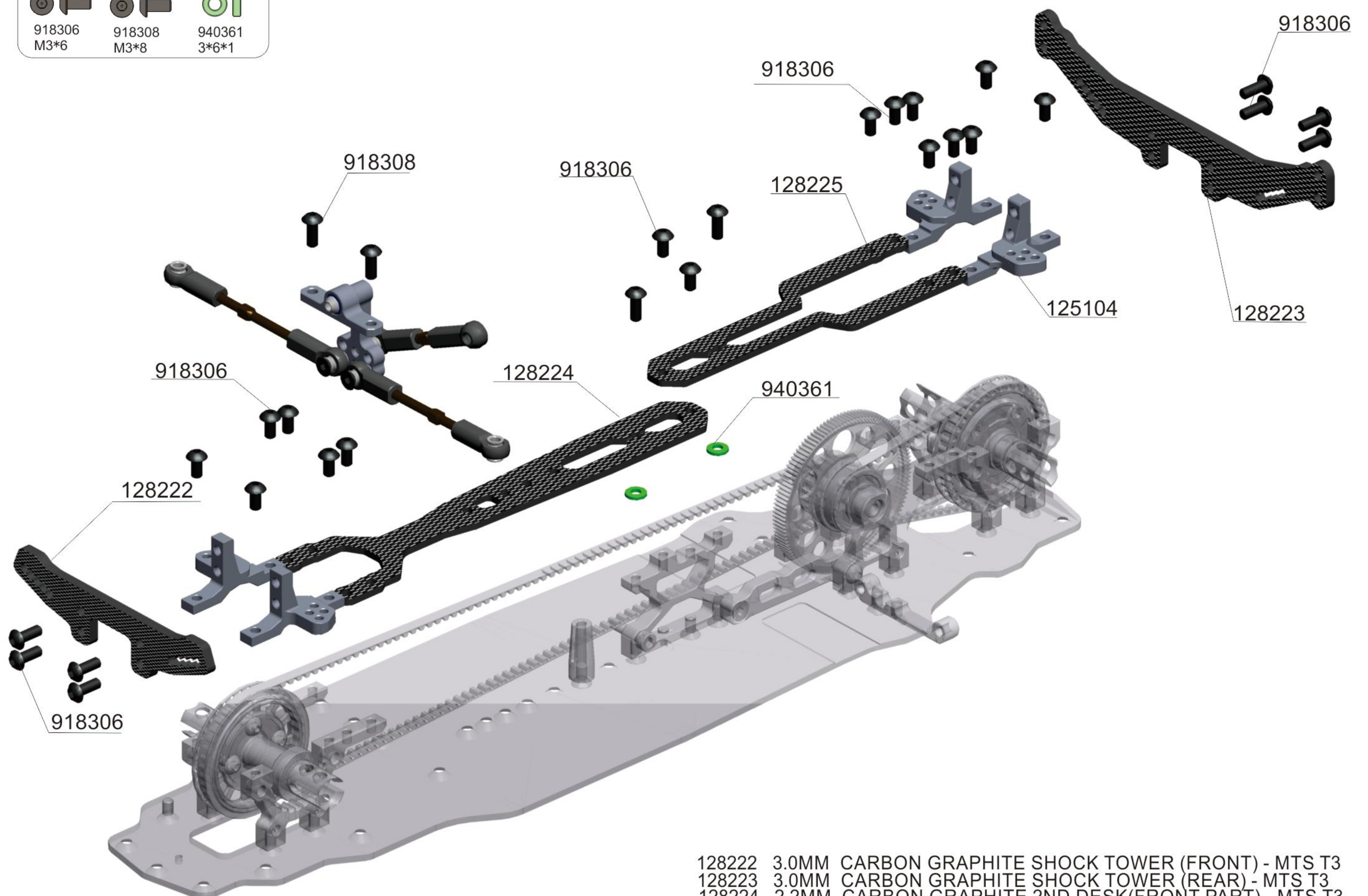

- 128222 3.0MM CARBON GRAPHITE SHOCK TOWER (FRONT) - MTS T3  
 128223 3.0MM CARBON GRAPHITE SHOCK TOWER (REAR) - MTS T3  
 128224 2.2MM CARBON GRAPHITE 2ND DESK(FRONT PART) - MTS T3  
 128225 2.2MM CARBON GRAPHITE 2ND DESK(REAR PART) - MTS T3  
 125104 REAR BEARING SLEEVE CLAMP (L+R, FF-V3)



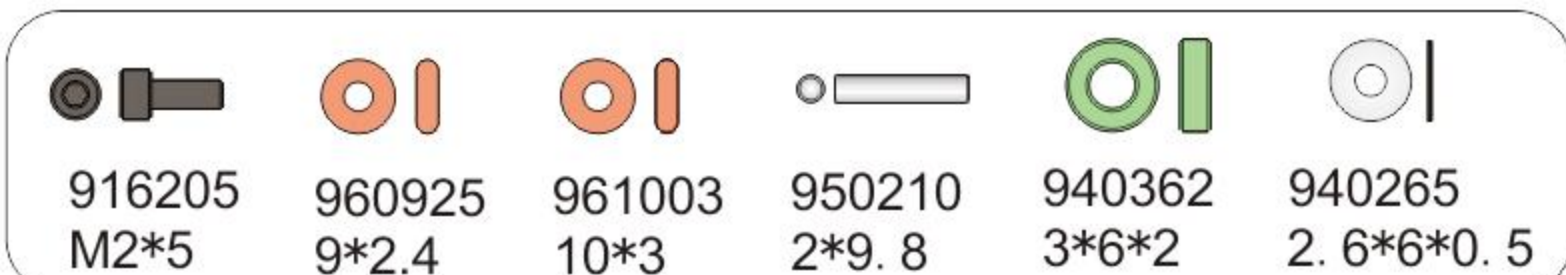

- 920324 ADJ. TURNBUCKLE L/R 24 mm - SPRING STEEL
- 924906 BALL END 4.9mm WITH THREAD 6mm H2.0
- 924908 BALL END 4.9mm WITH THREAD 8mm H2.0
- 930518 BALL-BEARING 5x8x2.5 FLANGED
- 930510 BALL-BEARING 5X10X4
- 930612 BALL-BEARING 6X12X4
- 931015 BALL-BEARING 10X15X4
- 950320 REAR UPRIGHT PIVOT PIN (3\*20)
- 950318 FRONT PIVOT PIN FOR C-HUB 3\*18

Tip-1	
123114	1.4
123116	1.6
123118	1.8
123120	2.0
123122	2.2

- 123116 ANTI ROLL BAR FEMALE SHAFT
- 123016 ANTI ROLL BAR MALE SHAFT
- 121032 COMPOSITE UPRIGHT REAR
- 125012 OPTION ALU WHEEL HUB
- 123704 STEERING BLOCK HOLDER (4DEG)
- 123037 SUSPENSION ARM BUSHING (4.9X6)
- 123052 SUSPENSION ARM TIGHTEN COLLAR (0.2)
- 123035 ARM DROOP SCREW BUSHING
- 123036 SUSPENSION ARM HOLDER WITH BALL END 4.9MM
- 120146 CVD DRIVE SHAFT SPRING STEEL-46mm 2.0PIN -S2
- 121249 COMPOSITE BALL JOINT 4.9MM - CLOSED WITH HOLE
- 121179 COMPOSITE STEERING BLOCK WITH BEARING HOLDER
- 118238 38MM UNIVERSAL DRIVE SHAFT COMPLETE SET (SPRING STEEL)- 3MM PIN

- 128151 2.2MM GRAPHITE FRONT ARM (L)
- 128152 2.2MM GRAPHITE FRONT ARM (R)
- 128153 2.2MM GRAPHITE REAR ARM (L)
- 128154 2.2MM GRAPHITE REAR ARM (R)
- 125451 ALU. FRONT ARM JOINT HOLDER (L)
- 125452 ALU. FRONT ARM JOINT HOLDER (R)
- 125453 ALU. REAR ARM JOINT HOLDER (L)
- 125454 ALU. REAR ARM JOINT HOLDER (R)
- 127004 SUSPENSION ARM SILICON O-RING (8X7.5X3)
- 127005 SUSPENSION ARM SILICON O-RING (9X8X3)

Tip-2	
123012	1.2
123014	1.4
123016	1.6
123018	1.8
123020	2.0

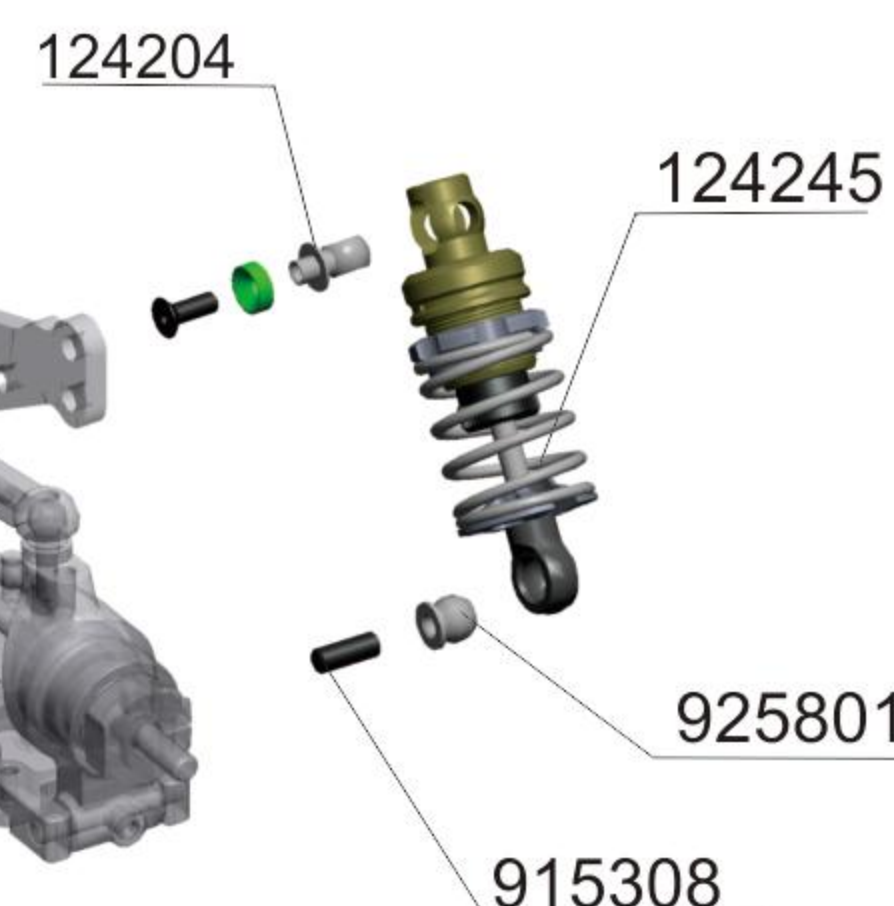
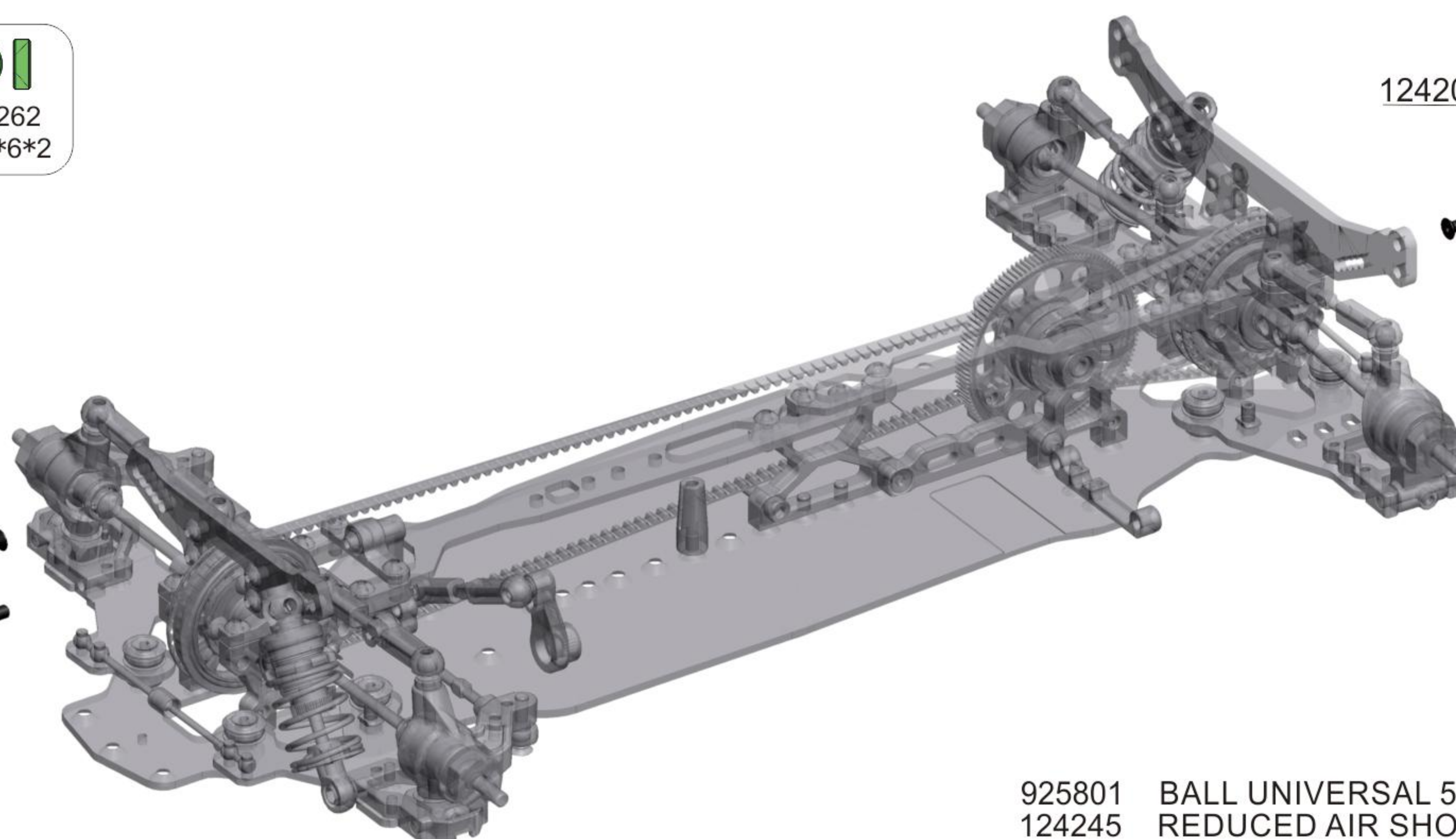
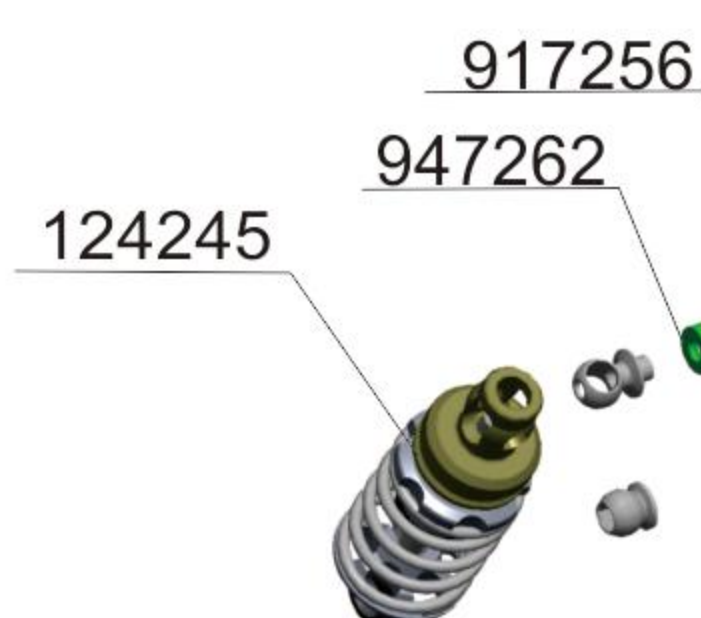

- 925801 BALL UNIVERSAL 5.8 MM HEX H3.0
- 124245 REDUCED AIR SHOCKER (45MM)
- 124204 RAS-SHOCK CAP BALL END 5.9 M2.5mm



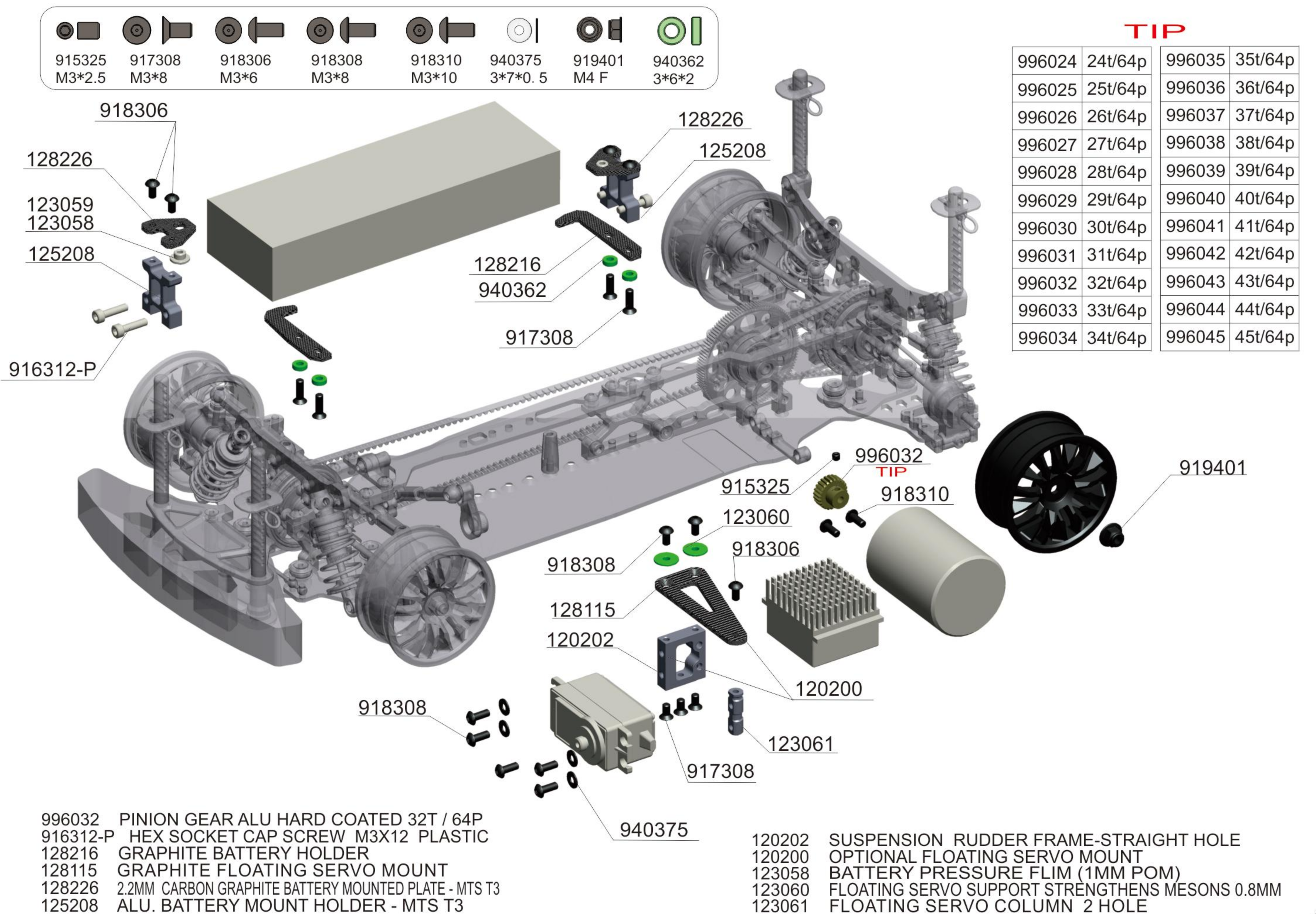
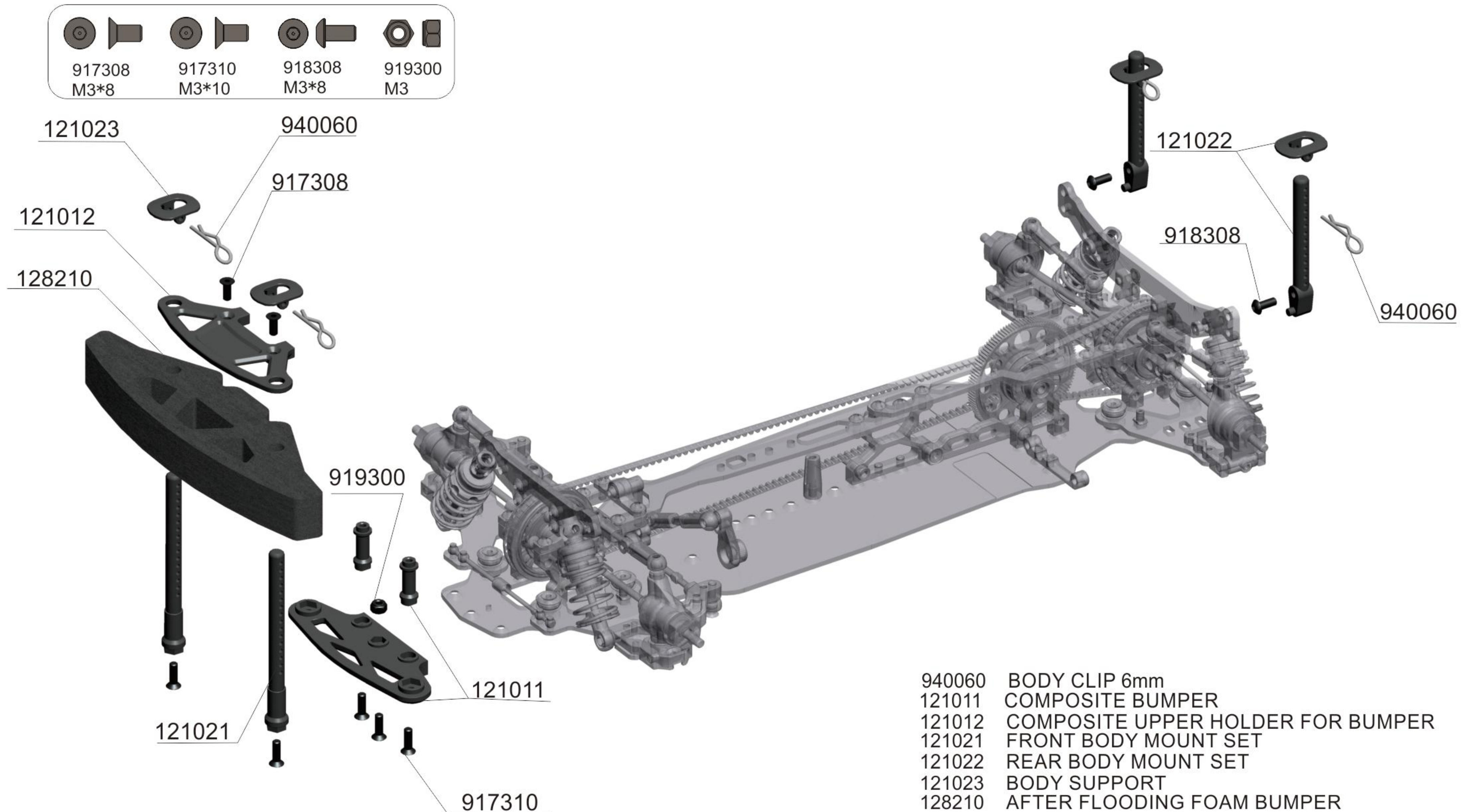



# 1/10 ELECTRIC TOURING CAR



<p>120146</p>  <p><b>RIGHT ANGLE</b> 46mm 2.0PIN-S2</p> <p><b>CVD DRIVE SHAFT SPRING STEEL</b></p>	<p>122146</p>  <p>46mm 2.0PIN-S2</p> <p><b>UNIVERSAL CVD DRIVE SHAFT-SPRING STEEL</b></p>	<p>122127</p>  <p><b>RIGHT ANGLE</b></p> <p><b>CVD AXLE SHAFT-STRAIGHT</b></p>	<p>122006</p>  <p><b>CVD JOINT PIECE</b></p>
<p>160247</p>  <p><b>RIGHT ANGLE</b> 47MM 3.0PIN-S2</p> <p><b>CVD DRIVE SHAFT SPRING STEEL</b></p>	<p>162147</p>  <p>47MM 3.0PIN</p> <p><b>UNIVERSAL CVD DRIVE SHAFT-SPRING STEEL 3.0PIN</b></p>	<p>112038 38MM 112040 40MM</p>  <p>3PIN</p> <p><b>UNIVERSAL DRIVE SHAFT(Spring Steel)</b></p>	<p>112039</p>  <p>40MM 2PIN</p> <p><b>UNIVERSAL DRIVE SHAFT(Spring Steel)</b></p>
<p>115910</p>  <p><b>UNIVERSAL DRIVE SHAFT JOINT HOUSING (SPRING STEEL)</b></p>	<p>115531</p>  <p><b>UNIVERSAL DRIVE SHAFT AXLE (SPRING STEEL)</b></p>	<p>115405</p>  <p>6*4 1.5HOLE</p> <p><b>UNIVERSAL DRIVE SHAFT CROSS JOINT</b></p>	<p>150410</p>  <p><b>UNIVERSAL DRIVE SHAFT JOINT HOUSING C-CLIP</b></p>
<p>118238 38MM 118240 40MM</p>  <p>3 PIN</p> <p><b>UNIVERSAL DRIVE SHAFT COMPLETE SET(Spring Steel)</b></p>	<p>118239</p>  <p>40MM 2PIN</p> <p><b>UNIVERSAL DRIVE SHAFT COMPLETE SET(Spring Steel)</b></p>	<p>124236 12*45MM 124236 12*49MM 124236 12*57MM</p>  <p><b>REDUCED AIR SHOCKER</b></p>	<p>124236</p>  <p>3*36MM</p> <p><b>RAS-SHOCK SHAFT</b></p>
<p>124316</p>  <p>12MM*16MM</p> <p><b>RAS-SHOCK BODY</b></p>	<p>124239 3*40MM 124247 3*48MM</p>  <p><b>RAS-SHOCK SHAFT</b></p>	<p>124318 12*18MM 124322 12*22MM</p>  <p><b>RAS-SHOCK BODY</b></p>	<p>121058</p>  <p>12MM</p> <p><b>SHOCK BALL JOINT</b></p>
<p>124003</p>  <p>12MM</p> <p><b>SUSPENSION SPRING RETAINER</b></p>	<p>125029</p>  <p><b>ALU SHOCK BOTTOM CAP</b></p>	<p>124012</p>  <p><b>ALU SHOCK SPRING RETAINING COLLAR -STANDARD</b></p>	<p>124013 -1MM 124014 -3MM</p>  <p><b>ALU SHOCK SPRING RETAINING COLLAR LOW GRAVITY</b></p>



# 1/10 ELECTRIC TOURING CAR



<p>124430</p> <p>WITHOUT HOLE</p> <p><b>RAS-SHOCK PISTON</b></p>	<p>124431</p> <p>1 HOLE</p> <p><b>RAS-SHOCK PISTON</b></p>	<p>124432</p> <p>2 HOLE</p> <p><b>RAS-SHOCK PISTON</b></p>	<p>124433</p> <p>3 HOLE</p> <p><b>RAS-SHOCK PISTON</b></p>
<p>124201</p> <p><b>RAS- SHOCK CAP</b></p>	<p>124501</p> <p><b>RAS-SHOCK HOLDER TOOL</b></p>	<p>124402</p> <p><b>RAS-SHOCK TOP COVER</b></p>	<p>124403</p> <p>3.7*3.0</p> <p><b>RAS-SHOCK BOTTOM COVER</b></p>
<p>124204</p> <p><b>RAS-SHOCK CAP BALL END</b></p>	<p>124211 5.9*7MM 124311 5.9*10MM 124411 5.9*12MM</p> <p><b>RAS-SHOCK CAP BALL END</b></p>	<p>129250 1.2 * 21 * 5.0 RD 2.0KG 129255 1.2 * 21 * 5.5 SR 1.8KG 129260 1.2 * 21 * 6.0 YE 1.6KG 129265 1.2 * 21 * 6.5 BL 1.4KG</p> <p><b>SUSPENSION SPRING</b></p>	<p>129450 1.4 * 21 * 5.0 RD 3.5KG 129455 1.4 * 21 * 5.5 SR 3.0KG 129460 1.4 * 21 * 6.0 YE 2.5KG 129465 1.4 * 21 * 6.5 BL 2.0KG</p> <p><b>SUSPENSION SPRING</b></p>
<p>129550 1.5 * 21 * 5.0 RD 4.5KG 129555 1.5 * 21 * 5.5 GN 4.0KG 129560 1.5 * 21 * 6.0 YE 3.5KG 129565 1.5 * 21 * 6.5 BL 3.0KG</p> <p><b>SUSPENSION SPRING</b></p>	<p>121011</p> <p><b>COMPOSITE BUMPER</b></p>	<p>121012</p> <p><b>COMPOSITE UPPER HOLDER FOR BUMPER</b></p>	<p>121021</p> <p><b>FRONT BODY MOUNT SET</b></p>
<p>121022</p> <p><b>REAR BODY MOUNT SET</b></p>	<p>121023</p> <p><b>BODY SUPPORT</b></p>	<p>121032</p> <p><b>COMPOSITE UPRIGHT REAR</b></p>	<p>121049</p> <p><b>COMPOSITE BALL JOINT 4.9MM - OPEN</b></p>
<p>121063</p> <p>38T</p> <p><b>TIMING BELT PULLEY</b></p>	<p>121065-WH</p> <p>20T POM</p> <p><b>FIXED PULLEY</b></p>	<p>121065</p> <p>20T</p> <p><b>FIXED PULLEY</b></p>	<p>121067</p> <p>38T</p> <p><b>COMPOSITE GEAR DIFF. CASE &amp; COVER</b></p>



# 1/10 ELECTRIC TOURING CAR



121068-WH

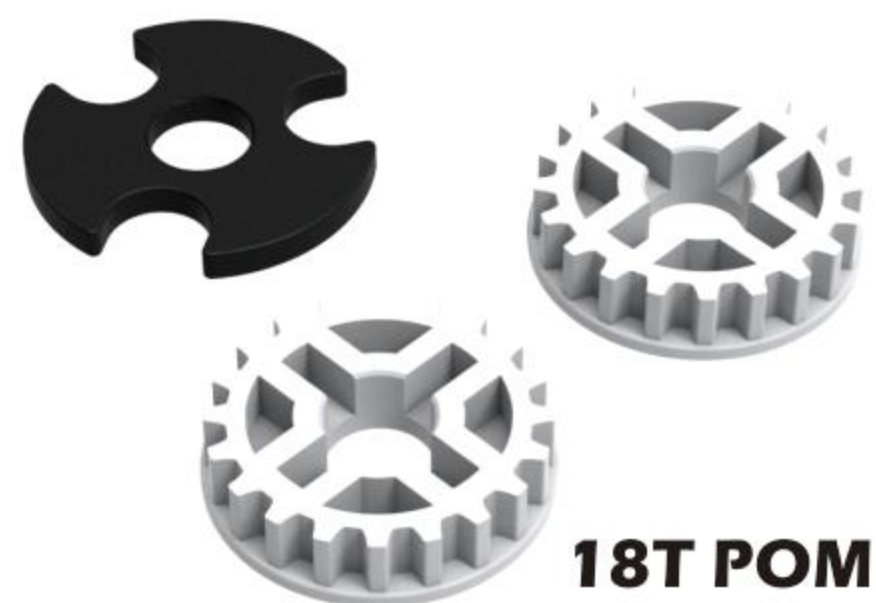

18T POM

**FIXED PULLEY**

121068



18T

**FIXED PULLEY**

121081



**COMPOSITE SERVO HORN**

121095



**COMPOSITE SERVO MOUNT SET**

121096



**COMPOSITE ADJUSTMENT BALL-BEARING HUB**

121099



**DRIVE SHAFT REPLACEMENT PLASTIC CAP**

121175

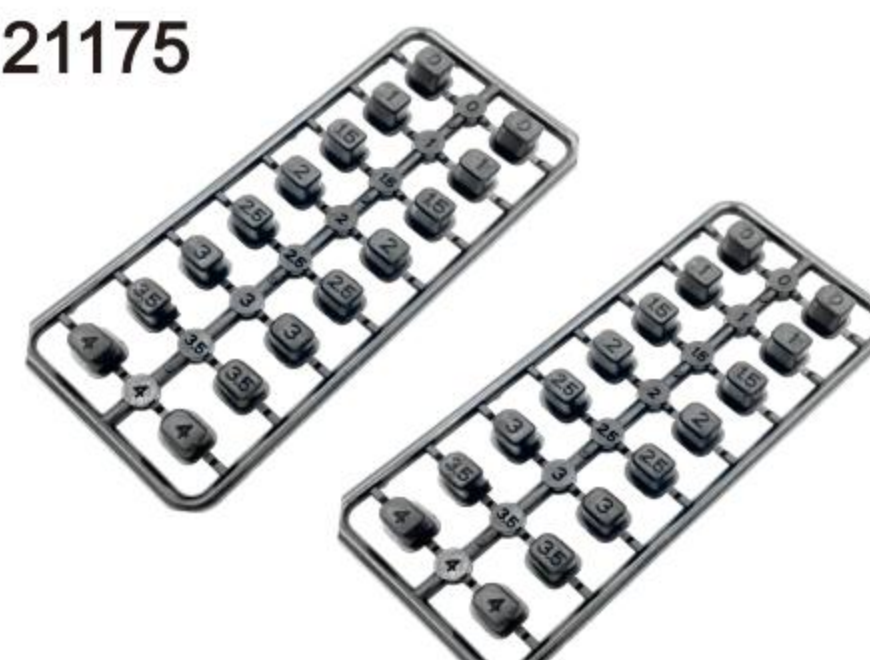

**SUSPENSION MOUNT INSERT**

121179



**COMPOSITE STEERING BLOCK WITH BEARING HOLDER**

994072 72T/48P  
994084 84T/48P  
994084-WH 84T/48P  
994087 87T/48P  
994087-WH 87T/48P



**SPUR GEAR**

996110 110T/64P  
996110-WH 110T/64P  
996116 110T/64P  
996116-WH 110T/64P



**SPUR GEAR**

120200



**OPTIONAL FLOATING SERVO MOUNT**

120202

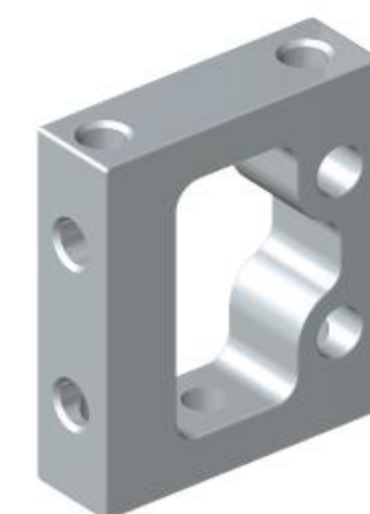

**SUSPENSION RUDDER FRAME-STRAIGHT**

121113



S2 3.6

**OPTIONAL GEAR DIFFERENTIAL-SET-METAL GEAR**

121114



S2 3.6

**OPTIONAL GEAR DIFFERENTIAL-PLASTIC SET**

161112



METAL GEAR S2 3.1

**OPTIONAL GEAR DIFFERENTIAL - SET**

161113



S2 3.1

**GEAR DIFFERENTIAL - SET**

990111



**PLANETARY GEAR SET - HARD COATED**

990110



**PLANETARY GEAR SET - PLASTIC**

123005

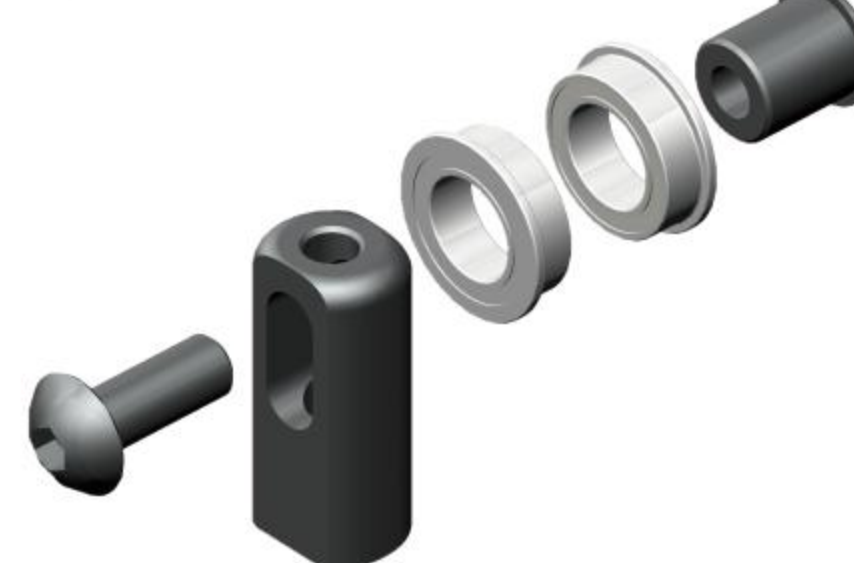

**BELT TENSIONER SET**

123011



3.6 S2

**UNIVERSAL CVD DRIVE SHAFT - SPRING STEEL**

163131



3.1 S2

**FRONT SOLID AXLE SPOOL OUTDRIVE-SPRING STEEL**

160131

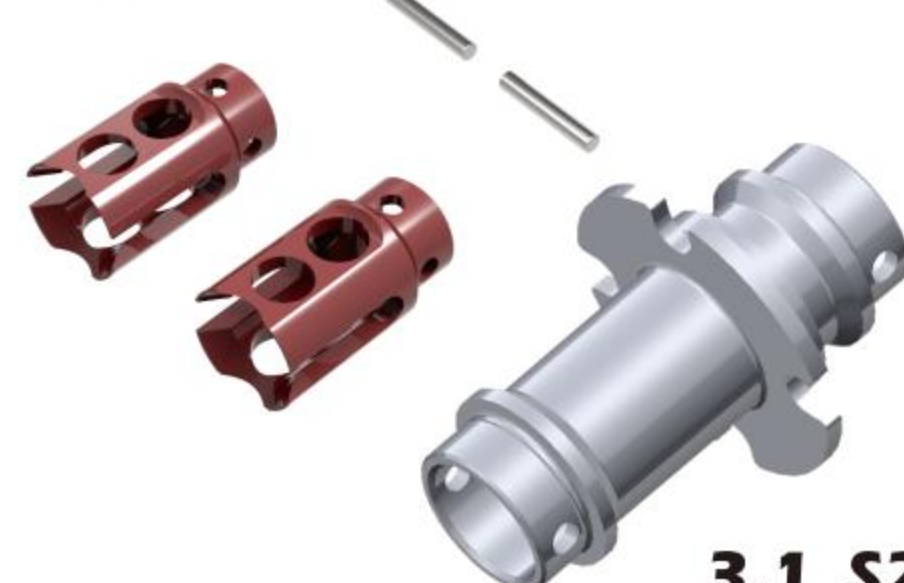

3.1 S2

**FRONT SOLID AXLE SET-SPRING STEEL**

163130



3.1 S2

**UNIVERSAL CVD DRIVE SHAFT-SPRING STEEL**

123035



**ARM DROOP SCREW BUSHING**



# 1/10 ELECTRIC TOURING CAR



123036



SUSPENSION ARM HOLDER WITH BALL END 4.9MM

123037



4.9X6

SUSPENSION ARM BUSHING

123050 0  
123052 0.2  
123054 0.4



SUSPENSION ARM TIGHTEN COLLAR

123012 1.2  
123014 1.4  
123016 1.6  
123018 1.8  
123020 2.0



ANTI ROLL BAR MALE SHAFT

123114 1.4  
123116 1.6  
123118 1.8  
123120 2.0  
123122 2.2



ANTI ROLL BAR FEMALE SHAFT

123221



ANTI ROLL BAR MALE SHAFT (COMPLETE SET)

123222

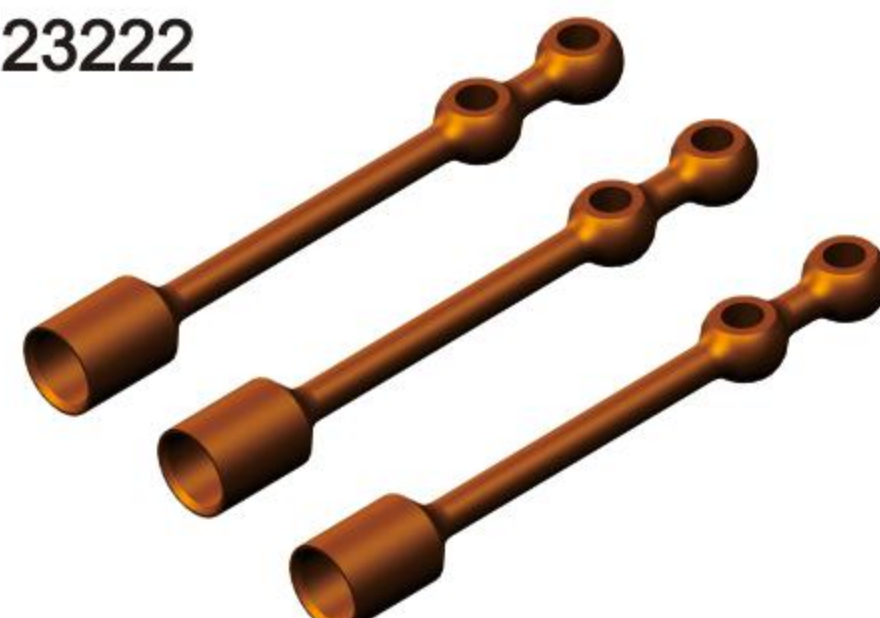

ANTI ROLL BAR FEMALE SHAFT HOLDER (COMPLETE SET)

123223

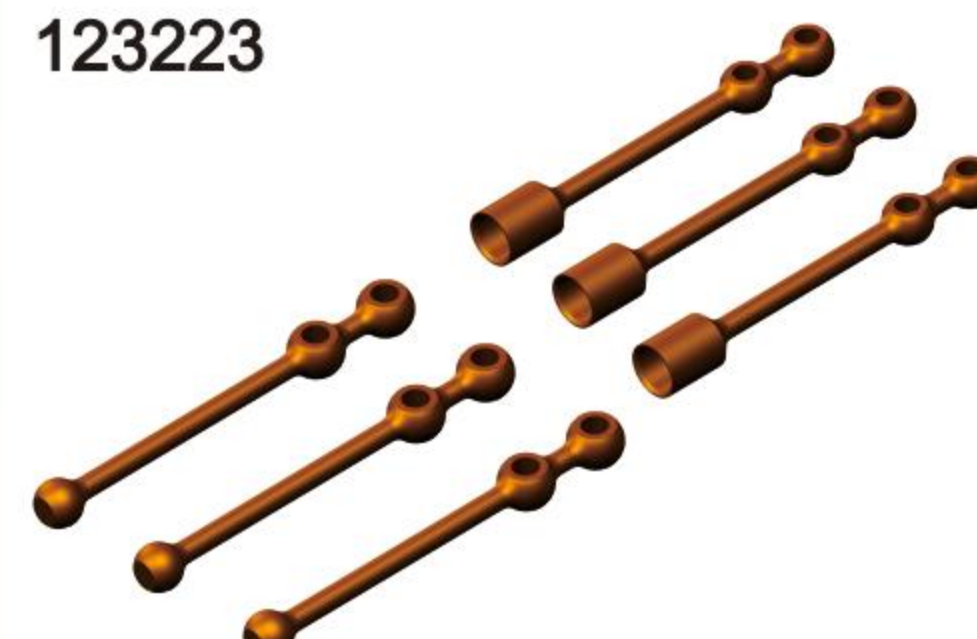

ANTI ROLL BAR MALE & FEMALE SHAFT (COMPLETE SET)

123702



2DEG

STEERING BLOCK HOLDER

123704



4DEG

STEERING BLOCK HOLDER

123706



6DEG

STEERING BLOCK HOLDER

125104

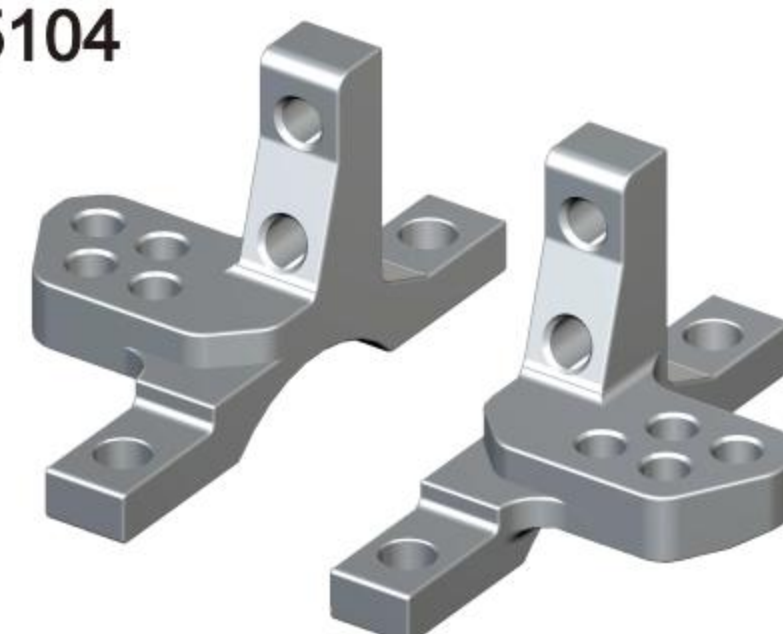

REAR BEARING SLEEVE CLAMP (L+R, FF-V3)

125012

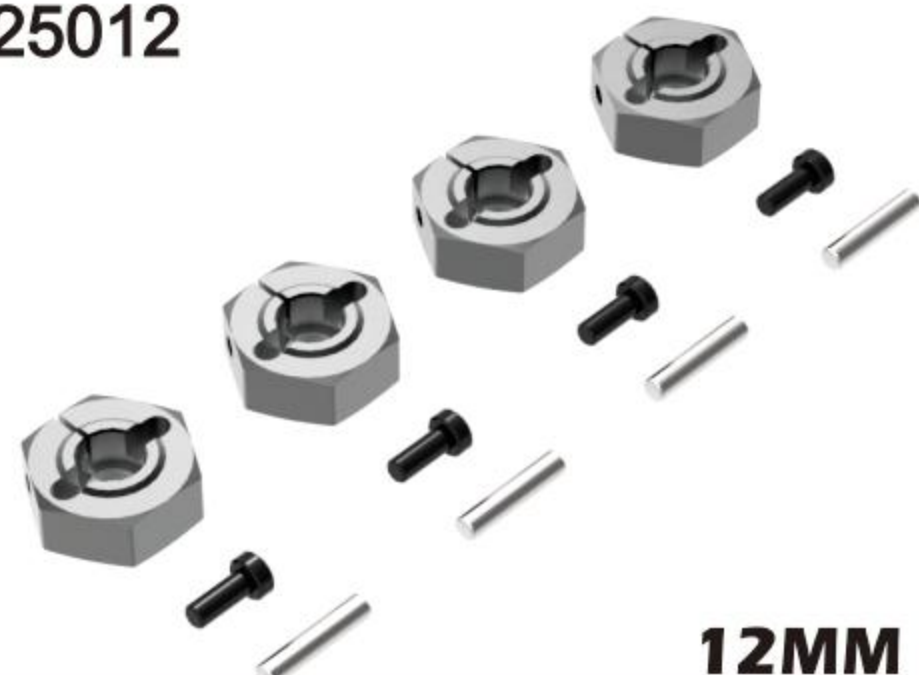

12MM

OPTION ALU WHEEL HUB

125317

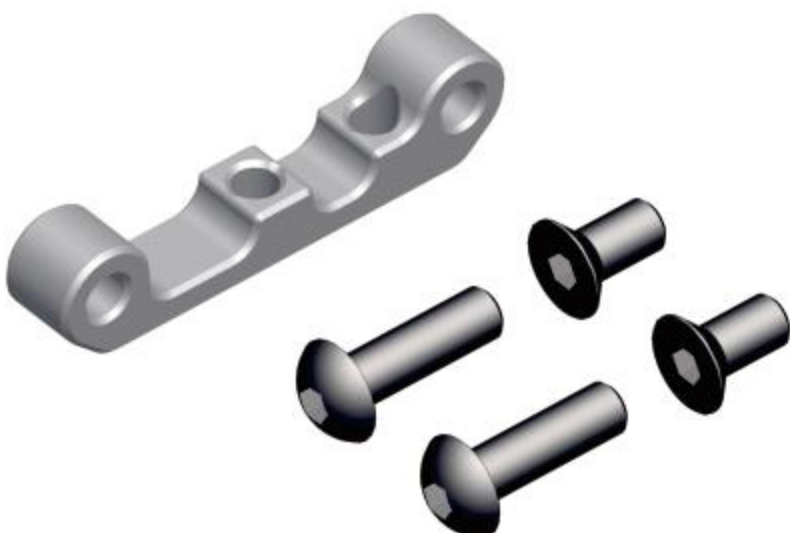

30MM

FAN MOUNT

125418

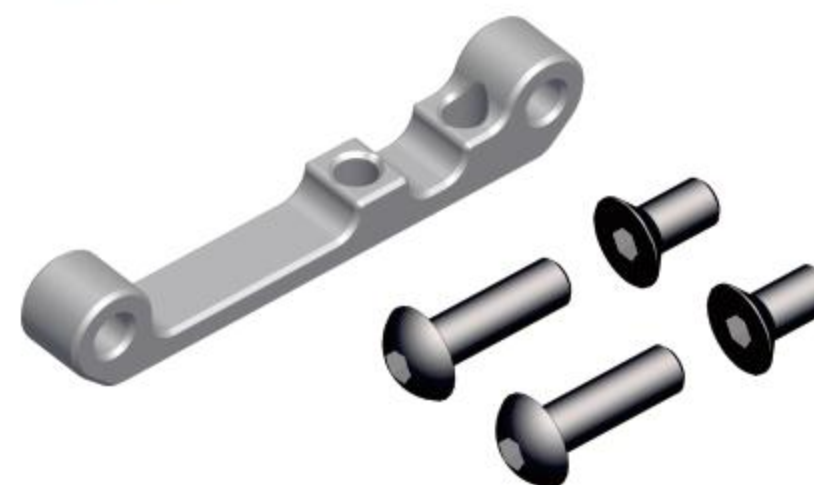

40MM

FAN MOUNT

128202

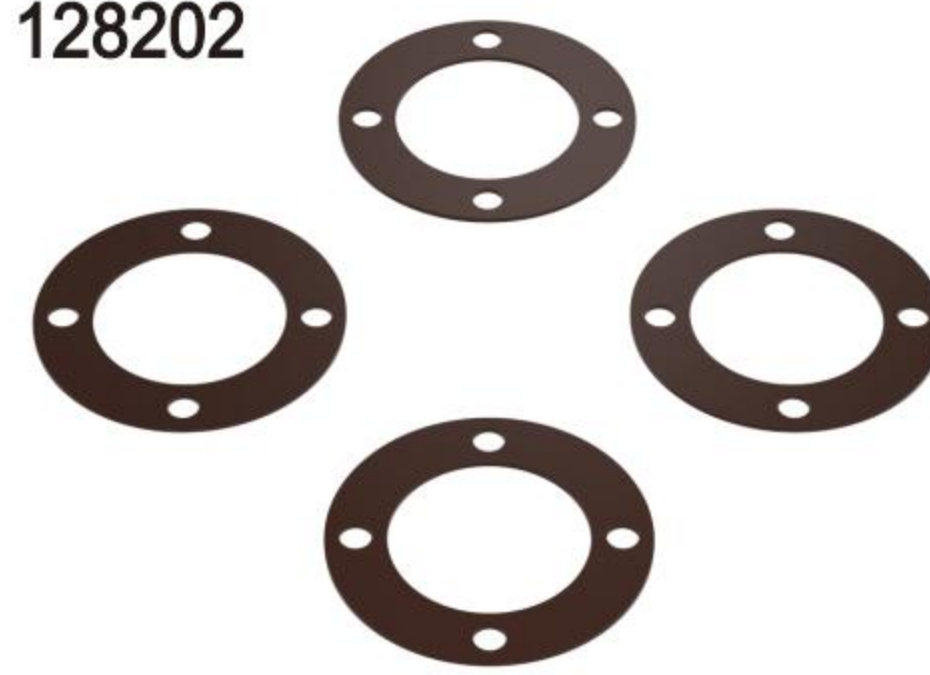

DIFF GASKET

127018

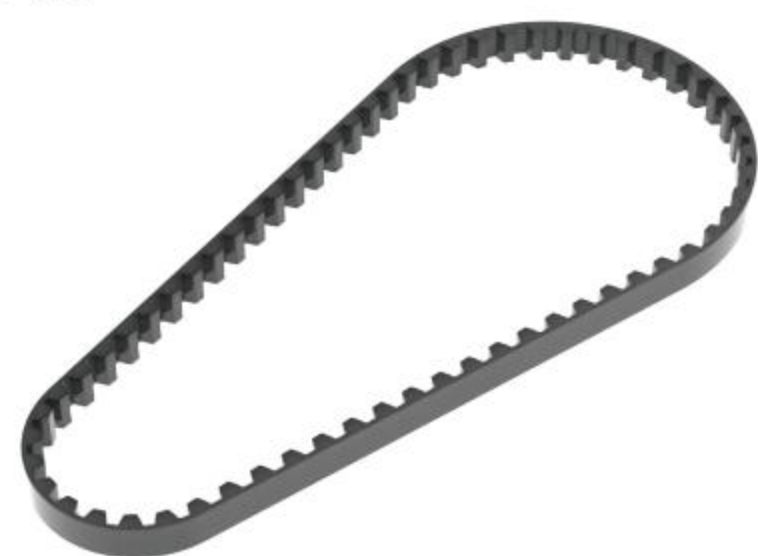

SYNCHRONOUS BELT SHORT-189 63T

127051



SYNCHRONOUS BELT LENGTH-513 171T

127118

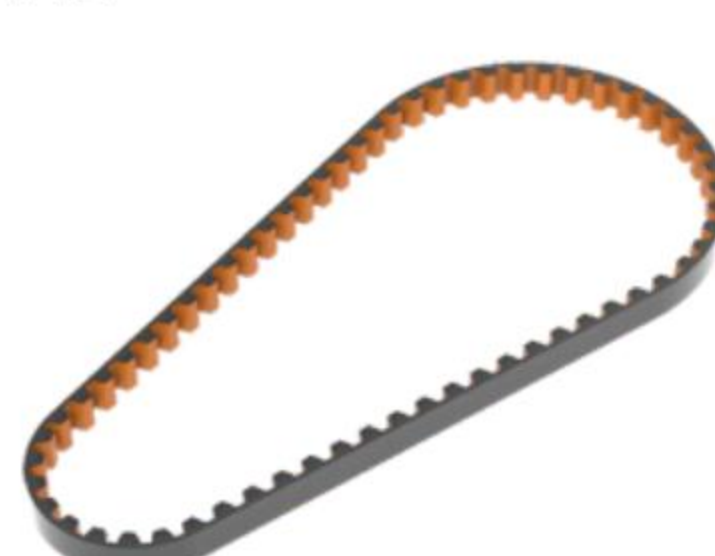

SYNCHRONOUS BELT SHORT-FIBRE-189 63T

127151



SYNCHRONOUS BELT LONG-FIBRE-513 171T

127218

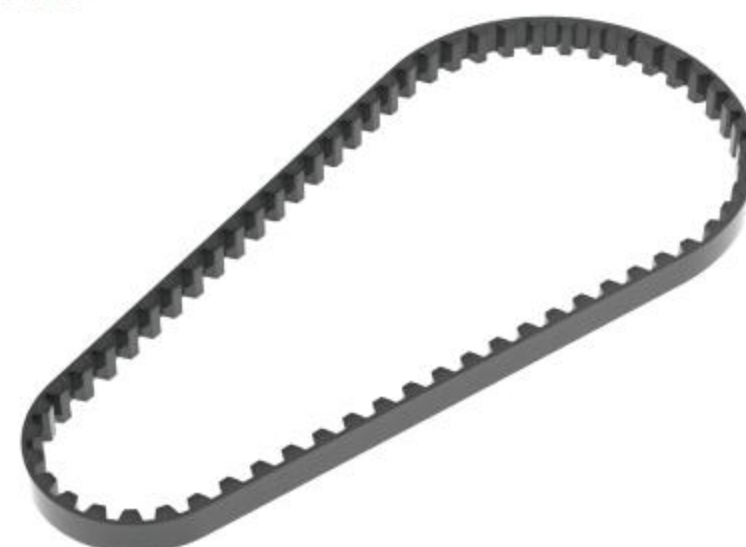

SYNCHRONOUS BELT SHORT-PU KEVLAR-189 63T

127251



SYNCHRONOUS BELT LONG-PU KEVLAR-513 171T

920318 18MM  
920320 20MM  
920322 22MM  
920324 24MM  
920328 28MM  
920332 32MM  
920336 36MM  
920340 40MM  
920345 45MM



S2

ADJ. TURNBUCKLE L SPRING STEEL

924900



PIVOT BALL 4.9 MM DOUBLE BEVEL SHOULDERS



# 1/10 ELECTRIC TOURING CAR



924904



4.9\*4MM

BALL END 4.9MM WITH THREAD 4MM H2.0

924906



4.9\*6MM

BALL END 4.9MM WITH THREAD 6MM H2.0

924908



4.9\*8MM

BALL END 4.9MM WITH THREAD 8MM H2.0

924910



4.9\*10MM

BALL END 4.9MM WITH THREAD 10MM H2.0

925800



5.8

BALL UNIVERSAL 5.8MM HEX

925801



5.8 H3.0

BALL UNIVERSAL 5.8MM HEX

925806



5.8\*6MM

BALL END 5.8MM WITH THREAD

925808



5.8\*8MM

BALL END 5.8MM WITH THREAD

940060

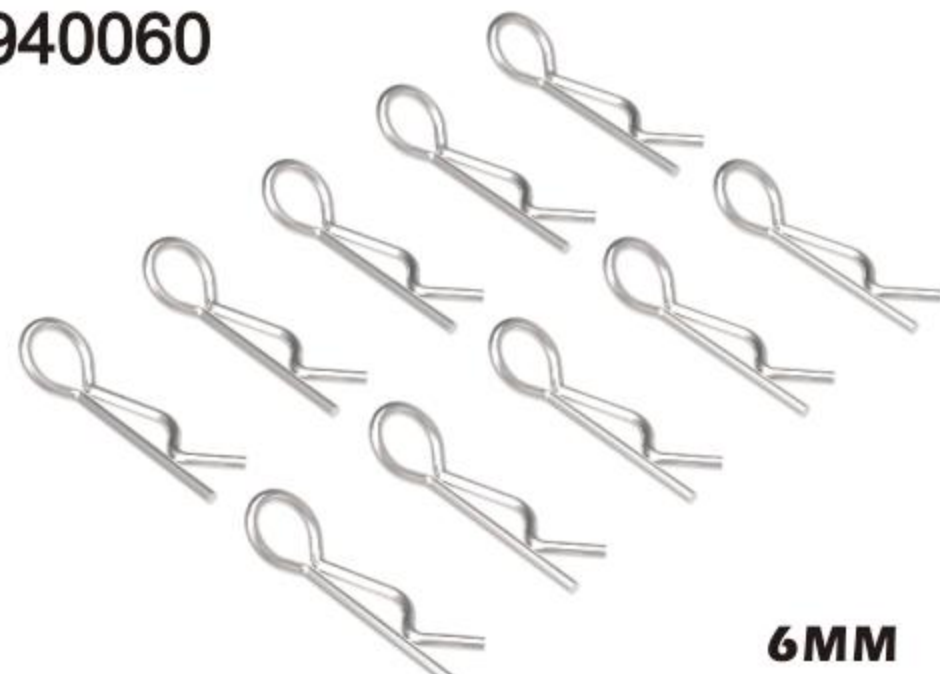

6MM

BODY CLIP

940100

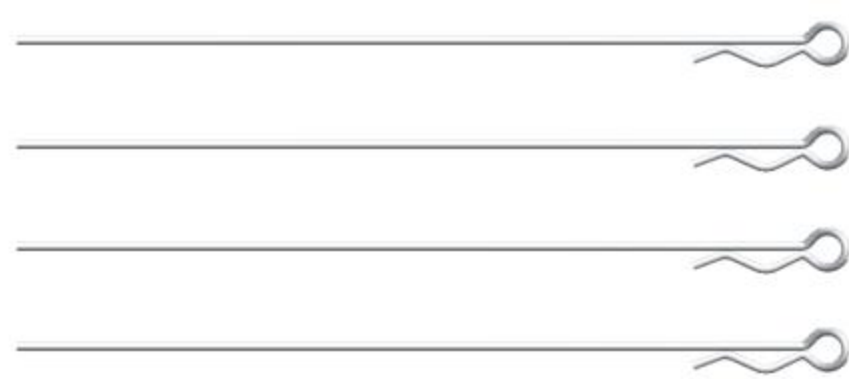

6mm

LONG BODY CLIP

950318

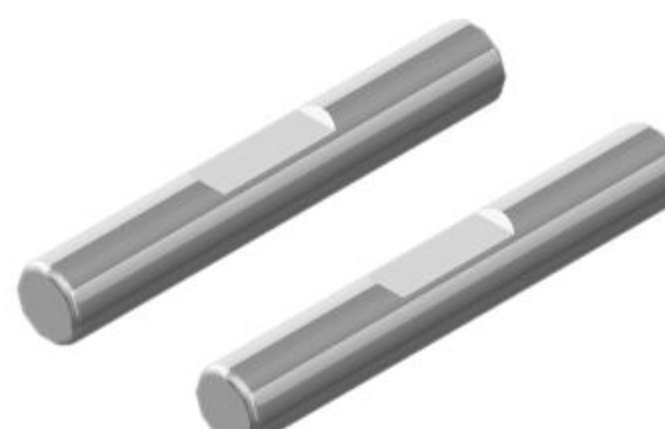

3X18MM

FRONT PIVOT PIN FOR C-HUB

950320

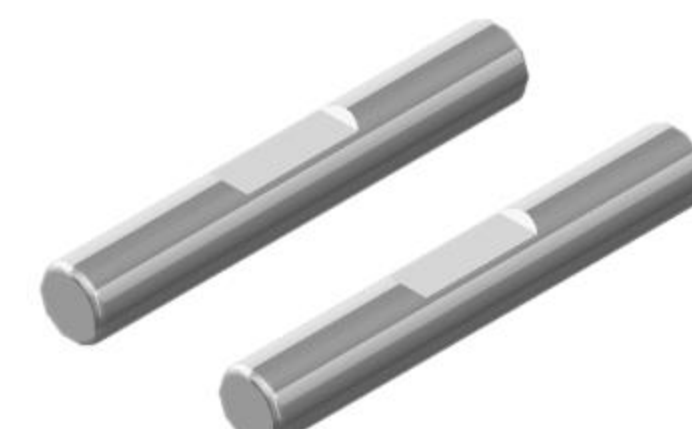

3X20MM

REAR UPRIGHT PIVOT PIN

127611



SLICK TYRE

127612 TYRE  
127624 24 DEGREE  
127628 28 DEGREE  
127632 32 DEGREE  
127636 36 DEGREE  
127640 40 DEGREE



SLICK TYRE

127601



PU INSERT(SOFF)

127602



PU INSERT (HARD)

121601



WHEEL RIM

121602



WHEELS RIM

127661



THREADED TYRE SET

127662



SLICK TYRE SET

127663



SLICK TYRE SET

128115



CARBON FIBER

GRAPHITE FLOATING SERVO MOUNT

123031

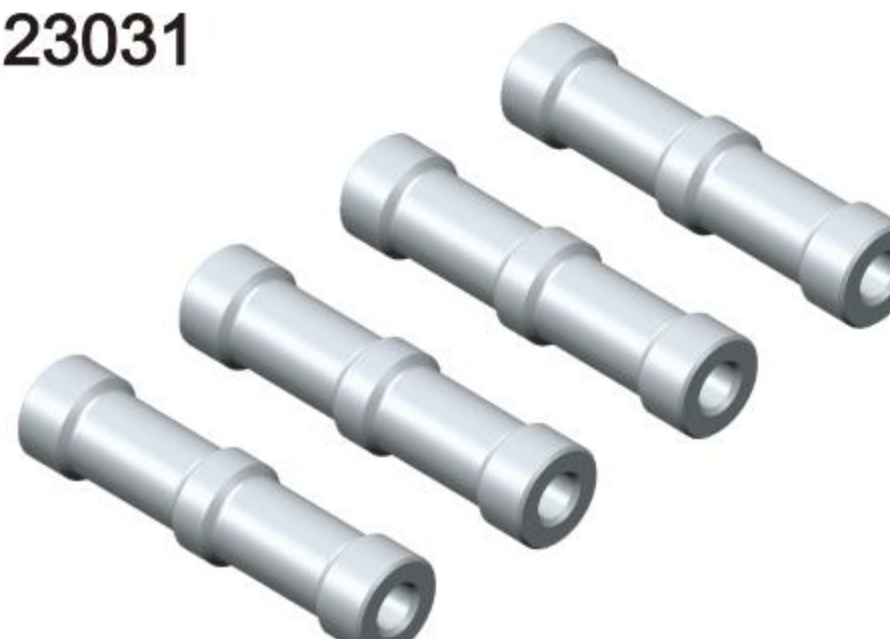

ALU.CHASSIS STANDOFF POST

128216



GRAPHITE BATTERY HOLDER



# 1/10 ELECTRIC TOURING CAR



125201

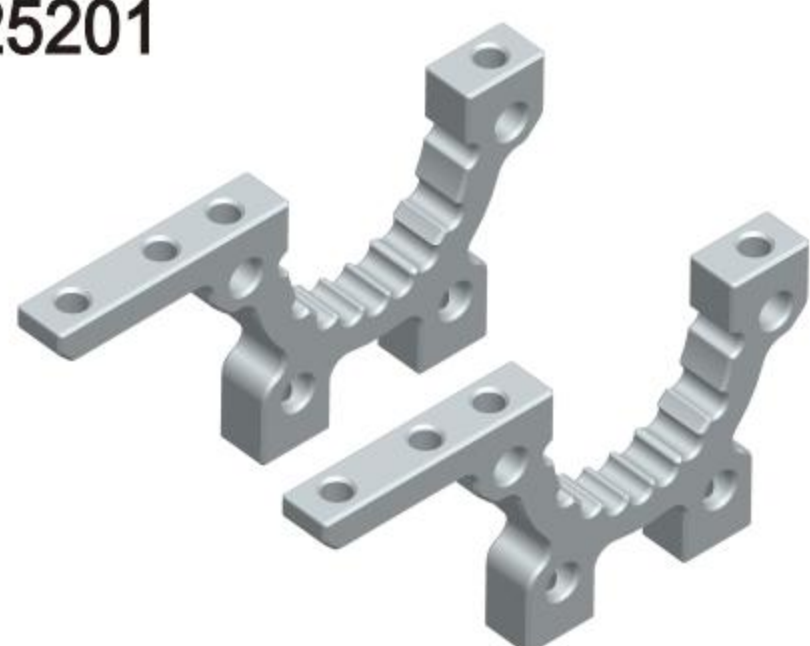

ALU. FRONT BULKHEAD - MTS T3

125202

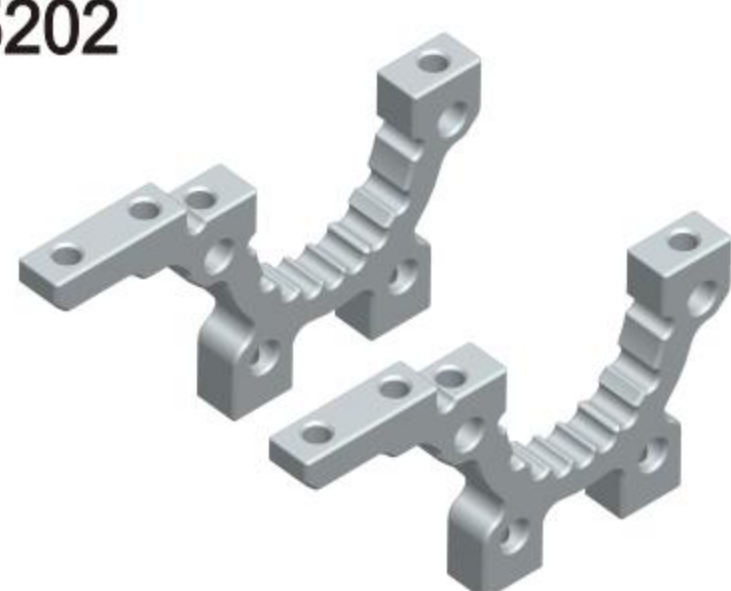

ALU. REAR BULKHEAD - MTS T3

125203

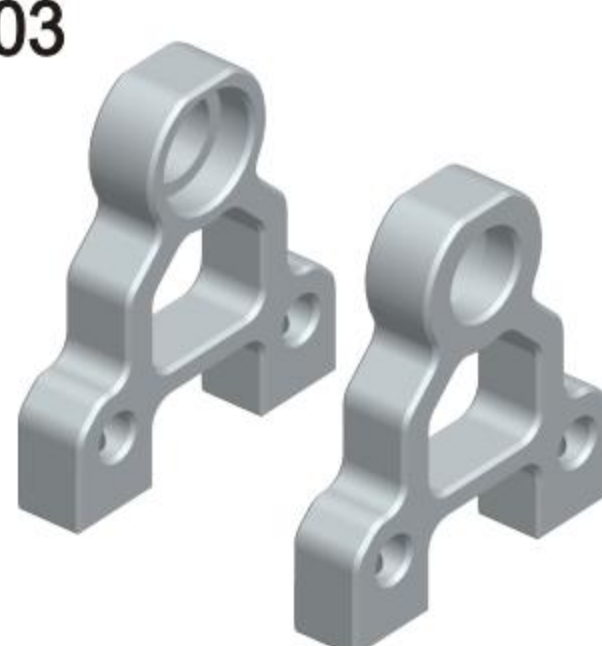

ALU. SPUR GEAR SHAFT MOUNT - MTS T3

125204



ALU. CENTER MOUNT - MTS T3

125205



ALU. MOTOR MOUNT - MTS T3

125206

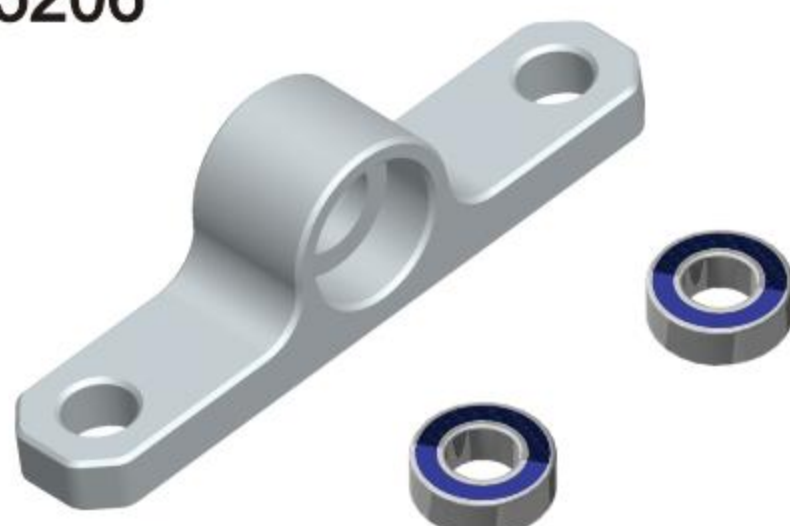

ALU. STEERING MOUNT HOLDER - MTS T3

125207



ALU. STEERING PLATE - MTS T3

125208

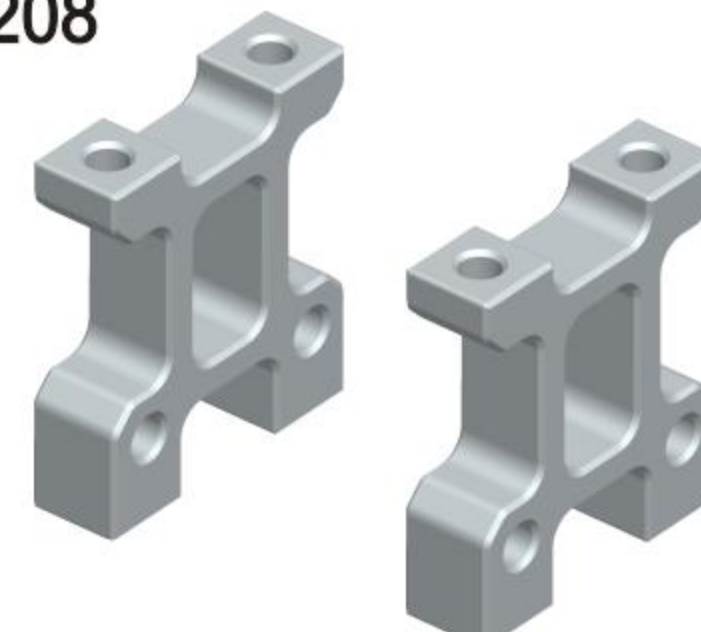

ALU. BATTERY MOUNT HOLDER - MTS T3

123055



SPRING STEEL STEERING SHAFT - MTS T3

123058 1.0MM 25H BATTERIES  
123059 2.5MM 23.8H BATTERIES

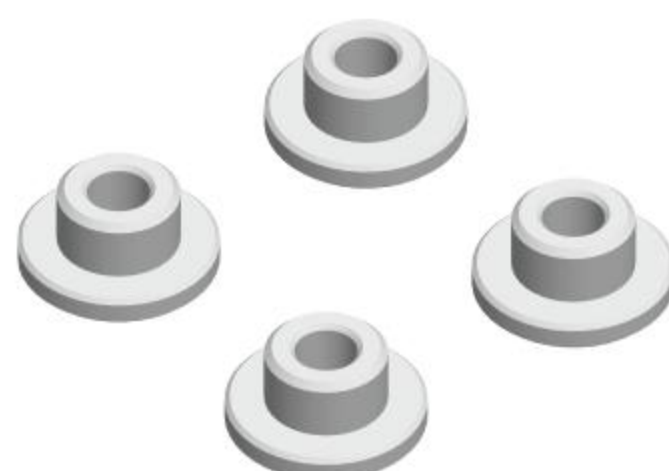

POM

BATTERY PRESSURE SHIM

123060

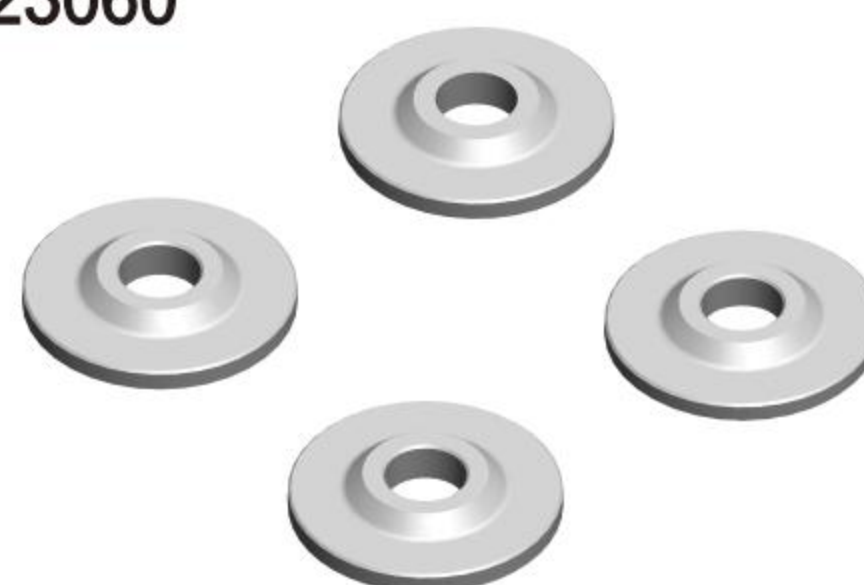

FLOATING SERVO SUPPORT STRENGTHENS MESONS 0.8MM

123061



FLOATING SERVO COLUMN 2 HOLE

125451



FL

ALU. FRONT ARM JOINT HOLDER

125452



FR

ALU. FRONT ARM JOINT HOLDER

125453



RL

ALU. REAR ARM JOINT HOLDER

125454



RR

ALU. REAR ARM JOINT HOLDER

960925 9\*2.4  
961003 10\*3

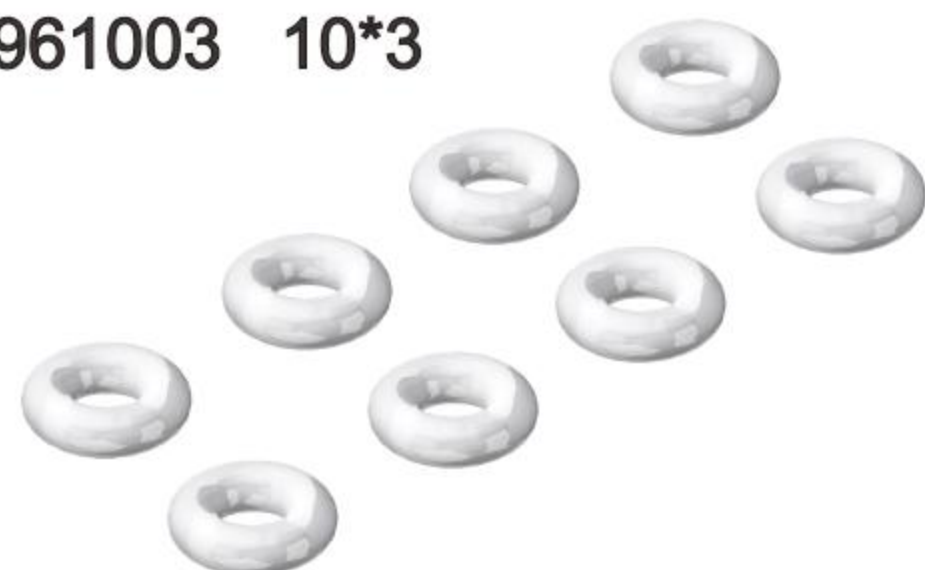

SILICON O-RING

127004 8X7.5X3  
127005 9X8X3



SUSPENSION ARM SILICON O-RING

127006 5X2.5X5  
127007 5X2.5X5.5



RAS SHOCK REBOUND O-RING

128151



CARBON FIBER FL

2.2MM CARBON FIBER FRONT ARM

128152



CARBON FIBER FR

2.2MM CARBON FIBER FRONT ARM

128153



CARBON FIBER RL

2.2MM CARBON FIBER REAR ARM

128154

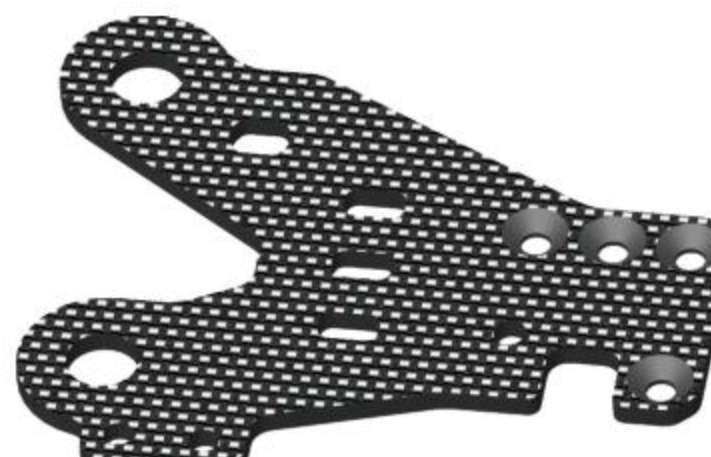

CARBON FIBER RR

2.2MM CARBON FIBER REAR ARM

128220

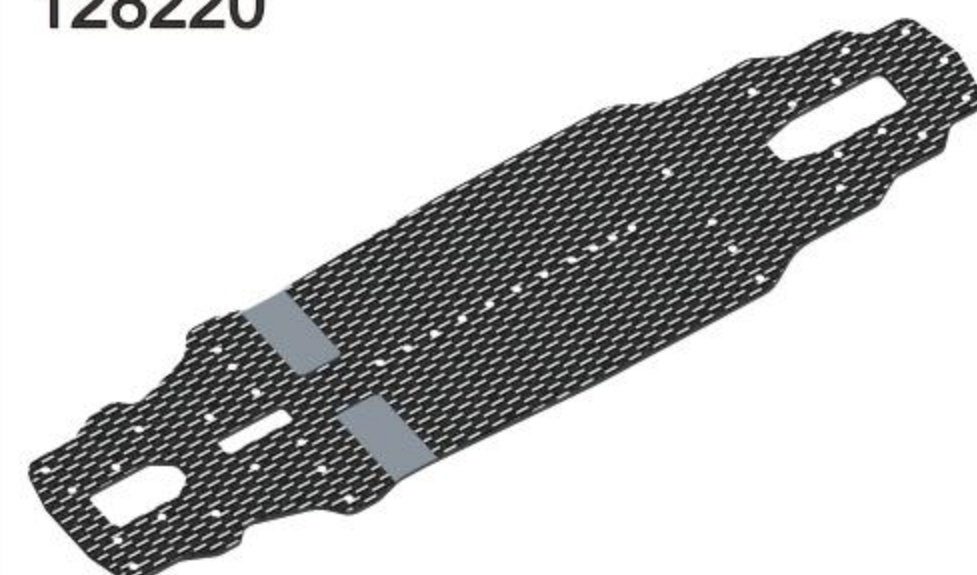

2.0MM CARBON GRAPHITE CHASSIS - MTS T3



# 1/10 ELECTRIC TOURING CAR



128221

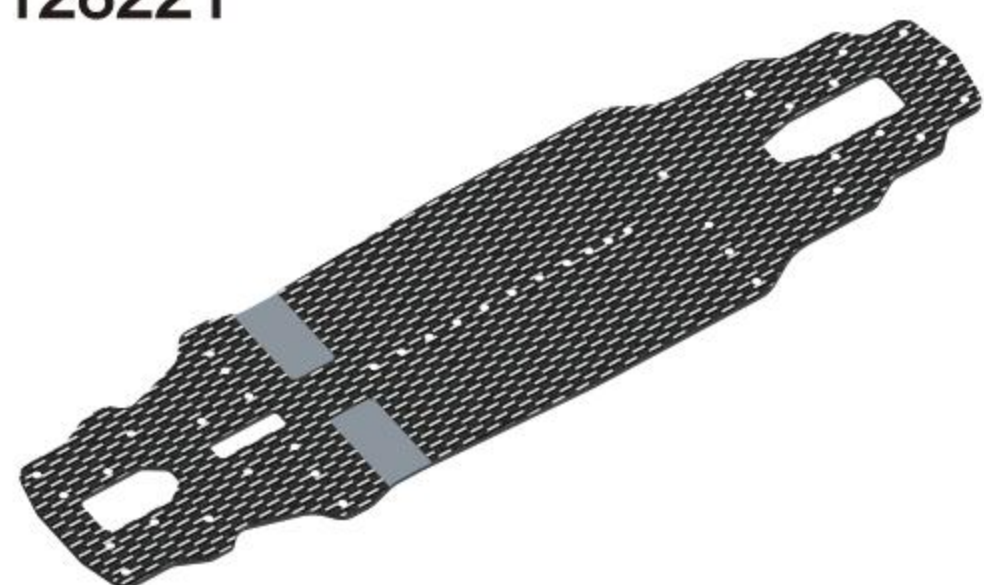

2.2MM CARBON GRAPHITE CHASSIS - MTS T3

128222



3.0MM CARBON GRAPHITE SHOCK TOWER (FRONT) - MTS T3

128223



3.0MM CARBON GRAPHITE SHOCK TOWER (REAR) - MTS T3

128224

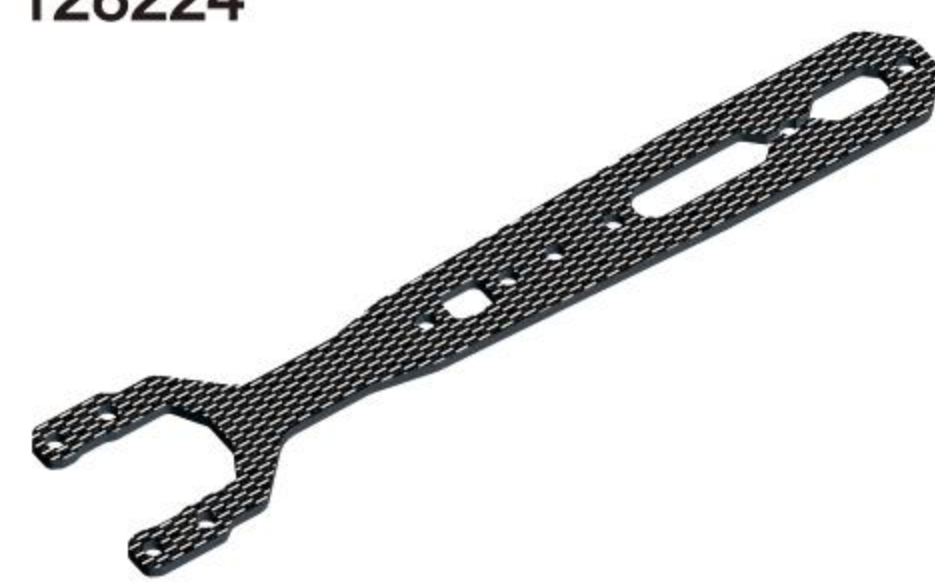

2.2MM CARBON GRAPHITE 2ND DESK (FRONT PART) - MTS T3

128225



2.2MM CARBON GRAPHITE 2ND DESK (REAR PART) - MTS T3

128226



2.2MM CARBON GRAPHITE BATTERY MOUNTED PLATE - MTS T3

916205-GD

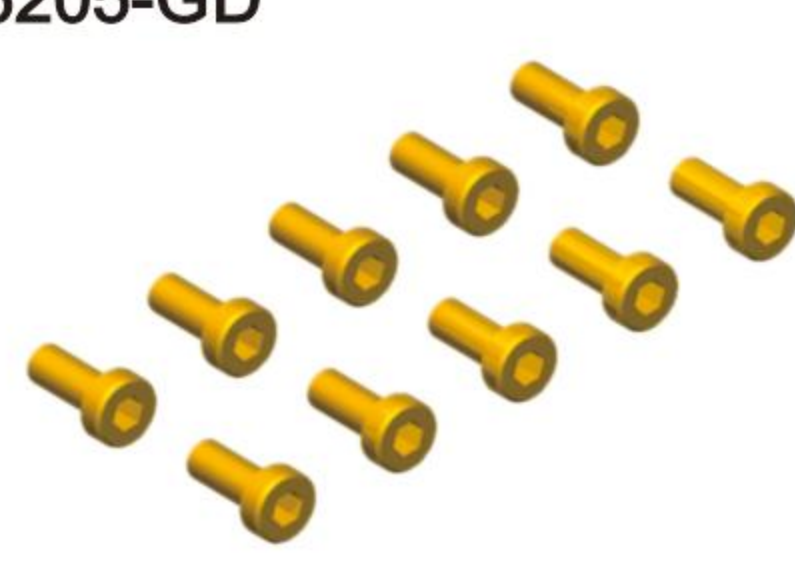

M2X5

HEX SOCKET CAP SCREW

915325-GD M3\*2.5  
915304-GD M3\*4  
915306-GD M3\*6  
915310-GD M3\*10  
915312-GD M3\*12  
915314-GD M3\*14

915404 M4\*4  
915405 M4\*5  
915406 M4\*6  
915408 M4\*8  
915410 M4\*10  
915412 M4\*12

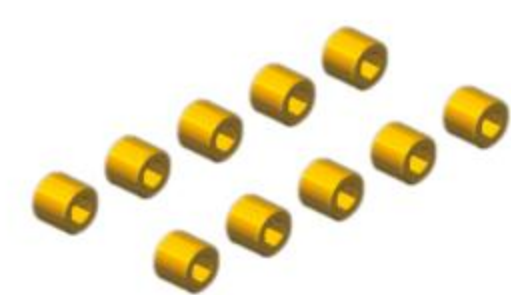

HEX SET SCREW

917256-GD M2.5\*6  
917258-GD M2.5\*8  
917304-GD M3\*4  
917306-GD M3\*6  
917308-GD M3\*8  
917310-GD M3\*10  
917312-GD M3x12  
917314-GD M3x14  
917316-GD M3x16



HEX SCREW FLAT HEAD

918210-GD M2\*10  
918256-GD M2.5\*6  
918112-GD M2.5\*12  
918214-GD M2.5\*14

918304-GD M3\*4  
918305-GD M3\*5  
918306-GD M3\*6  
918308-GD M3\*8  
918310-GD M3\*10  
918312-GD M3\*12  
918314-GD M3\*14  
918316-GD M3\*16



HEX SCREW ROUND HEAD

915325 M3\*2.5  
915304 M3\*4  
915306 M3\*6  
915308 M3\*8  
915310 M3\*10  
915312 M3\*12  
915314 M3\*14

915504 M5\*4  
915505 M5\*5  
915506 M5\*6



HEX SET SCREW

916205

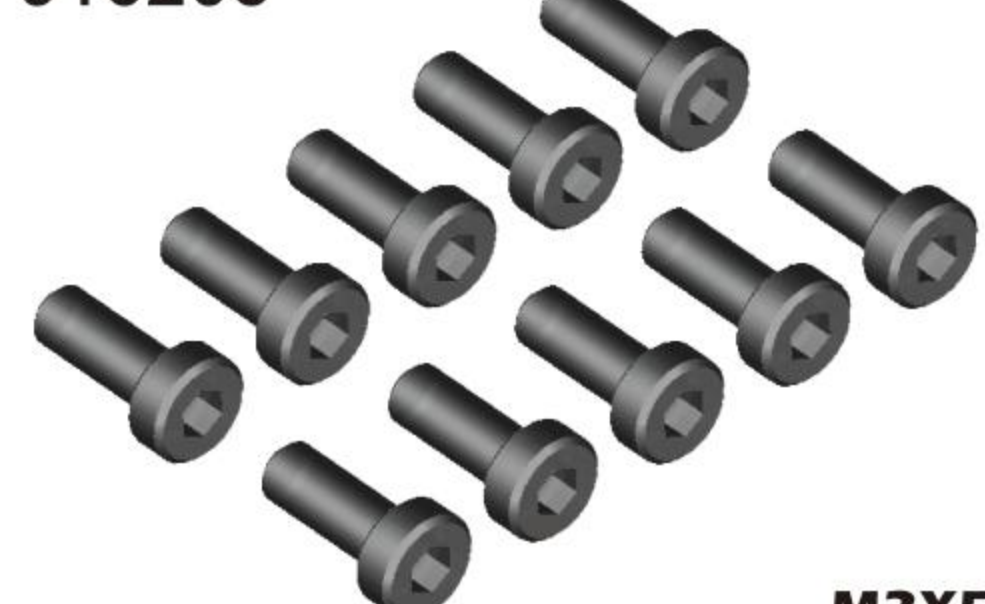

M2X5

HEX SOCKET CAP SCREWS

916310-P  
916312-P  
916315-P

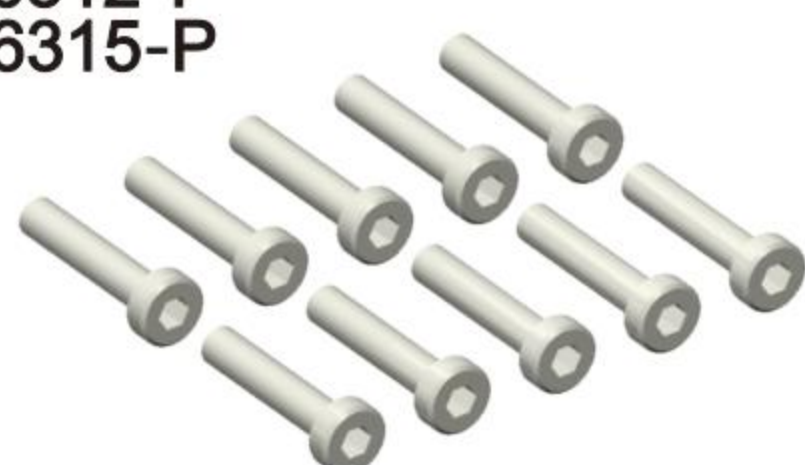

M3X10

HEX SOCKET CAP SCREW PLASTIC

917256 M2.5\*6  
917258 M2.5\*8

917304 M3\*4  
917306 M3\*6  
917308 M3\*8  
917310 M3\*10  
917312 M3\*12  
917314 M3\*14  
917316 M3\*16



HEX SCREW FLAT HEAD

918256 M2.5\*6  
918258 M2.5\*8  
918112 M2.5\*12  
918210 M2\*10  
918110 M2.5\*10

918304 M3\*4  
918305 M3\*5  
918306 M3\*6  
918308 M3\*8  
918310 M3\*10  
918312 M3\*12  
918314 M3\*14  
918316 M3\*16



HEX SCREW ROUND HEAD

919300



NUT M3

919400



NUT M4

919301



NUT M3 WITH SERRATED FLANGE

919401



NUT M4 WITH SERRATED FLANGE

919402

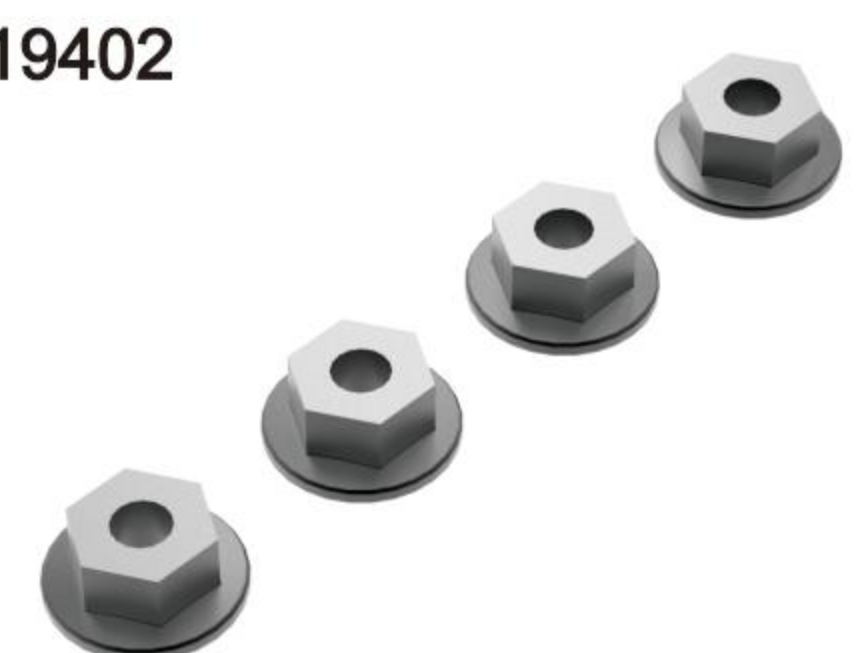

ALU WHEEL LOCK NUT M4

919502

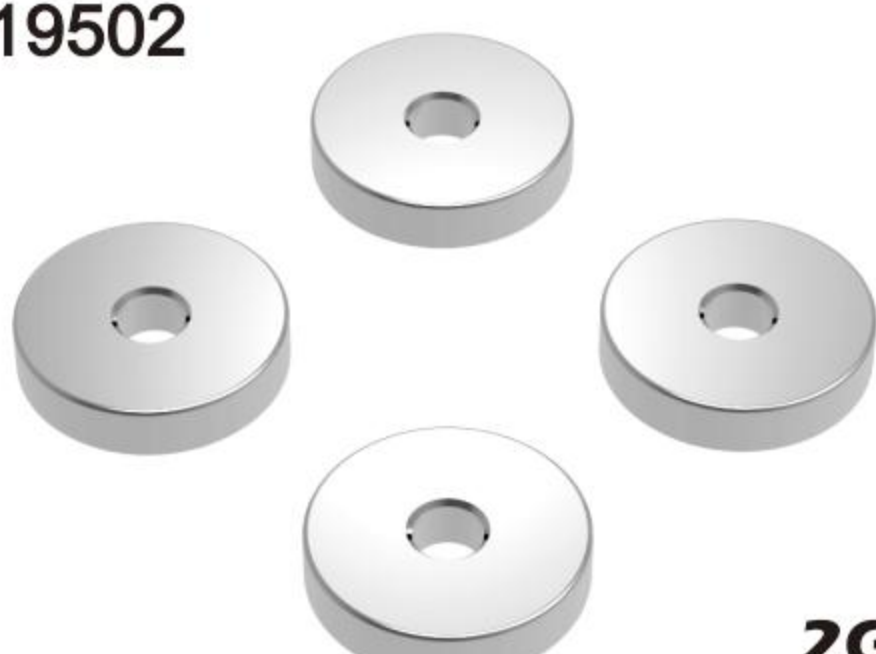

2G

ROUND SHAPE BALANCE WEIGHT

919503 3G  
919505 5G  
919510 10G

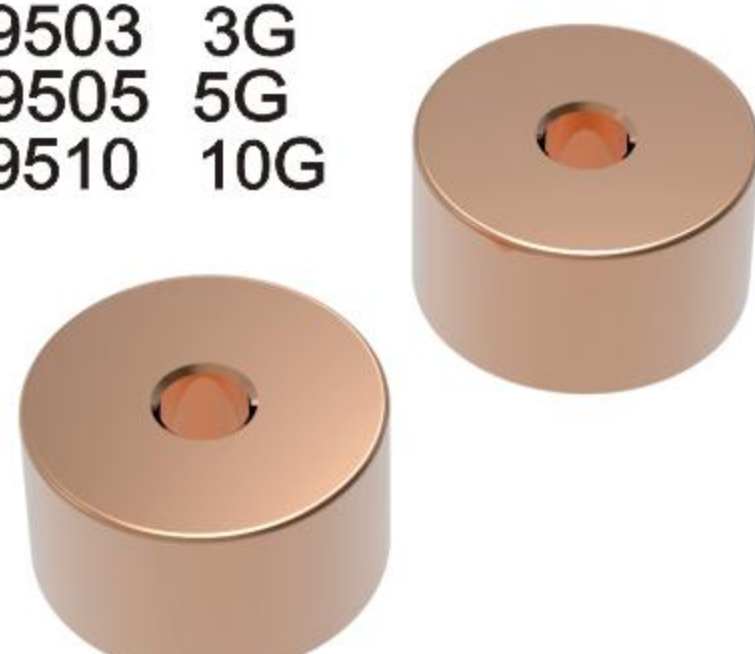

ROUND SHAPE BALANCE WEIGHT

930306

930508  
930510  
930612  
931015

3\*6\*2.5  
5\*8\*2.5  
5\*10\*4  
6\*12\*4  
10\*15\*4



BALL-BEARING

930518

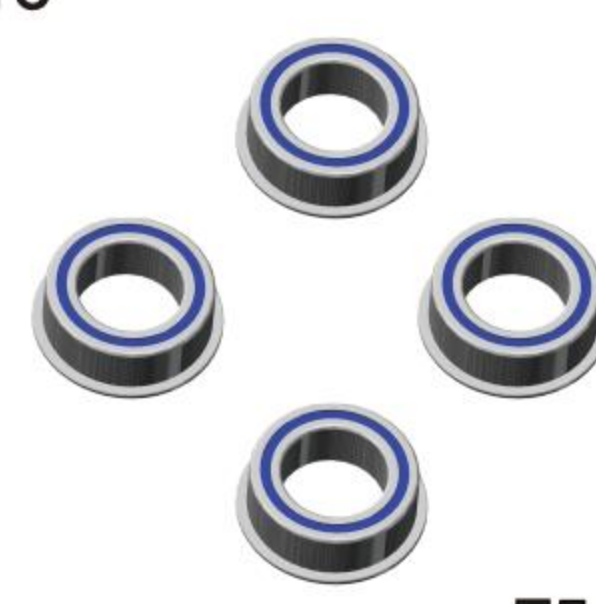

F5x8x2.5

BALL-BEARING FLANGED



# 1/10 ELECTRIC TOURING CAR



930102

**WHOLE VEHICLE BEARING**

940025 2.5  
940030 3.0  
940040 4.0  
940050 5.0

**E-CLIP**

940265 2.6\*6\*0.5  
940272 2.6\*7\*0.2  
940373 3\*7\*0.3  
940375 3\*7\*0.5  
943592 3.5\*9\*0.2  
943593 3.5\*9\*0.3  
943594 3.5\*9\*0.4  
  
945121 5\*12\*0.1  
945122 5\*12\*0.2  
945123 5\*12\*0.3

**WASHERS**

941502 12\*14.8\*0.2  
941503 12\*14.8\*0.3

**WASHERS**

940361 3\*6\*1  
940361-5 3\*6\*1.5  
940362 3\*6\*2  
940362-5 3\*6\*2.5  
940363 3\*6\*3  
940364 3\*6\*4  
940365 3\*6\*5

**ALU WASHER**

940366 3\*6\*6

**ALU WASHER**

947262 2.5\*6\*2  
947362 3\*6\*2

**ALU WASHER SFH SCREW FLAT HEAD**

948362 3\*6\*2

**ALU CONICAL SHIM**

940391 3\*9\*1  
940391-5 3\*9\*1.5  
940392 3\*9\*2

**ALU WASHER**

951509 1.5\*9  
951510 1.5\*9.8  
950209 2\*9  
950210 2\*9.8  
950212 2\*12  
950312 3\*12

**PIN**

950224

**BATTERY MOUNT HOLDER SHAFT 2X24MM**

994018 18T 994031 31T  
994019 19T 994032 32T  
994020 20T 994033 33T  
994021 21T 994034 34T  
994022 22T 994035 35T  
994023 23T 994036 36T  
994024 24T 994037 37T  
994025 25T 994038 38T  
994026 26T 994039 39T  
994027 27T 994040 40T  
994028 28T  
994029 29T  
994030 30T

**48P**  
**PINON GEAR ALU HARD COATED**

996024 24T 996037 37T  
996025 25T 996038 38T  
996026 26T 996039 39T  
996027 27T 996040 40T  
996028 28T 996041 41T  
996029 29T 996042 42T  
996030 30T 996043 43T  
996031 31T 996044 44T  
996032 32T 996045 45T  
996033 33T  
996034 34T  
996035 35T  
996036 36T

**64P**  
**PINON GEAR ALU HARD COATED**

994013

**48P**  
**PINON GEAR ALU HARD COATED 18T-30T**

996010 24-34T  
996011 35-45T

**64P**  
**PINON GEAR ALU HARD COATED**

910102

**WHOLE CAR SCREW**

910103-GD

**ALL METAL SCREW**

960615 6\*1.5MM  
960702 7\*2MM  
960722 7\*2.2MM  
960902 9\*2MM

**SILICONE O-RING**

961301 13\*1MM  
961401 14\*1MM  
961501 15\*1MM

**SILICONE O-RING**

128401

**PULL CAR SHELL PC 195\*260MM**

128402

**GTR DRIFT CAR SHELL PC 195\*260MM**

128403

**FLAT CAR SHELL PC 195\*260MM**

128404

**FLAT CAR SHELL PC 195\*260MM**

900100 THE DIFFERENTIAL OIL  
900050 SHOCK ABSORBER OIL  
909001 GRAPHITE OIL  
909002 ENGINE AFTER RUN OIL  
909003 AIR FILTER OIL  
909004 ONE-WAY LUBE  
909005 CERAMIC BEAD OIL  
909006 SINGLE BEARING OIL  
909007 HIGH SPEED BEARING OIL  
909008 SEAL OIL  
909009 HIGH STRENGTH SCREW GLUE  
909010 MEDIUM STRENGTH SCREW GLUE  
909011 STICKY RUBBER  
909012 FUEL LUBRICATION ADDITIVE

**THE DIFFERENTIAL OIL**